

S Mo-53, Poplar Bluff, MO 63901, Butler County

APN: 109-13-02-10-0-003-010-001-030 CLIP: 9413666560

	Beds	Full Baths	Half Baths	Sale Price	Sale Date
	N/A	N/A	N/A	N/A	09/05/2014
	Bldg Sq Ft	Lot Sq Ft	Yr Built	Type	
	N/A	29,185	N/A	COM-NEC	

OWNER INFORMATION			
Owner Name	Rathe Charles	Tax Billing City & State	Poplar Bluff, MO
Owner Name 2	Rathe Mary Ann	Tax Billing Zip	63901
Tax Billing Address	1444 County Road 461	Tax Billing Zip+4	7600
Tax Billing Address	1444 County Road 461		

COMMUNITY INSIGHTS			
Median Home Value	\$80,813	School District	POPLAR BLUFF R-I
Median Home Value Rating	1 / 10	Family Friendly Score	36 / 100
Total Crime Risk Score (for the neighborhood, relative to the nation)	36 / 100	Walkable Score	40 / 100
Total Incidents (1 yr)	51	Q1 Home Price Forecast	\$83,140
Standardized Test Rank	59 / 100	Last 2 Yr Home Appreciation	18%

LOCATION INFORMATION			
School District	Poplar Bluff	Census Tract	9507.00
Municipality	Poplar Bluff	Within 250 Feet of Multiple Flood Zone	No
Subdivision	Value Add	Flood Zone Code	AE
Zip Code	63901		

TAX INFORMATION			
Tax ID	109-13-02-10-0-003-010-001-030	Tax Area	R-1
Alternate Tax ID	29767	Block #	10
Parcel ID	1091302100003010001030	Lot #	4
Legal Description	PT SE1/4 SW1/4: FROM NW COR L OT 4 BLK10, VALUE ADD: NE 75.4' TO S R/W HY 53: SE ALO NG HY 3 77' TO NWCOR 888-446: SW 405 T O S LINE: SW 221.9' TO POB:SW 1 67.9: N 171.4' NE 170.4': SW 171.5' TO POB:		

ASSESSMENT & TAX			
Assessment Year	2023	2022	2021
Assessed Value - Total	\$9,340	\$18,680	\$18,680
Market Value - Total	\$29,190	\$58,370	\$58,370
Market Value - Land	\$29,190	\$58,370	\$58,370
Total Tax	Tax Year	Change (\$)	Change (%)
\$942	2021		
\$942	2022	-\$0	-0.04%
\$472	2023	-\$470	-49.91%

CHARACTERISTICS			
Lot Acres	0.67	Land Use - Universal	Commercial (NEC)
Lot Sq Ft	29,185	Land Use - County	Commercial

SELL SCORE			
Value As Of	2024-07-07 04:37:56		

LAST MARKET SALE & SALES HISTORY			
Recording Date	09/18/2014	Deed Type	Warranty Deed
Settle Date	09/05/2014	Owner Name	Rathe Charles
Document Number	1035-4506	Owner Name 2	Rathe Mary Ann
Sale Type	Estimated	Seller	Tyler Darrell J & Jeneva J

Recording Date	09/18/2014	12/2002
Buyer Name	Rathe Charles & Mary A	Tyler Darrell J & Jeneva J

Seller Name	Tyler Darrel J & Jeneva J	Owner Record
Document Number	1035-4506	968-417
Document Type	Warranty Deed	Deed (Reg)

MORTGAGE HISTORY		
Mortgage Date	12/01/2020	09/18/2014
Mortgage Amount	\$228,734	\$200,000
Mortgage Lender	First Midwest Bk/Poplar Bluff	Peoples Cmnty Bk
Mortgage Type	Refi	Resale

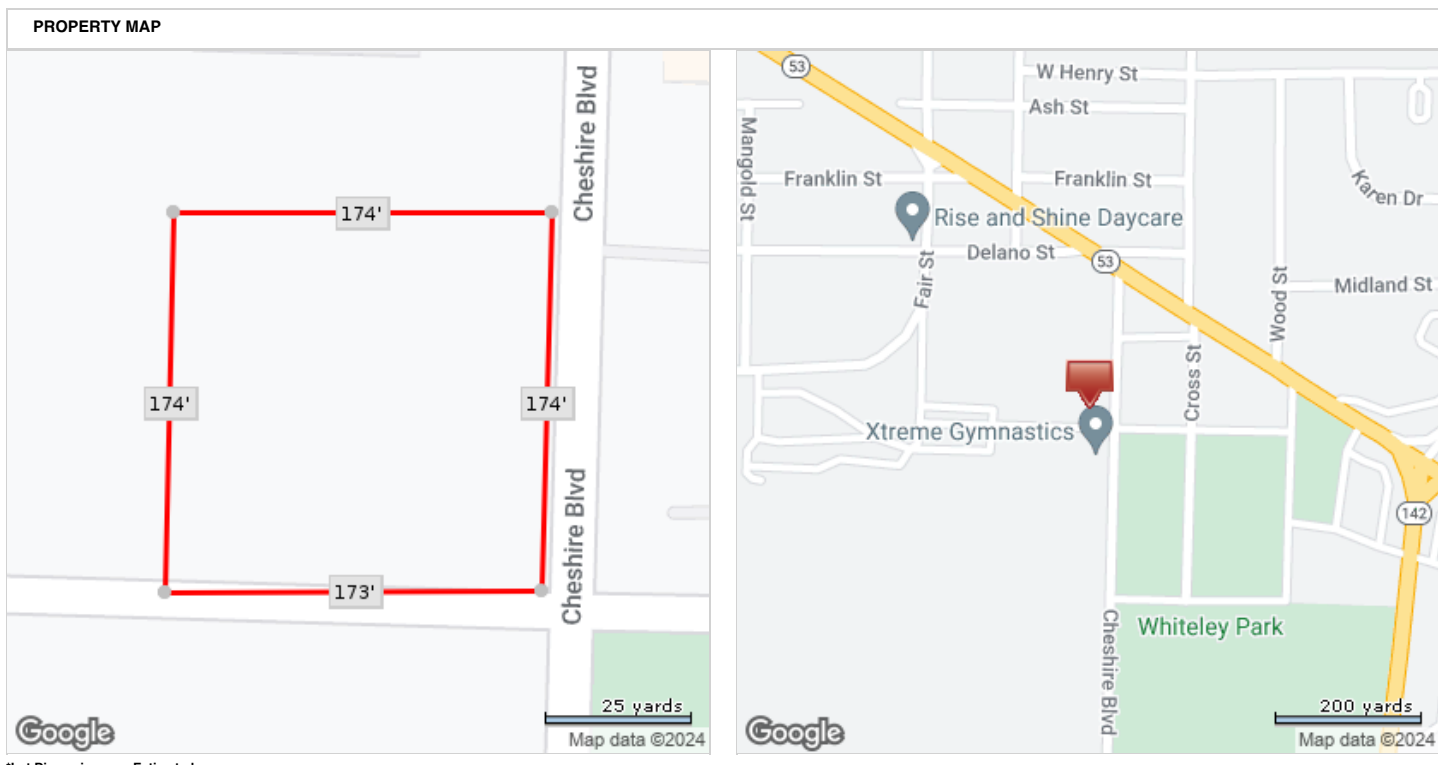

*Lot Dimensions are Estimated