

**SHORT
TERM
SUBLEASE**

48,985 SF
AVAILABLE

EASTERN
TURNPIKE
SUBMARKET

Term
Thru
12/31/2028



TRANSWESTERN

REAL ESTATE
SERVICES

3951 LA REUNION PKY

DALLAS, TEXAS 75212



Building Features

- 48,985SF Available
- 6,000 SF Office (Approximately)
- 24' Clear Height
- 5 Dock High Doors; Levelers
- 1 Ramp
- 100% HVAC (75 Tons Installed in Q4 2020)
- Class IV Fire Suppression System
- Fenced & Secured Parking

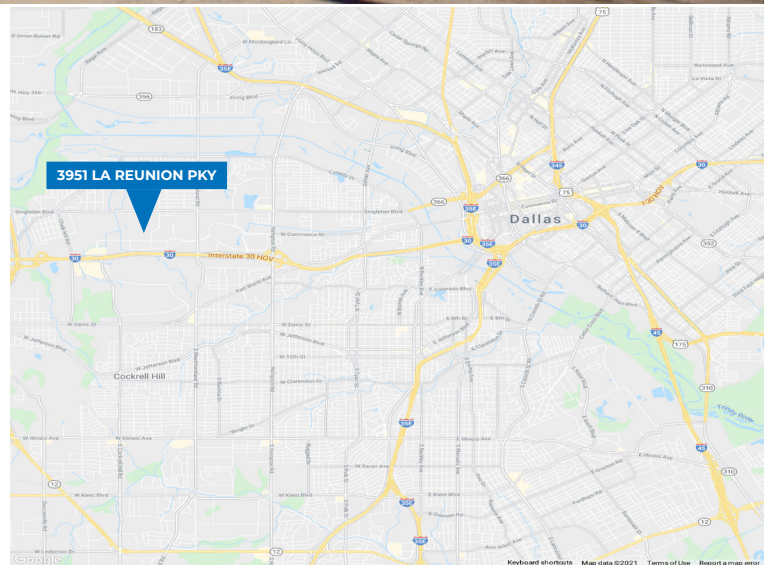

Leasing Information:

**Robert
Deptula**

214.207.3260

robert.deptula@transwestern.com

Jack

Brewer

214.292.6441

jack.brewer@transwestern.com

The information provided herein was obtained from sources believed reliable; however, Transwestern makes no guarantees, warranties or representations as to the completeness or accuracy thereof. The presentation of this property is submitted subject to errors, omissions, change of price or conditions, prior sale or lease, or withdrawal without notice. Copyright © 2024 Transwestern.

3951 LA REUNION PKY

SITE PLAN



TRANSWESTERN

REAL ESTATE
SERVICES

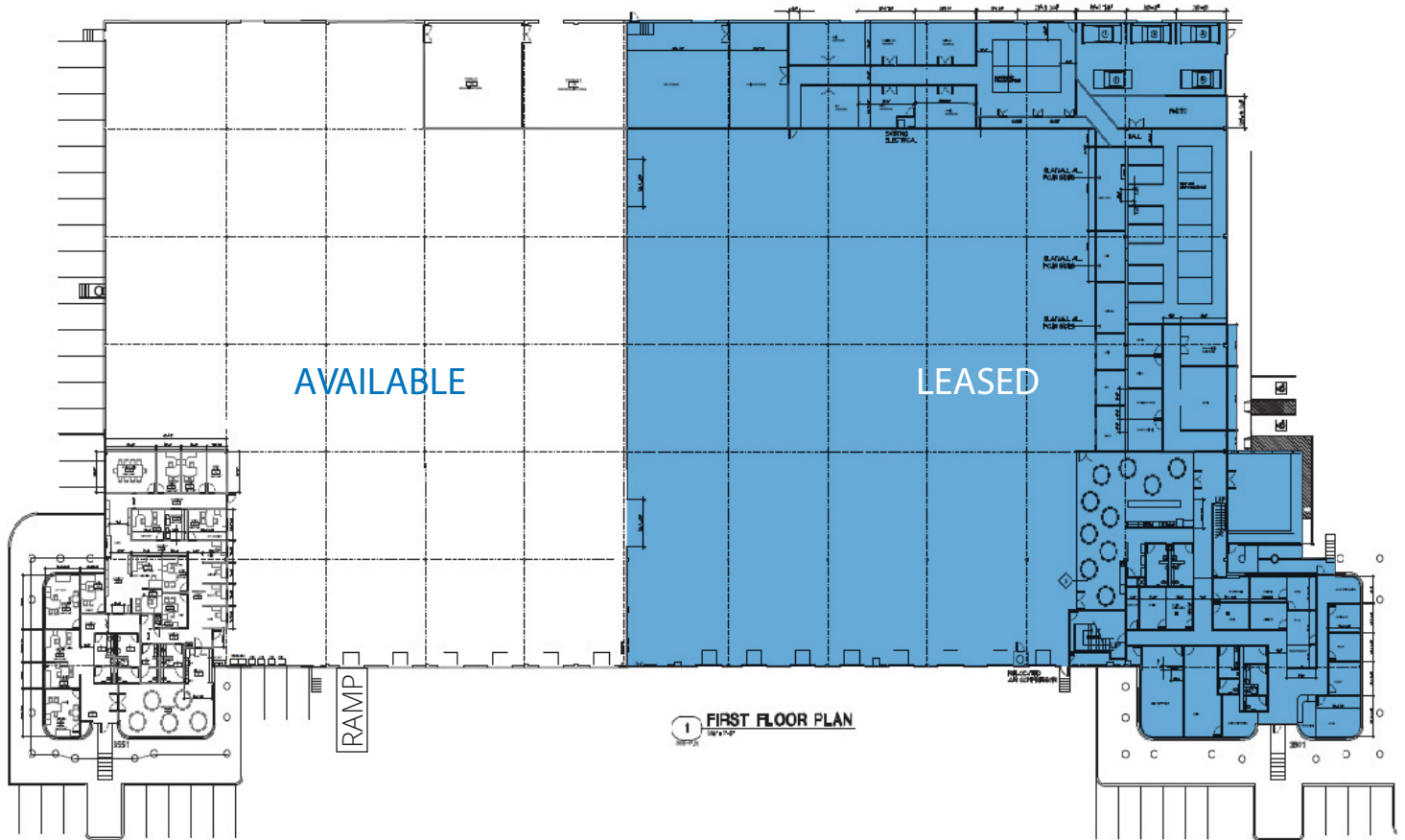

Leasing Information:

**Robert
Deptula**

214.207.3260

robert.deptula@transwestern.com

**Jack
Brewer**

214.292.6441

jack.brewer@transwestern.com

The information provided herein was obtained from sources believed reliable; however, Transwestern makes no guarantees, warranties or representations as to the completeness or accuracy thereof. The presentation of this property is submitted subject to errors, omissions, change of price or conditions, prior sale or lease, or withdrawal without notice. Copyright © 2024 Transwestern.