

3,285 SF

Flex Space For Lease



Prologis NW Corporate Park 9

3247 NW 29th Avenue
Portland, OR 97210 USA

LOCATION

- Guilds Lake / NW Industrial Area
- Eleven (11) Buildings; 887,935 SF Park

FACILITY

- Approximately 3,285 SF
- Can be combined with adjacent suites for 5,445 SF total
- Excellent visibility on NW 29th Avenue
- Ideal for distribution, sales, and service
- Ample parking

ADVANTAGES AND AMENITIES

- Close-In NW Location
- Minutes to Downtown Portland
- Immediate Access to I-405 and I-5
- Park Amenities Include Food Services

LEASE RATE

- \$1.75/SF + NNNs



3,285 SF

Flex Space For Lease

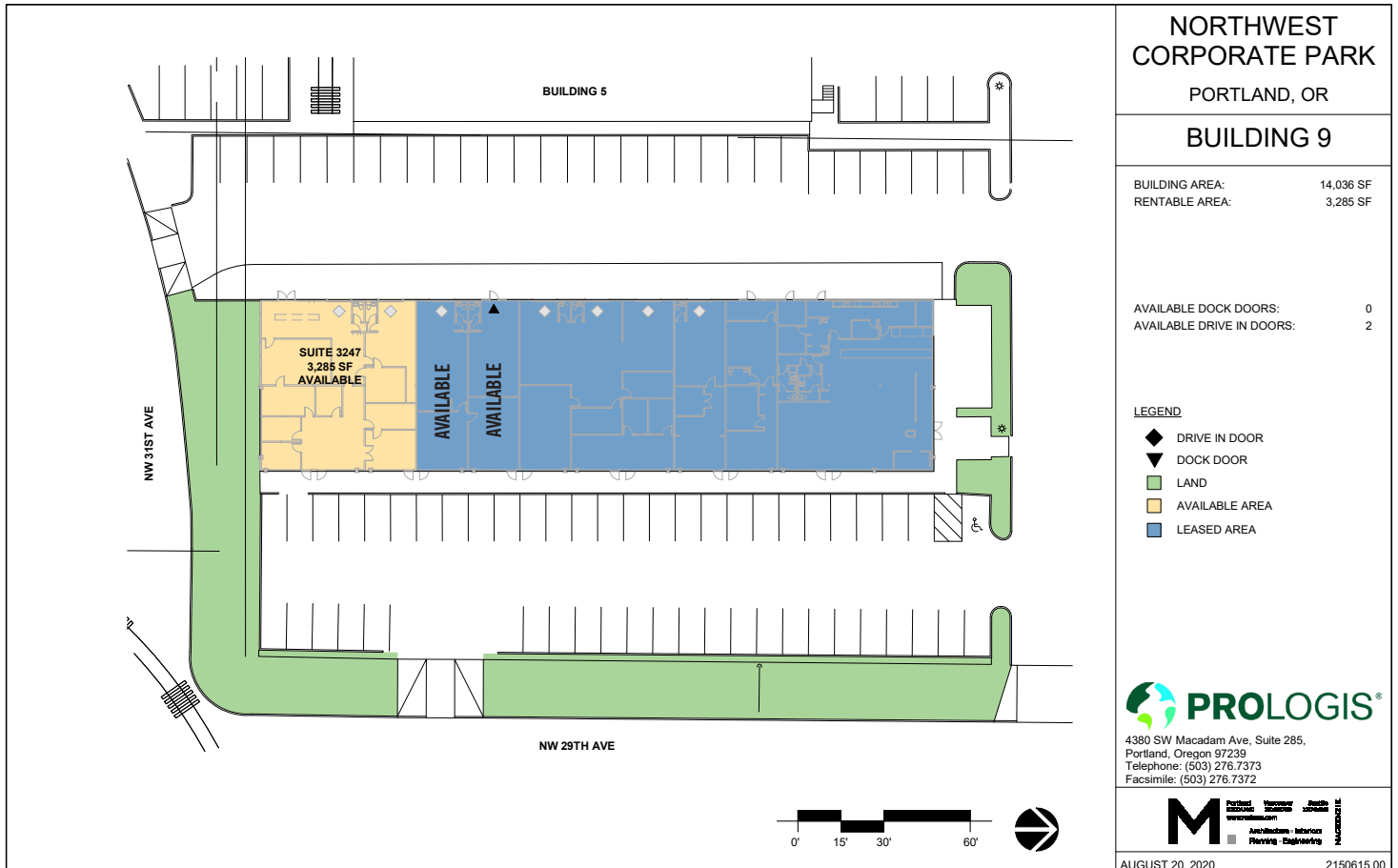

Capacity Commercial Group

Scott Kappes, SIOR

scottk@capacitycommercial.com

ph +1 503.517.9877

cell +1 503.816.4201

805 SW Broadway Street, Suite 700

Portland, OR 97205

Capacity Commercial Group

Kenny Houser

kenny@capacitycommercial.com

ph +1 503.517.9875

cell +1 503.385.6080

805 SW Broadway Street, Suite 700

Portland, OR 97205

Prologis

Sean Colletta

scolletta@prologis.com

ph +1 503.276.7375

4380 SW Macadam Avenue, Suite 285

Portland, OR 97239