



For Lease



District Heights

11240 South River Heights Drive
South Jordan, Utah

CLASS A OFFICE SPACE

**UP TO 13,168 RSF
AVAILABLE**

Jones Lang LaSalle Brokerage, Inc.

District Heights



Asking Rate
\$27.50 Full-Service Gross



Building Signage along
Bangerter Highway



10' Ceiling Heights and
Floor to Ceiling Glass



Suites Divisible
Down to 2,500 SF



Suites in Shell Condition
Ready for Tenant Improvements



Expansion Capabilities
Built to Suit Suite



5 / 1,000
Parking Ratio



East Facing
Mountain Views



SECOND FLOOR 13,168 RSF

Suites shown below are conceptual. Space is currently in shell condition and not demised, ready for Tenant Improvements.

2,000 - 13,168 RSF Available

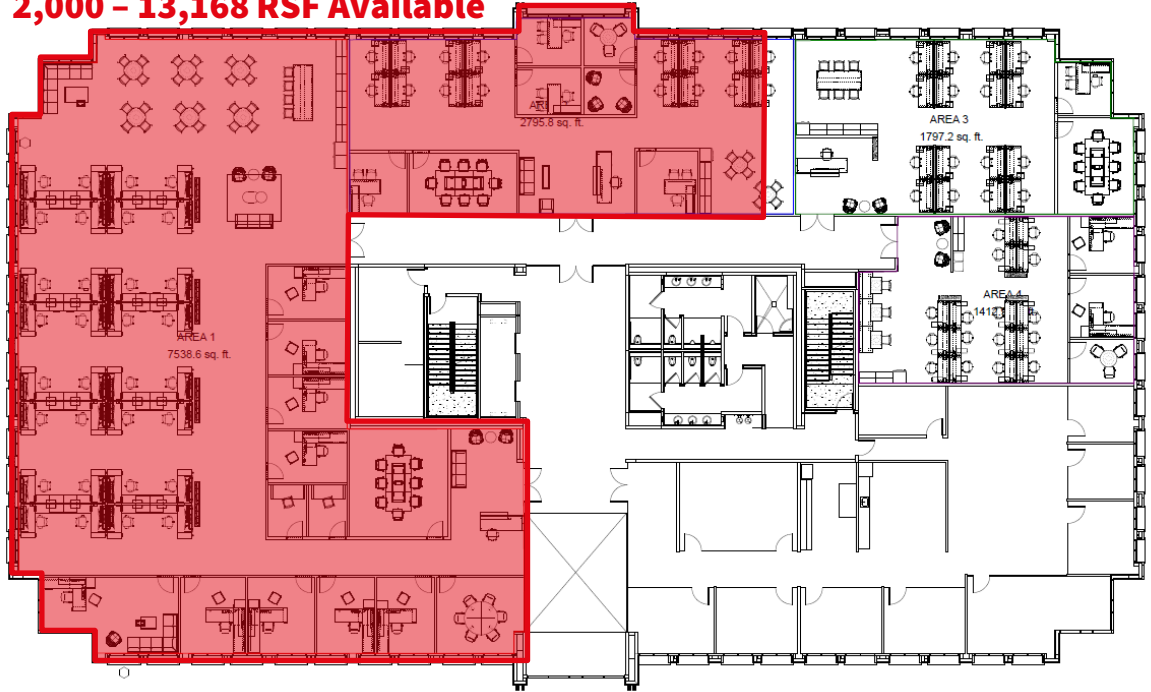

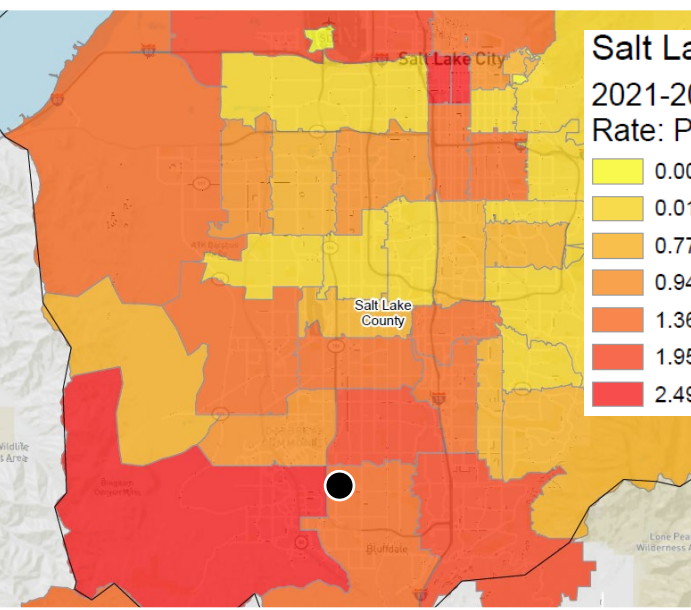
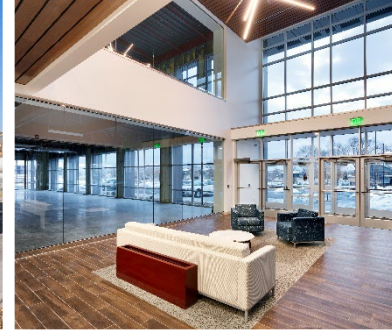

**Salt Lake County
2021-2026 Growth
Rate: Population**

0.00 %
0.01 % - 0.76 %
0.77 % - 0.93 %
0.94 % - 1.35 %
1.36 % - 1.94 %
1.95 % - 2.48 %
2.49 % - 5.12 %

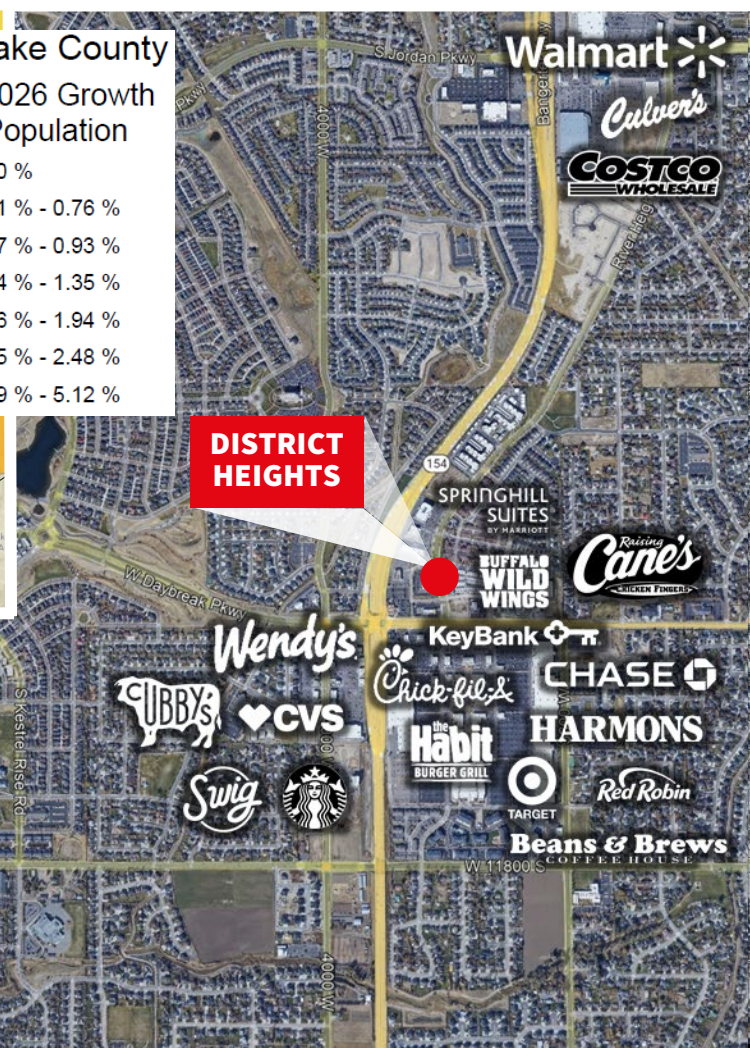

For more information, contact:

Jillian Johnson Hanks
+1 801 456 9517
Jillian.johnson@jll.com

David Nixon
+1 801 456 9518
David.nixon@jll.com

