



Office Flex | Miami Lakes, Florida
2320 SF Flex Office Space – Functional & Versatile Layout
US \$1,114,000



This **2,320 square foot flex office suite** offers an efficient, professional layout ideal for a variety of business uses, including administrative operations, professional services, or light processing. The space combines **private offices, collaborative open areas, and conference facilities**, making it a highly adaptable work environment.

Floor Plan Features

- **Reception Areas (2)** – Convenient dual entrances with dedicated reception/waiting areas for guests.
- **Conference Room** – Spacious meeting room (approx. 16' x 12') designed for client presentations and team collaboration.
- **Private Offices (6)** – Multiple offices of varying sizes (approx. 9' x 8' to 11' x 9'), ideal for executives, managers, or private consultations.
- **Processing Room (19'6" x 11'6")** – Centralized work area suitable for light assembly, administrative functions, or team operations.
- **Open Work Areas (2)** – Flexible layouts (approx. 20' x 16' and 18'3" x 16') that can accommodate cubicles, shared desks, or creative workstations.
- **Lounge/Breakroom (14'6" x 9'3")** – Comfortable employee lounge with nearby **men's and women's restrooms**.
- **Storage/Closet (8' x 6')** – Dedicated storage room for supplies, files, or equipment.

Highlights

- Efficient mix of **private and open-plan workspace**.
- **Dual reception areas** allow for multiple tenant configurations or departmental separation.
- Onsite **restrooms** and a dedicated **lounge/breakroom**.
- Professional layout designed to support both **client-facing functions and back-office operations**.
- Approx. **2,320 rentable square feet**.

This space is well-suited for **professional offices, medical/therapy practices, technology firms, or administrative headquarters** seeking a functional footprint with built-in flexibility.

ELITE

COMMERCIAL DIVISION

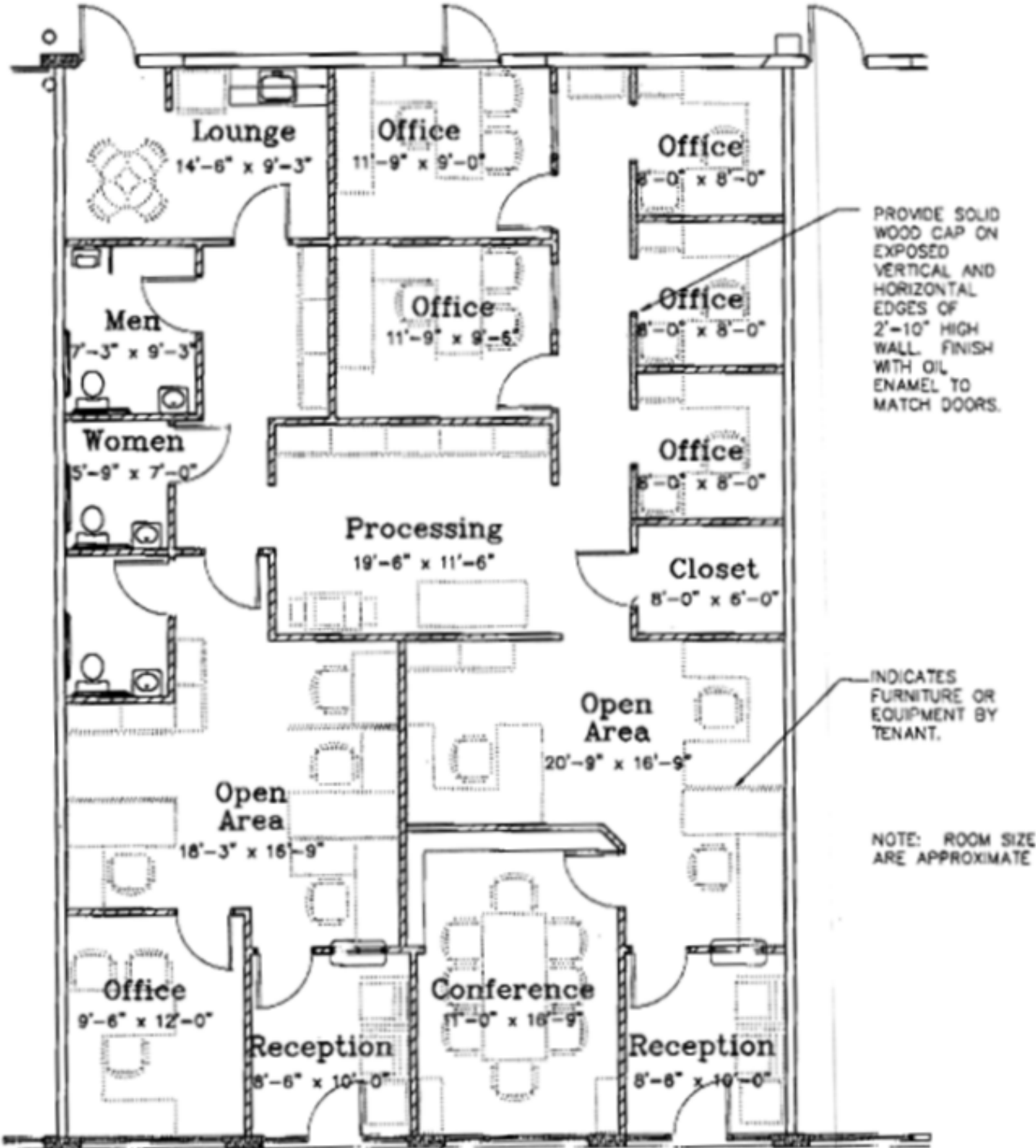

Although all information furnished regarding property for sale, rental or financing is from sources deemed reliable such information has not been verified and no express representation is made nor is any to be implied as to the accuracy thereof, and it is submitted subject to errors, change of price, rental, or other conditions, prior to sale, lease or financing, or withdrawal without notice.

ELITE

COMMERCIAL DIVISION

