

CANVAS

NEW RETAIL/ RESTAURANT FLAGSHIP OPPORTUNITY IN THE HEART OF LINCOLN PARK

1928 N. Clybourn Ave.

LINCOLN PARK
Chicago, IL

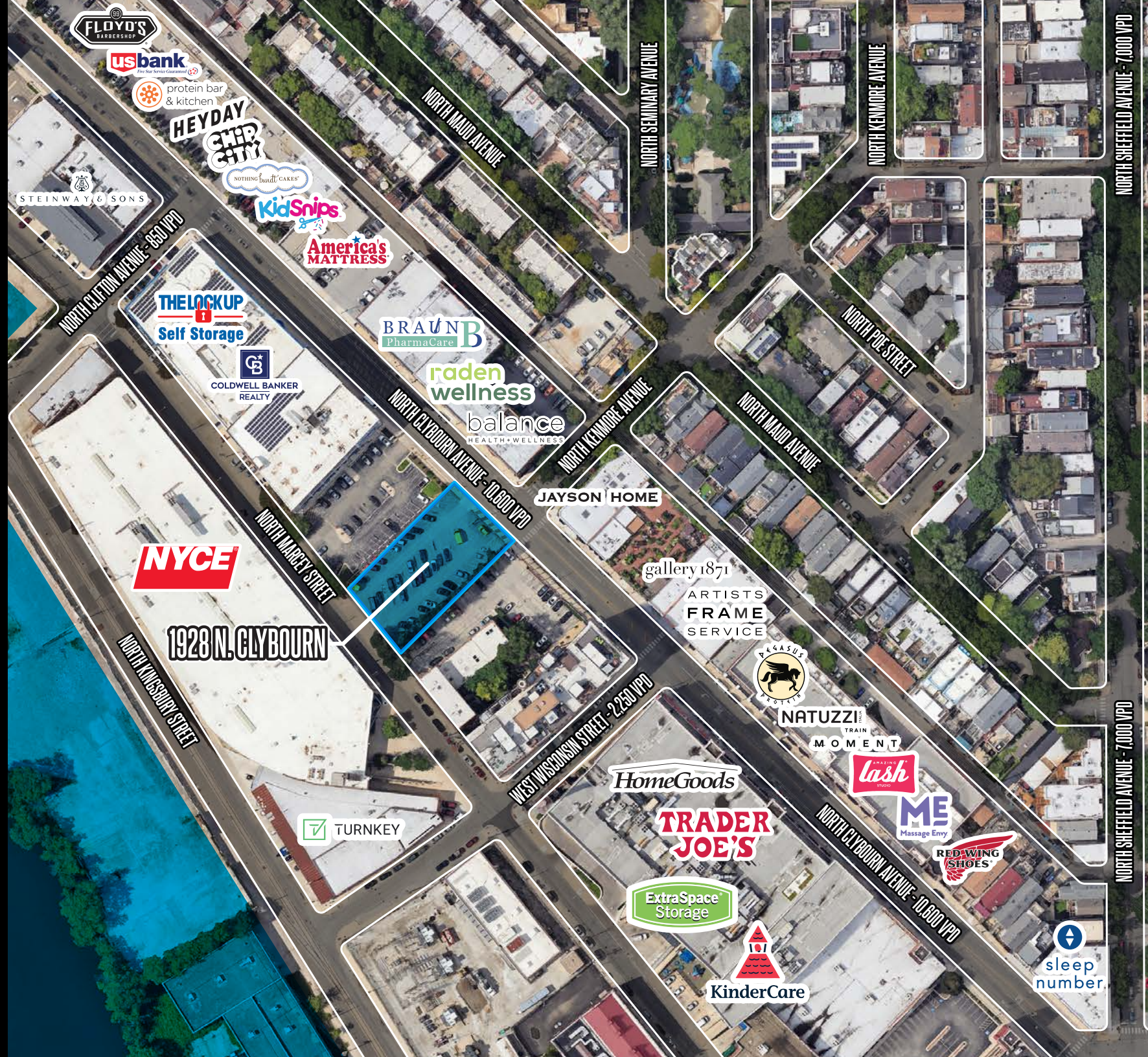

PROPERTY HIGHLIGHTS

1928 N. Clybourn

- 2,500 to 10,500 sf available for lease on approx. 18,000 SF of land
- 26 parking spaces
- Ability for a drive-thru
- Ground Leases will be considered

NEIGHBORHOOD RETAILERS

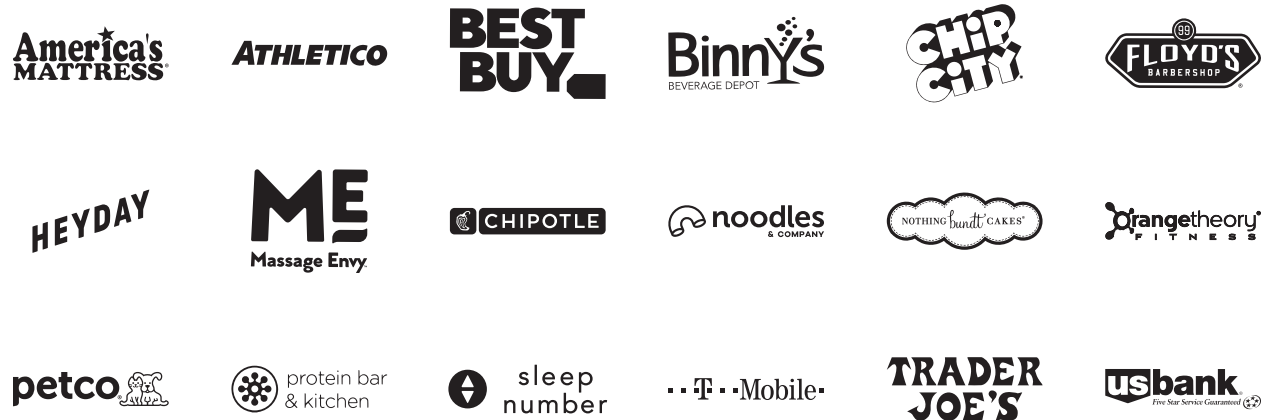

DEMOGRAPHICS

1-Mile

53.0K+

Total Population



\$227K+

Average HH Income



56.3K+

Daytime Population



PROPOSED SITE PLAN

Opportunities from 2,500 to 10,500 sf Available

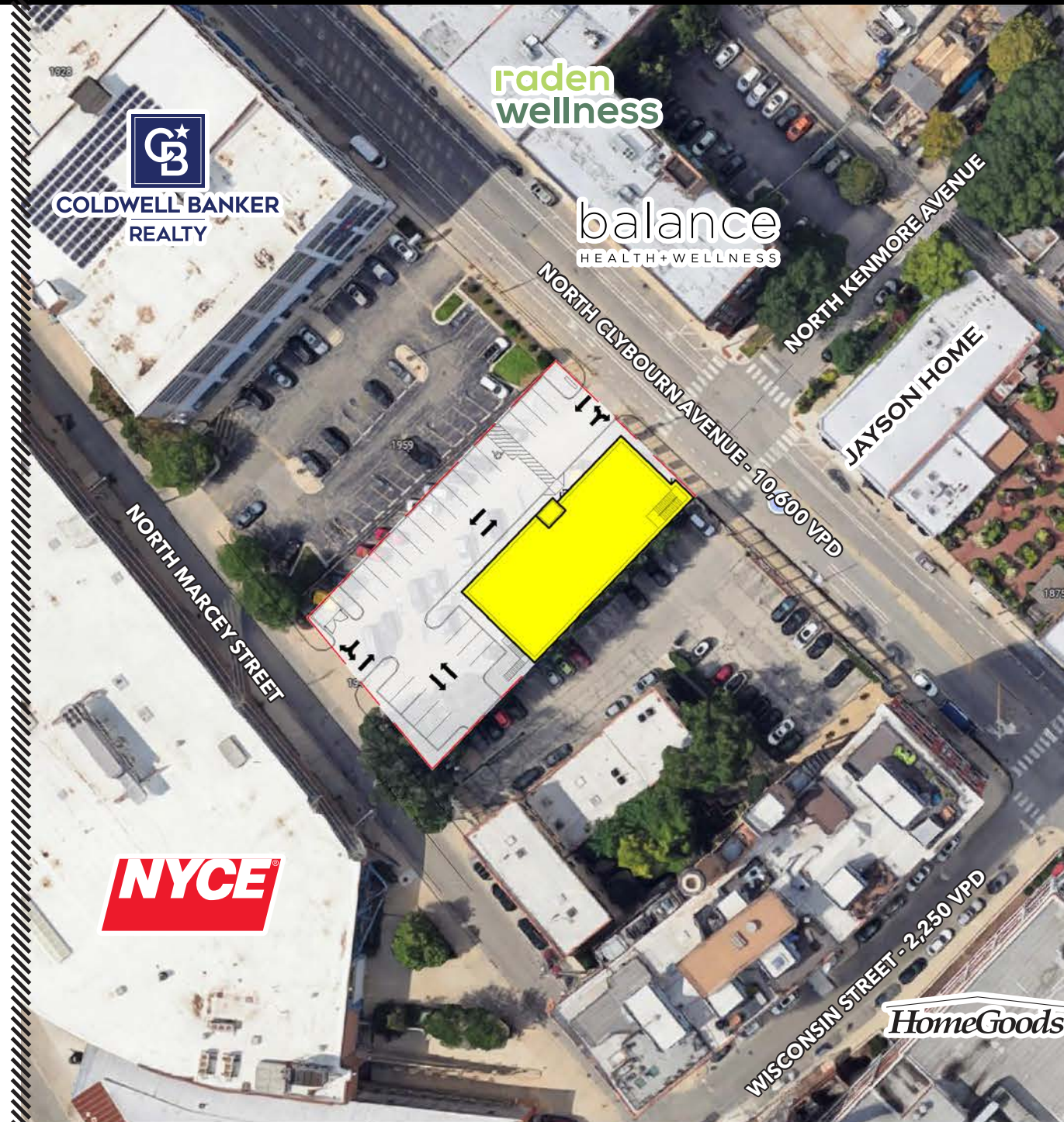
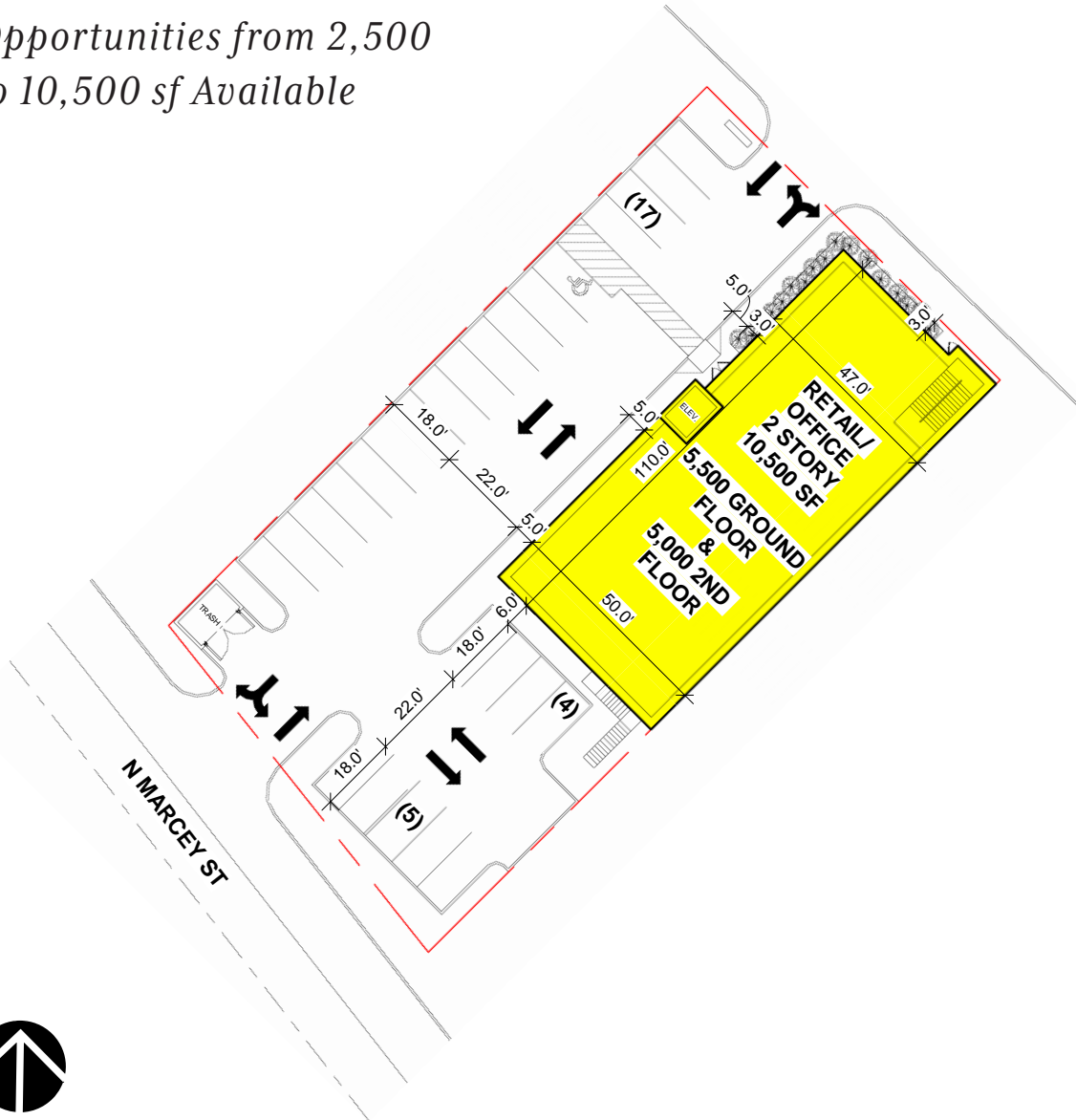

COLDWELL BANKER
 REALTY

NYCE

raden
 wellness

balance
 HEALTH+WELLNESS

HomeGoods

NORTH MARCEY STREET

NORTH CLYBOURN AVENUE - 10,600 VPD

WISCONSIN STREET - 2,250 VPD

NORTH KENMORE AVENUE

JAYSON HOME

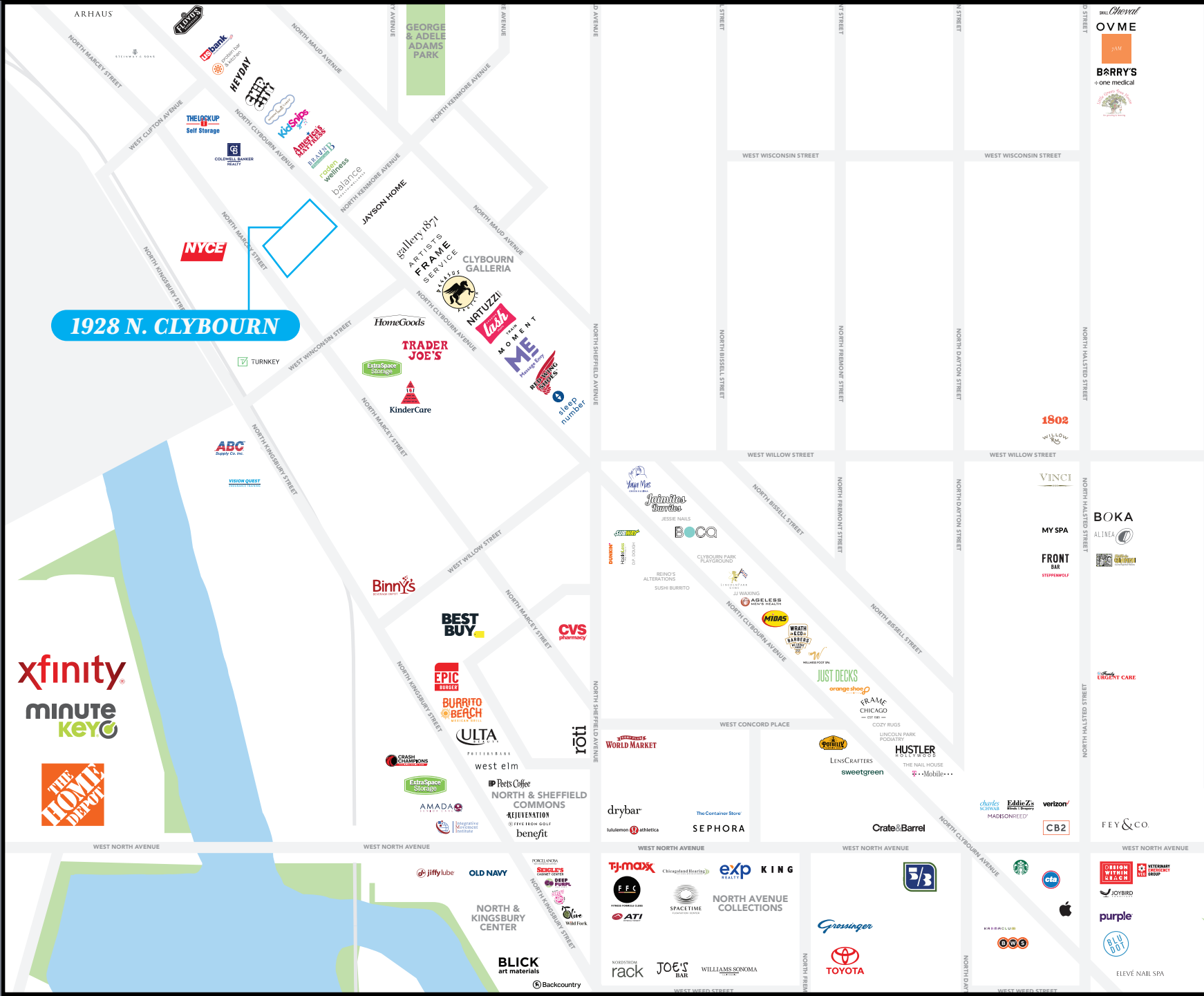

**NEW RETAIL/RESTAURANT
FLAGSHIP OPPORTUNITY
IN THE HEART OF LINCOLN PARK**

1928 N. CLYBOURN AVE.

FOR MORE INFORMATION, PLEASE CONTACT

ANTHONY CAMPAGNI

ac@canvasrealestate.com

847.651.8669

MICHAEL WALLACE

mwallace@canvasrealestate.com

614.537.2403

CANVAS

2211 North Elston Avenue,
Suite 307, Chicago
www.canvasrealestate.com