

CENTRAL CAROLINA INDUSTRIAL PARK

200 N13 Street | Erwin, NC28339

CCIP Area Four - Building #4,#7, #8,#9,#10,#11

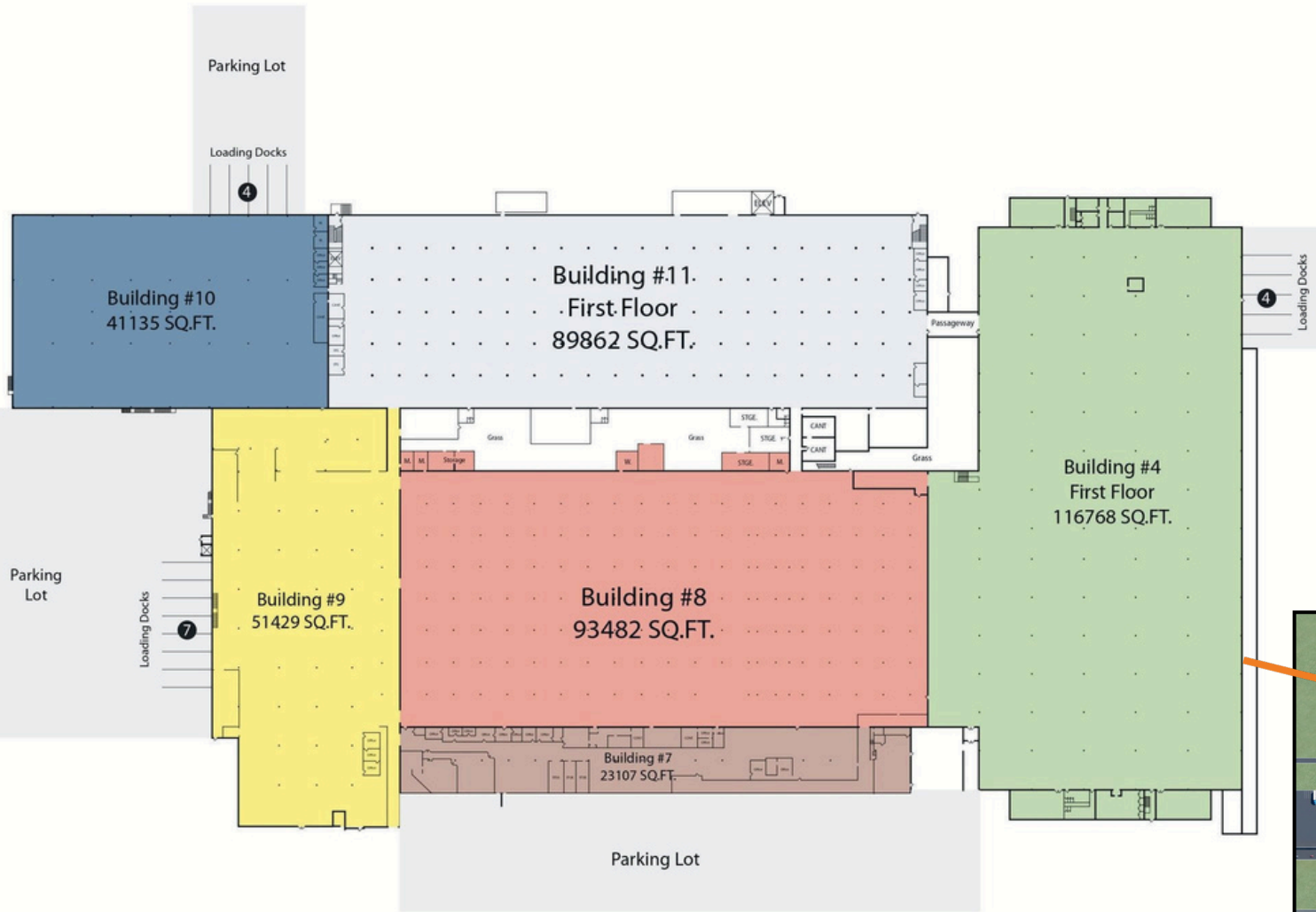

Clear Ceiling Heights

- Building #4: 20'
- Building #7: 14'
- Building #8: 16' to 20'
- Building #9: 33'
- Building #10: 20'
- Building #11: 15'-8"

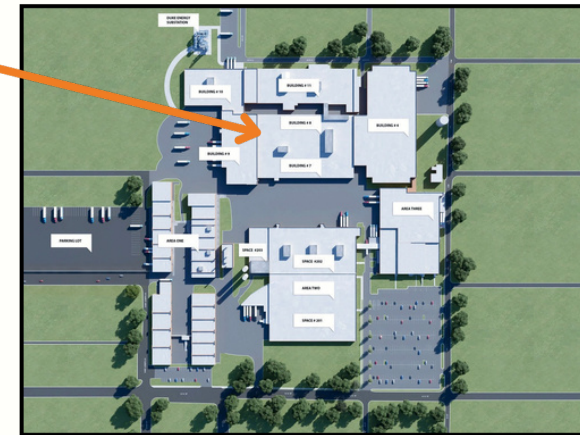

CENTRAL CAROLINA INDUSTRIAL PARK

200 N 13th Street | Erwin, NC 28339
CCIP Space Details

Space Name	Warehouse SF/SM	Office +/- SF/SM	Dock High Doors	Drive-In Doors	Ceiling Height
Building #4	116,768 SF 10,848.1 SM	Build to Suit	4 +	TBD	20 Feet 6.1 Meters
Building #7	Office Only	23,107 SF 2,146.71 SM	Build to Suit	TBD	14 Feet 2.68 Meters
Building #8	93,482 SF 8,684.76 SM	Build to Suit	Build to Suit	TBD	16 Feet - 20 Feet 4.88 Meters - 6.1 Meters
Building #9	51,429 SF 4,777.91 SM	1,000 SF +/- 92.9 SM +/-	7	1	33 Feet 10.06 Meters
Building #10	41,135 SF 3,821.57 SM	1,000 SF +/- 92.9 SM +/-	4 +	TBD	20 Feet 6.1 Meters
Building #11	89,862 SF 8,348.45 SM	2,000 SF +/- 185.81 SM +/-	Build to Suit	TBD	15 Feet - 8 Feet 4.57 Meters - 2.44 Meters



www.SVNEfird.com
910.769.1915

