



# OFFICE | RETAIL FOR LEASE 2,450 SF

## Candle Factory Building

7521 Richmond Road, Suite E  
Williamsburg, Virginia 23188

### ELLIS COLTHORPE

Senior Associate

757 818 4307

[ellis.colthorpe@thalhimer.com](mailto:ellis.colthorpe@thalhimer.com)

### Newport News Office

One BayPort Way, Suite 100

Newport News, Virginia 23606

757 873 2900 | [Thalhimer.com](http://Thalhimer.com)



# CANDLE FACTORY BUILDING

## 7521 RICHMOND RD. SUITE E

**Suite Size:** ± 2,450 SF

**Suite Features:**

Two (2) offices, two (2) open spaces - previously used as a dance studio, storage space, bathrooms located in shared common area

Signage with visibility from Richmond Rd

**Location:**

- 1.5 miles from I-64 at the corner of Richmond and Croaker Rd
- 3.0 miles from Lightfoot Marketplace and Route 199

**Parking:**

Ample

**Nearby Users:**

Food Lion, Pizza Hut, CVS, Tractor Supply and Starbucks

**Lease Rate:**

**\$3,200 / month, Net Electric & CAM**

**Available Immediately**

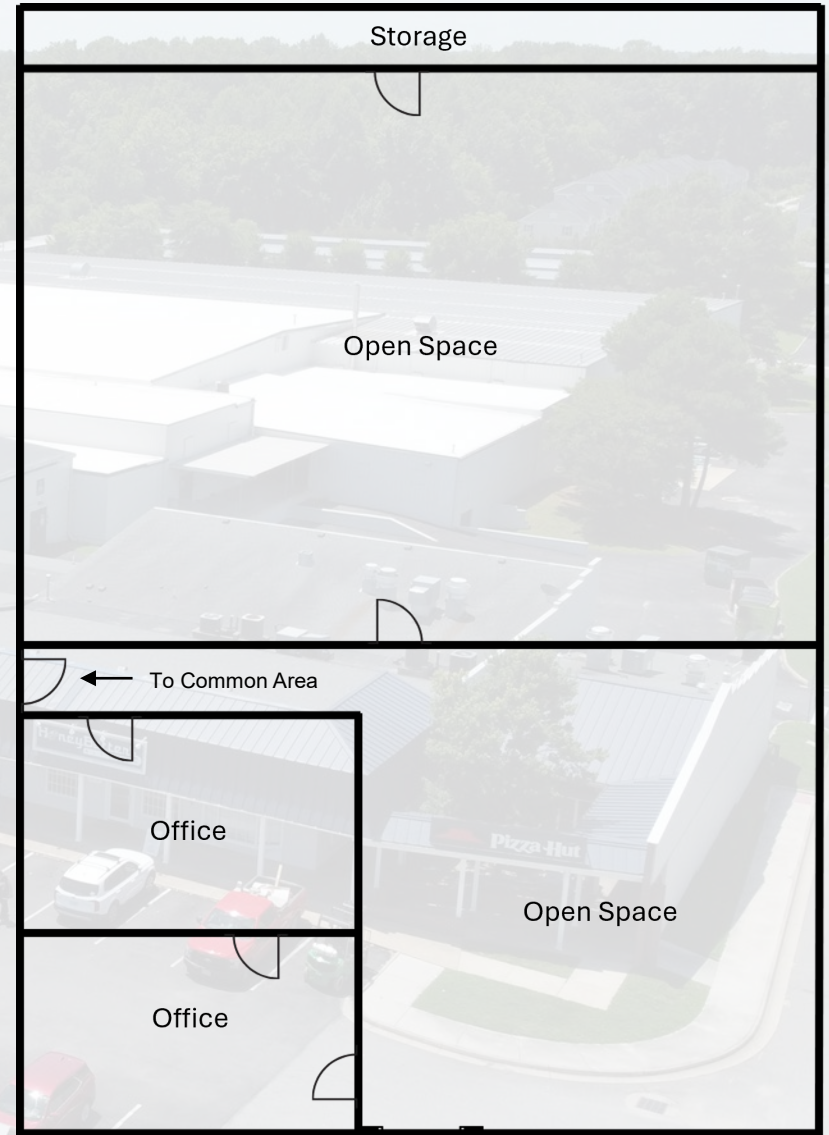

INTERIOR PHOTOS



SURROUNDING AREA





**OFFICE | RETAIL  
FOR LEASE  
2,450 SF**

**Candle Factory Building**

7521 Richmond Road, Suite E  
Williamsburg, Virginia 23188

**ELLIS COLTHORPE**

Senior Associate

757 818 4307

ellis.colthorpe@thalhimer.com

**Newport News Office**

One BayPort Way, Suite 100

Newport News, Virginia 23606

757 873 2900 | Thalhimer.com



*Independently Owned and Operated / A Member of the Cushman & Wakefield Alliance*

*Cushman Wakefield | Thalhimer ©2024. No warranty or representation, express or implied, is made to the accuracy or completeness of the information contained herein, and same is submitted subject to errors, omissions, change of price, rental or other conditions, withdrawal without notice, and to any special listing conditions, imposed by the property owner(s). As applicable, we make no representation as to the condition of the property (or properties) in question.*