



STREETERVILLE

# 680 N. LAKE SHORE DRIVE

CHICAGO, IL



## AN IDEAL LOCATION

Welcome to 680 N Lake Shore Drive, the best city block for all your medical and retail space needs! Already home to Lurie's Children's Hospital, Northwestern Memorial Hospital, and Northwestern University, the building is offering a unique chance for medical offices to thrive. The 29-floor building has nine floors of clinical, research, and medical-related administrative spaces, 400 residential units, and a six-story parking garage. It is the perfect space for tenants looking to build clientele from the building's residents, neighboring hospitals, and the college campus.

## ON-SITE MEDICAL SPECIALTIES

Audiology  
Consultation/Post Op  
Dermatology  
General Practice  
Gynecology  
Hair Restoration  
Home Health  
Infertility Services  
Infusion Center  
Internal Health  
Laser Hair Removal  
Men's Health  
MRI  
Imaging  
OBGYN  
Orthopedic  
Pediatrics  
Plastic Surgery  
Preventative Medicine  
Research  
Prosthetics  
Psychiatry  
Psychology  
Reconstructive Surgery  
Sleep Center  
Urology

# GROUND FLOOR RETAIL & MEDICAL SUITES

Click here to view on  

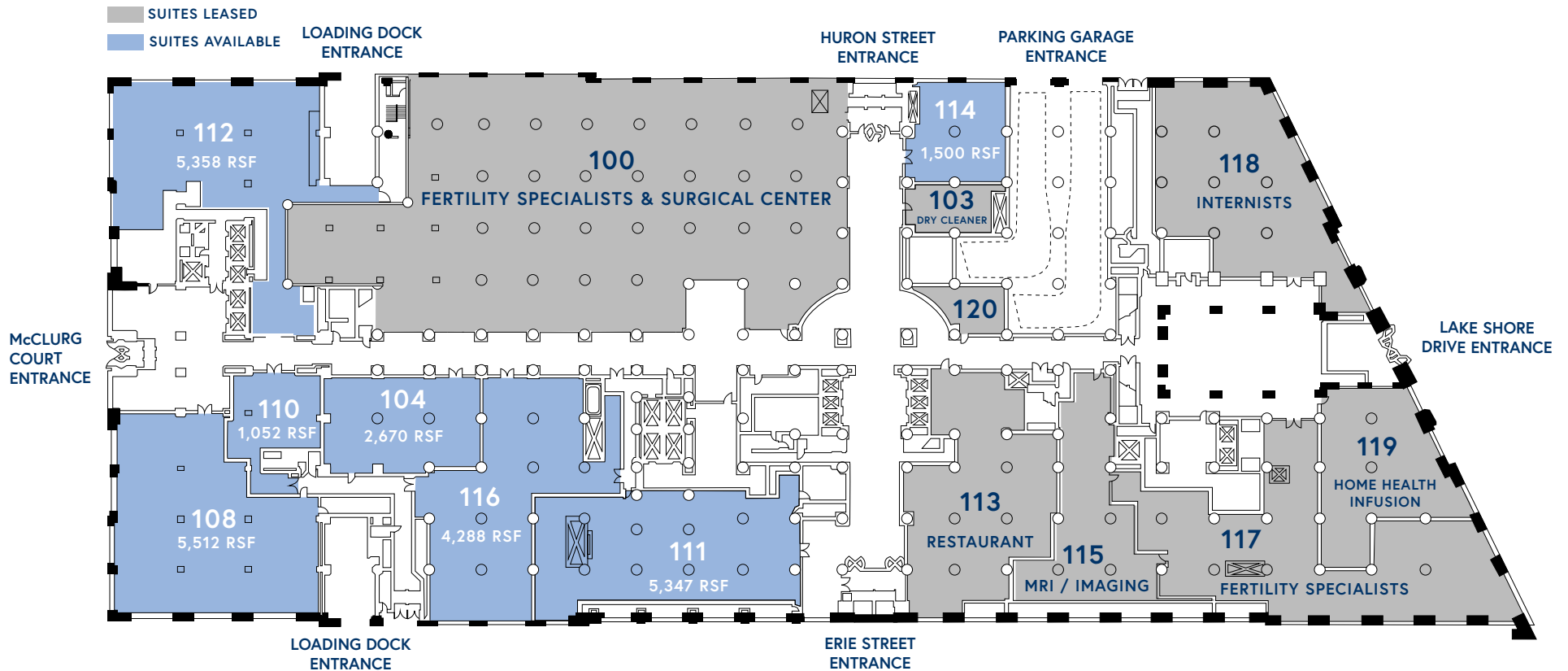
Suite 104	2,670 RSF
Suite 108	5,512 RSF
Suite 110	1,052 RSF
Suite 111	5,347 RSF

Suite 112	5,358 RSF
Suite 114	1,500 RSF
Suite 116	4,288 RSF
Suite 120	700 RSF



680  
NORTH LAKE SHORE DRIVE

## NEIGHBORHOOD HIGHLIGHTS

680 N Lake Shore Drive is in Chicago's Streeterville neighborhood—a prime location that contains some of Chicago's best attractions. It is home to Chicago's historic Navy Pier, which offers visitors access to amusement rides, gift shops, restaurants, sightseeing, the Chicago Children's Museum, and performances at the Chicago Shakespeare Theater. Other attractions in the area include the Lakefront Trail, the Museum of Contemporary Art, AMC River East, Lucky Strike Bowling, several high-end hotels and restaurants, and close proximity to the famous Magnificent Mile. Northwest Memorial Medical Center, Northwestern's School of Medicine, and Ann & Robert Lurie Children's Hospital are also located within Streeterville.

Streeterville also boasts an upscale residential experience. It has a diverse collection of amenities, such as Target and Whole Foods, as well as both high-end and fast-casual dining options. The neighborhood is walkable, close to Chicago's downtown Loop, and has access to multiple transportation options.

# PRIME MEDICAL HUB LOCATION





DEMOGRAPHICS	0.5 MILE	1 MILE	1.5 MILE
2024 POPULATION	28,221	84,638	133,205
MED. HOUSEHOLD INCOME	\$134,710	\$130,904	\$130,273
DAYTIME POPULATION	79,790	253,216	548,410



# CONTACT

KATIE STEELE  
312.881.7062

katie.steele@transwestern.com

