

# For Sale – Stand-Alone Industrial Building 840 Jury Court, San Jose

For Sale



**Building Size: +/-15,124 SF**

**Lot Size: 37,461 (.86 acres)**

**APN: 237-06-079**

**50% Office/50% Warehouse**

**16' Clear Height**

**3 Grade Doors**

**2 Dock Doors**

**Zoning – Heavy Industrial (HI)**

**[Link to Permitted Uses](#)**

**Two (2) - 400 amp panels  
(Buyer to verify)**

**Easy access to Highway 880/101**

**Potentially Divisible**

**2/1,000 Parking Ratio**

**Limited Inventory**

**Please call to tour**

*For more information, please contact:*

**Kevin Peixoto**

**408-557-0167**

**kevin@kpacommercial.com**

**www.kpacommercial.com**

**Lic. #: 01411086**

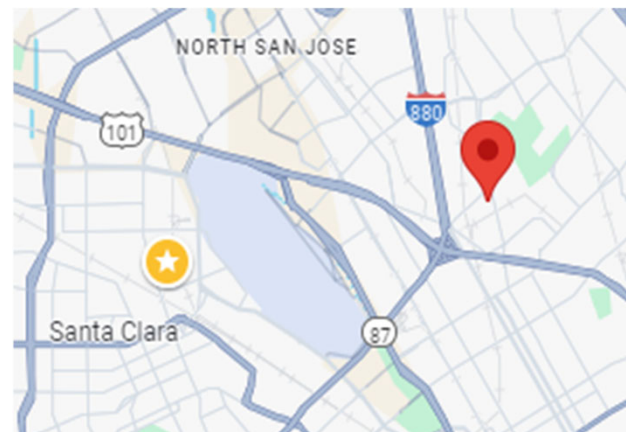

**KPA**  
COMMERCIAL

The information contained herein was obtained from sources believed reliable; however, KPA Commercial, Inc makes no guarantees, warranties or representations as to the completeness or accuracy thereof. The presentation of this property is submitted subject to errors, omissions, change of price or conditions prior to sale or lease, or withdrawal without notice.

# For Sale – Stand-Alone Industrial Building 840 Jury Court, San Jose

For Sale

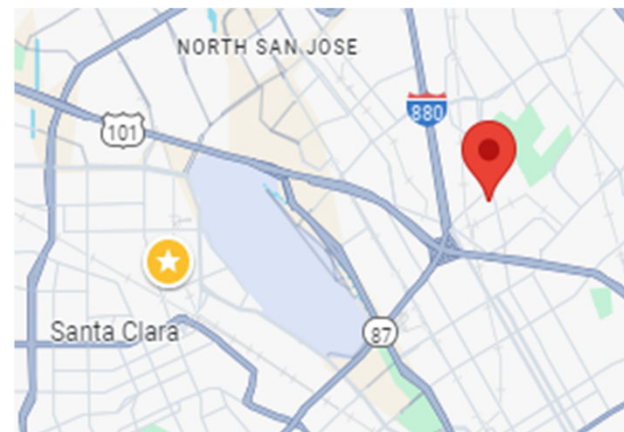
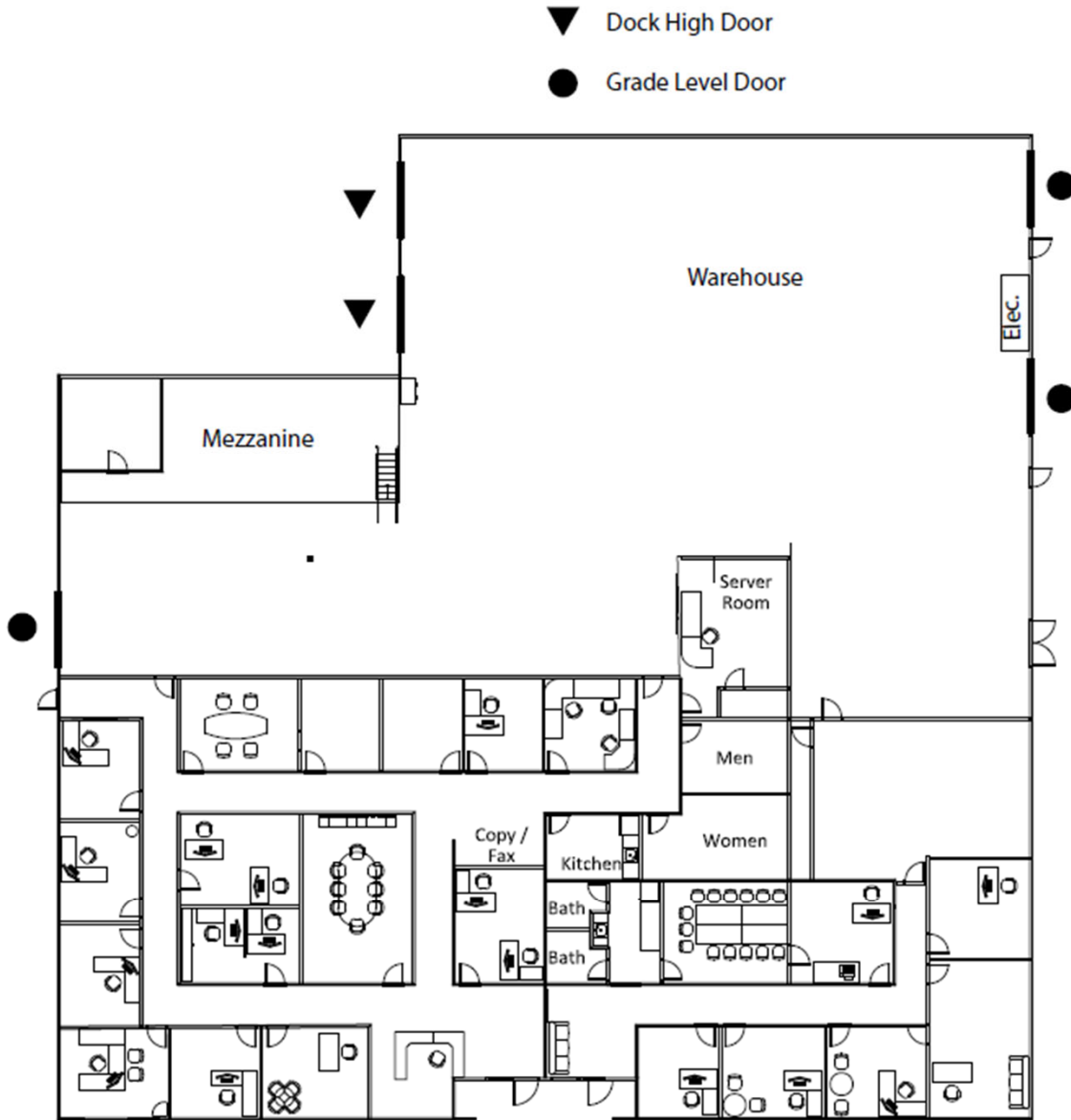

*Not to scale/not exact*

*For more information, please contact:*

**Kevin Peixoto**

**408-557-0167**

**kevin@kpacommercial.com**

**www.kpacommercial.com**

**Lic. #: 01411086**

**KPA**  
COMMERCIAL

The information contained herein was obtained from sources believed reliable; however, KPA Commercial, Inc makes no guarantees, warranties or representations as to the completeness or accuracy thereof. The presentation of this property is submitted subject to errors, omissions, change of price or conditions prior to sale or lease, or withdrawal without notice.