

FOR SALE

MOUNTAIN SHADOW INDUSTRIAL PARK

2223 East Rose Garden Loop | Phoenix, AZ 85024 – Occupied, Please Do Not Disturb Tenant

EAST VIEW

[CLICK HERE](#)
for photos and floorplan



George Haugen *Designated Broker*

9096 East Bahia Dr., Suite 108 | Scottsdale, AZ 85260 | (602) 499-6000 Mobile | www.HaugenCommercial.com | George@HaugenCommercial.com

The information contained herein has been provided to Haugen Commercial Real Estate, Inc. from various sources. Although Haugen Commercial Real Estate, Inc. has no reason to doubt the accuracy thereof, we do not guarantee such information. The prospective buyer or lessee is advised that he or she should independently verify all such information contained herein. All offerings are subject to prior sale, lease or withdrawal from the market without notice. By accepting this information, it is agreed that all negotiations regarding this property be made through Haugen Commercial Real Estate, Inc.

 **HAUGEN**
COMMERCIAL REAL ESTATE, INC.

FOR SALE

MOUNTAIN SHADOW INDUSTRIAL PARK

2223 East Rose Garden Loop | Phoenix, AZ 85024 – Occupied, Please Do Not Disturb Tenant

SOUTHEAST VIEW

[CLICK HERE](#)
for photos and floorplan



**SUBJECT
PROPERTY**

ROSE GARDEN LANE

George Haugen *Designated Broker*

9096 East Bahia Dr., Suite 108 | Scottsdale, AZ 85260 | (602) 499-6000 Mobile | www.HaugenCommercial.com | George@HaugenCommercial.com

The information contained herein has been provided to Haugen Commercial Real Estate, Inc. from various sources. Although Haugen Commercial Real Estate, Inc. has no reason to doubt the accuracy thereof, we do not guarantee such information. The prospective buyer or lessee is advised that he or she should independently verify all such information contained herein. All offerings are subject to prior sale, lease or withdrawal from the market without notice. By accepting this information, it is agreed that all negotiations regarding this property be made through Haugen Commercial Real Estate, Inc.

 **HAUGEN**
COMMERCIAL REAL ESTATE, INC.

FOR SALE

MOUNTAIN SHADOW INDUSTRIAL PARK

2223 East Rose Garden Loop | Phoenix, AZ 85024 – Occupied, Please Do Not Disturb Tenant

PROPERTY INFORMATION

Address: 2223 E Rose Garden Loop
Phoenix, Arizona 85024

Description: Mountain Shadow
Industrial Park
MCR 312-42 and CERT OF
COR 88-183419 LOT #1

Parcel: 213-09-011

Building Area: Approximately
9,000 Square Feet
Per Maricopa County

Building Type: Single Metal on Steel Frame
Per Maricopa County

Loading: Four (4) Grade Level Doors

Land Area: Approximately
23,660 Square Feet
Per Maricopa County

Association: \$400 Annually
Mountain Shadow Industrial
Park Property Owners
Association

Real Estate Taxes: \$9,029.22 (2024)

Zoning: Commerce Park/Business
Park Option

Price: Please Call

Disclosure: There is a 25' wide ingress/egress and drainage easement along the north property line per the recorded Rose Garden Industrial Park Plat prepared by D.N.A. Inc Engineering dated 12/27/86. There is a retention basin located immediately east of the subject property.

FLOORPLAN

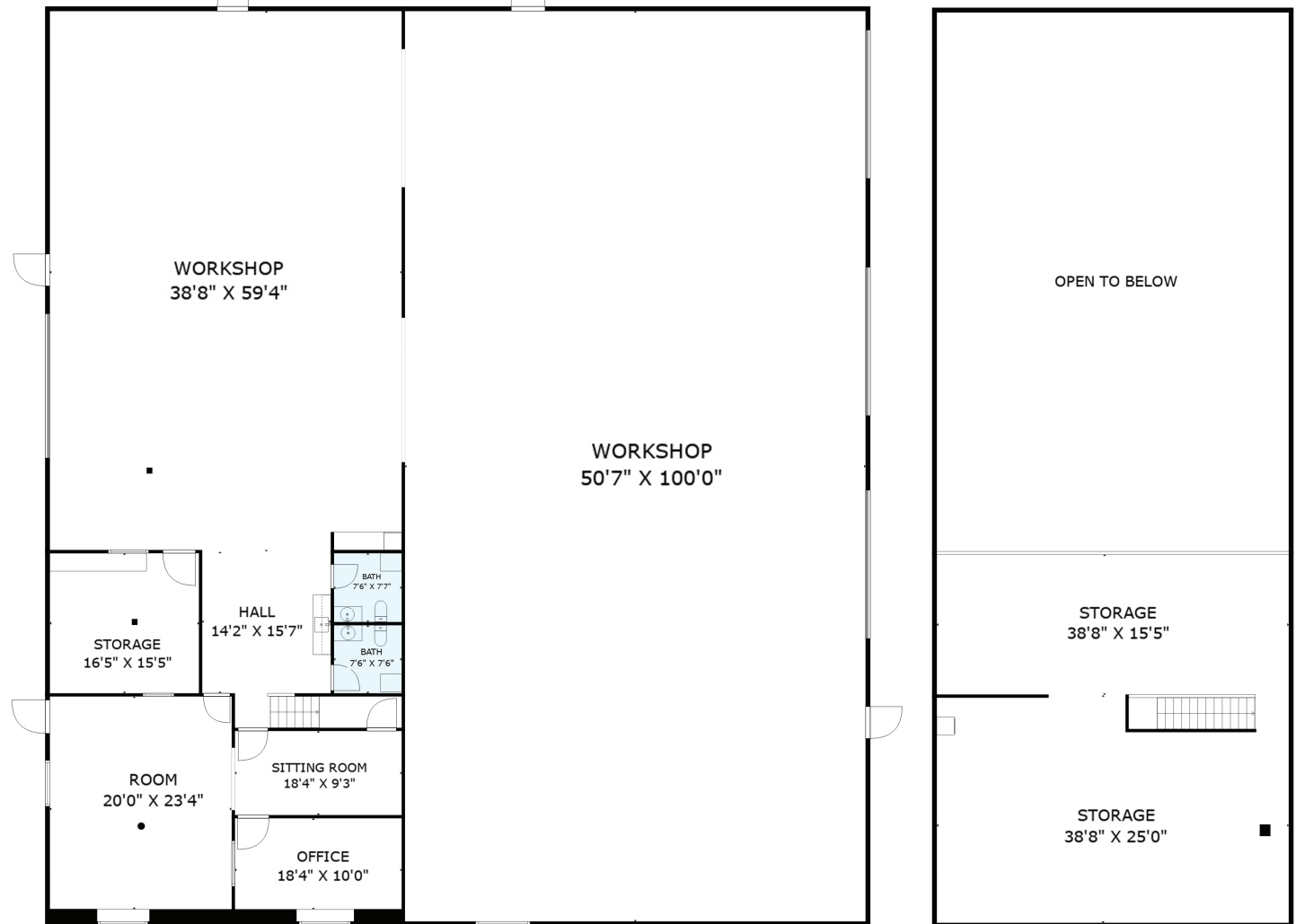

George Haugen Designated Broker

9096 East Bahia Dr., Suite 108 | Scottsdale, AZ 85260 | (602) 499-6000 Mobile | www.HaugenCommercial.com | George@HaugenCommercial.com

The information contained herein has been provided to Haugen Commercial Real Estate, Inc. from various sources. Although Haugen Commercial Real Estate, Inc. has no reason to doubt the accuracy thereof, we do not guarantee such information. The prospective buyer or lessee is advised that he or she should independently verify all such information contained herein. All offerings are subject to prior sale, lease or withdrawal from the market without notice. By accepting this information, it is agreed that all negotiations regarding this property be made through Haugen Commercial Real Estate, Inc.

 **HAUGEN**
COMMERCIAL REAL ESTATE, INC.

FOR SALE

MOUNTAIN SHADOW INDUSTRIAL PARK

2223 East Rose Garden Loop | Phoenix, AZ 85024 – Occupied, Please Do Not Disturb Tenant

SOUTHWEST VIEW

[CLICK HERE](#)
for photos and floorplan

ROSE GARDEN LANE

SUBJECT
PROPERTY

George Haugen *Designated Broker*

9096 East Bahia Dr., Suite 108 | Scottsdale, AZ 85260 | (602) 499-6000 Mobile | www.HaugenCommercial.com | George@HaugenCommercial.com

The information contained herein has been provided to Haugen Commercial Real Estate, Inc. from various sources. Although Haugen Commercial Real Estate, Inc. has no reason to doubt the accuracy thereof, we do not guarantee such information. The prospective buyer or lessee is advised that he or she should independently verify all such information contained herein. All offerings are subject to prior sale, lease or withdrawal from the market without notice. By accepting this information, it is agreed that all negotiations regarding this property be made through Haugen Commercial Real Estate, Inc.

 **HAUGEN**
COMMERCIAL REAL ESTATE, INC.

FOR SALE

MOUNTAIN SHADOW INDUSTRIAL PARK

2223 East Rose Garden Loop | Phoenix, AZ 85024 – Occupied, Please Do Not Disturb Tenant

NORTH VIEW

[CLICK HERE](#)
for photos and floorplan

**SUBJECT
PROPERTY**

ROSE GARDEN LANE

George Haugen *Designated Broker*

9096 East Bahia Dr., Suite 108 | Scottsdale, AZ 85260 | (602) 499-6000 Mobile | www.HaugenCommercial.com | George@HaugenCommercial.com

The information contained herein has been provided to Haugen Commercial Real Estate, Inc. from various sources. Although Haugen Commercial Real Estate, Inc. has no reason to doubt the accuracy thereof, we do not guarantee such information. The prospective buyer or lessee is advised that he or she should independently verify all such information contained herein. All offerings are subject to prior sale, lease or withdrawal from the market without notice. By accepting this information, it is agreed that all negotiations regarding this property be made through Haugen Commercial Real Estate, Inc.

 **HAUGEN**
COMMERCIAL REAL ESTATE, INC.

FOR SALE MOUNTAIN SHADOW INDUSTRIAL PARK

2223 East Rose Garden Loop | Phoenix, AZ 85024 – Occupied, Please Do Not Disturb Tenant

NORTHEAST VIEW

[CLICK HERE
for photos and floorplan](#)

SUBJECT
PROPERTY

ROSE GARDEN LOOP

ROSE GARDEN LANE

George Haugen *Designated Broker*

9096 East Bahia Dr., Suite 108 | Scottsdale, AZ 85260 | (602) 499-6000 Mobile | www.HaugenCommercial.com | George@HaugenCommercial.com

The information contained herein has been provided to Haugen Commercial Real Estate, Inc. from various sources. Although Haugen Commercial Real Estate, Inc. has no reason to doubt the accuracy thereof, we do not guarantee such information. The prospective buyer or lessee is advised that he or she should independently verify all such information contained herein. All offerings are subject to prior sale, lease or withdrawal from the market without notice. By accepting this information, it is agreed that all negotiations regarding this property be made through Haugen Commercial Real Estate, Inc.

 **HAUGEN**
COMMERCIAL REAL ESTATE, INC.

FOR SALE

MOUNTAIN SHADOW INDUSTRIAL PARK

2223 East Rose Garden Loop | Phoenix, AZ 85024 – Occupied, Please Do Not Disturb Tenant

LOCATION MAP

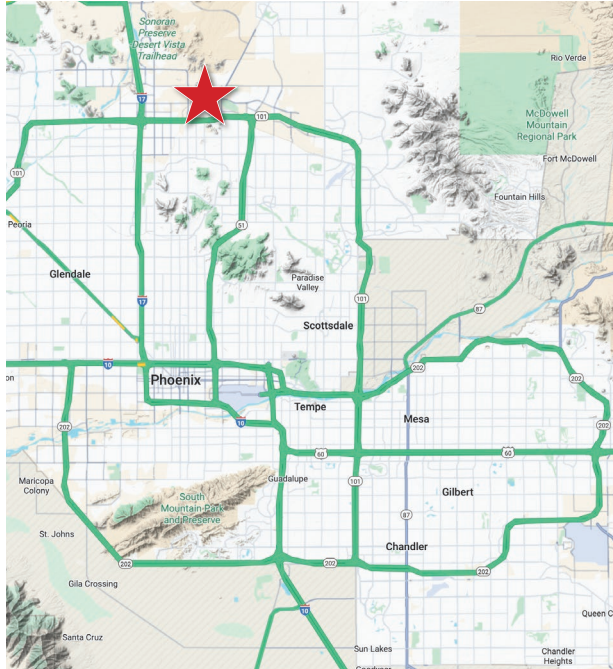

PHOENIX DEER VALLEY AIRPORT

The subject property is in the vicinity of the Deer Valley Airport. Please contact the Deer Valley Airport with any questions.

<https://www.deervalleyairport.com>

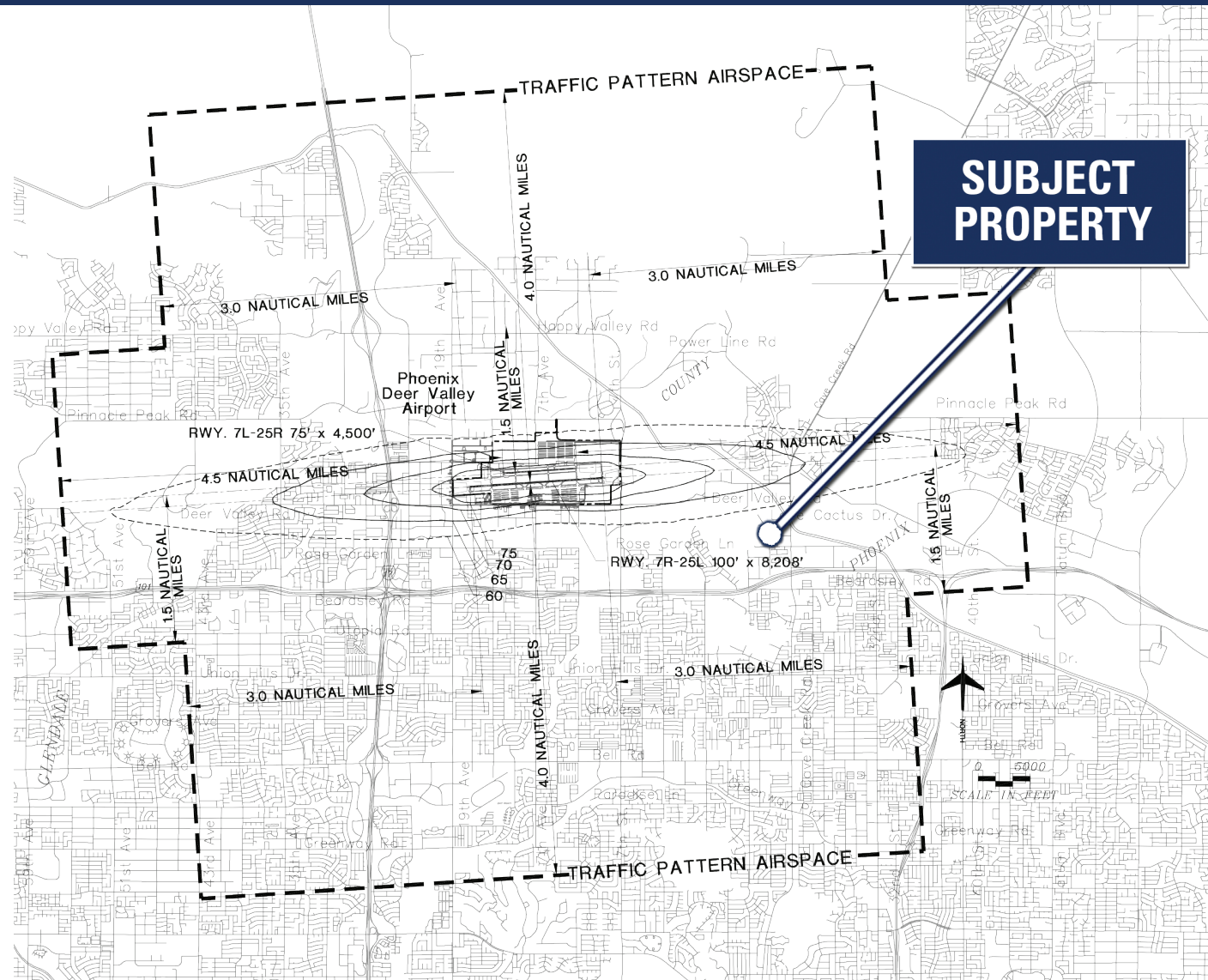

George Haugen Designated Broker

9096 East Bahia Dr., Suite 108 | Scottsdale, AZ 85260 | (602) 499-6000 Mobile | www.HaugenCommercial.com | George@HaugenCommercial.com

The information contained herein has been provided to Haugen Commercial Real Estate, Inc. from various sources. Although Haugen Commercial Real Estate, Inc. has no reason to doubt the accuracy thereof, we do not guarantee such information. The prospective buyer or lessee is advised that he or she should independently verify all such information contained herein. All offerings are subject to prior sale, lease or withdrawal from the market without notice. By accepting this information, it is agreed that all negotiations regarding this property be made through Haugen Commercial Real Estate, Inc.

HAUGEN
COMMERCIAL REAL ESTATE, INC.