

FOR SALE OR LEASE

# 509 ALABAMA STREET

REDLANDS, CALIFORNIA 92373

LBA Logistics 

PROPERTY  
VIDEO TOUR



**+73,729 SF INDUSTRIAL BUILDING**

**Vacant & Ready for Occupancy**



FOR MORE INFORMATION, CONTACT:

Cruise Adams  
909 942 4641  
cruise.adams@cushwake.com  
Lic. No: 02075368

Grant Arthur  
909 942 4699  
grant.arthur@cushwake.com  
Lic. No: 02064730

Chuck Belden, SIOR  
909 942 4640  
chuck.belden@cushwake.com  
Lic. No: 00844840

Phil Lombardo  
909 942 4678  
phil.lombardo@cushwake.com  
Lic. No: 00892477

 **CUSHMAN &  
WAKEFIELD**

**FOR SALE OR LEASE**

**509 ALABAMA STREET**  
REDLANDS, CALIFORNIA 92373

## BUILDING FEATURES



**±73,729 SF Industrial Building**



**30' Clear Height**



**±5,082 SF Office Space**  
(±2,391 SF 1st Floor / ±2,691 SF 2nd Floor)



**11 Dock High Loading Doors w/  
Mechanical Pit Levelers**



**2 Grade Level Ramps**



**116 Car Parking Spaces**



**130' Secured Truck Court w/  
Motorized Gates**



**LED Warehouse Lighting**



**ESFR Sprinkler System**

**LBA**Logistics



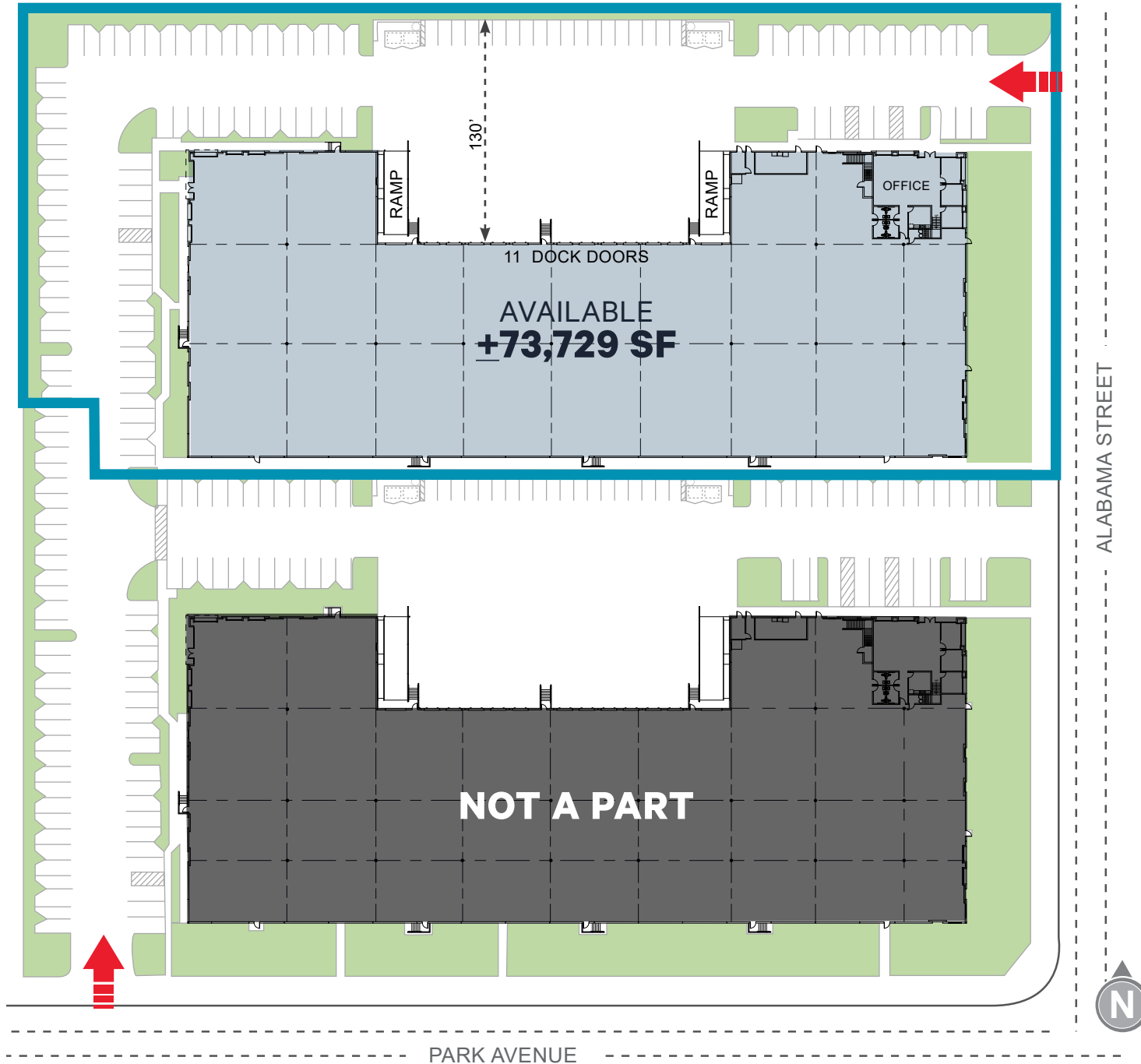

San Bernardino Fwy



Foothill Fwy



San Bernardino  
International Airport

Christopher Columbus Transcontinental Hwy

W Redlands Blvd



Alabama St

Alabama St



Tennessee St

# LOCATION MAP

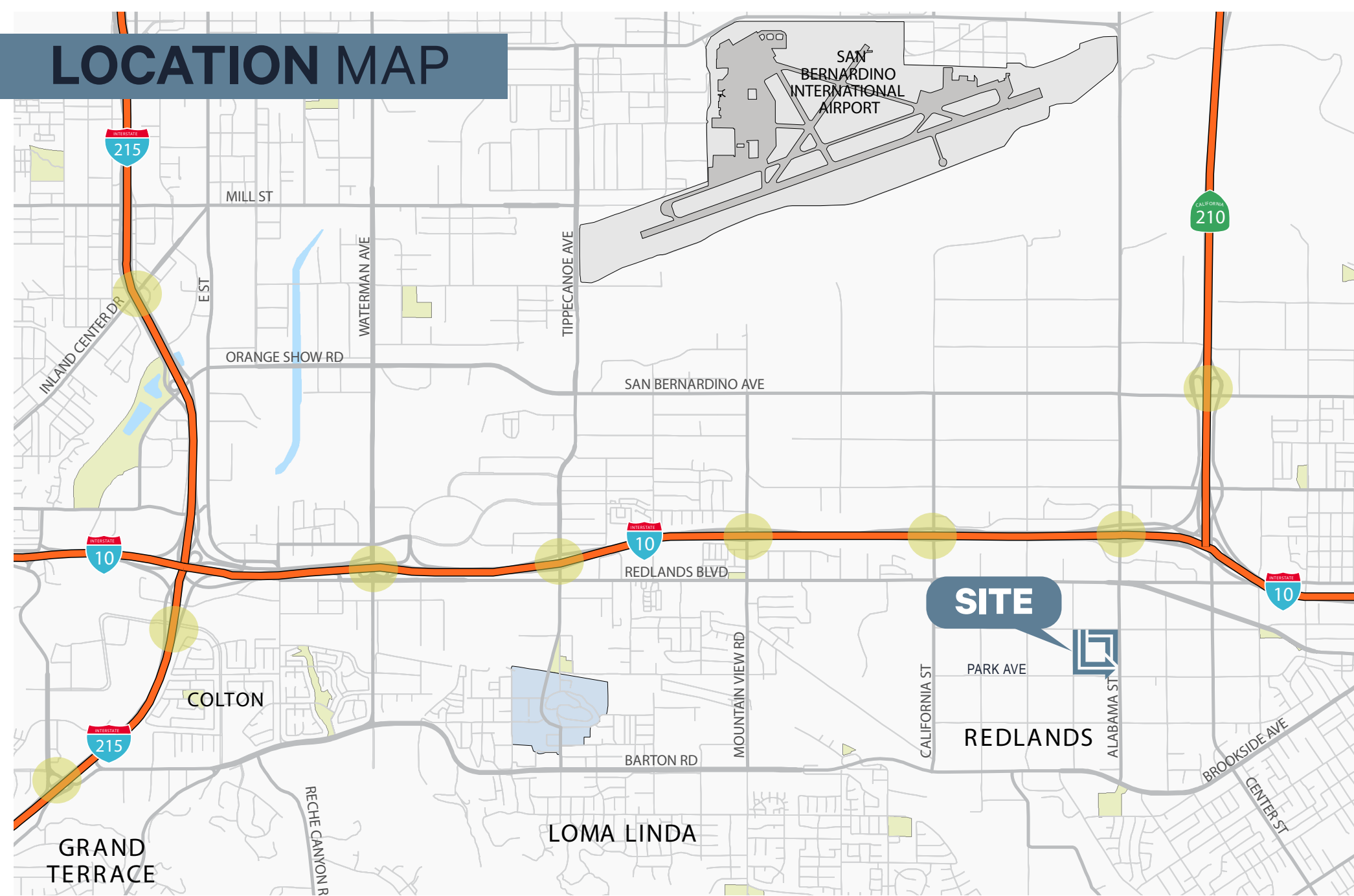

**LBA**Logistics 



FOR MORE INFORMATION, CONTACT:

**Cruise Adams**  
909 942 4641  
[cruise.adams@cushwake.com](mailto:cruise.adams@cushwake.com)  
Lic. No: 02075368

**Grant Arthur**  
909 942 4699  
[grant.arthur@cushwake.com](mailto:grant.arthur@cushwake.com)  
Lic. No: 02064730

**Chuck Belden, SIOR**  
909 942 4640  
[chuck.belden@cushwake.com](mailto:chuck.belden@cushwake.com)  
Lic. No: 00844840

**Phil Lombardo**  
909 942 4678  
[phil.lombardo@cushwake.com](mailto:phil.lombardo@cushwake.com)  
Lic. No: 00892477

 **CUSHMAN & WAKEFIELD**  
901 Via Piemonte, Suite 200,  
Ontario, CA 91764  
Lic. No: 00616335