

# Rh

RiverHouse 9

## 900 Avenue at Port Imperial, Weehawken

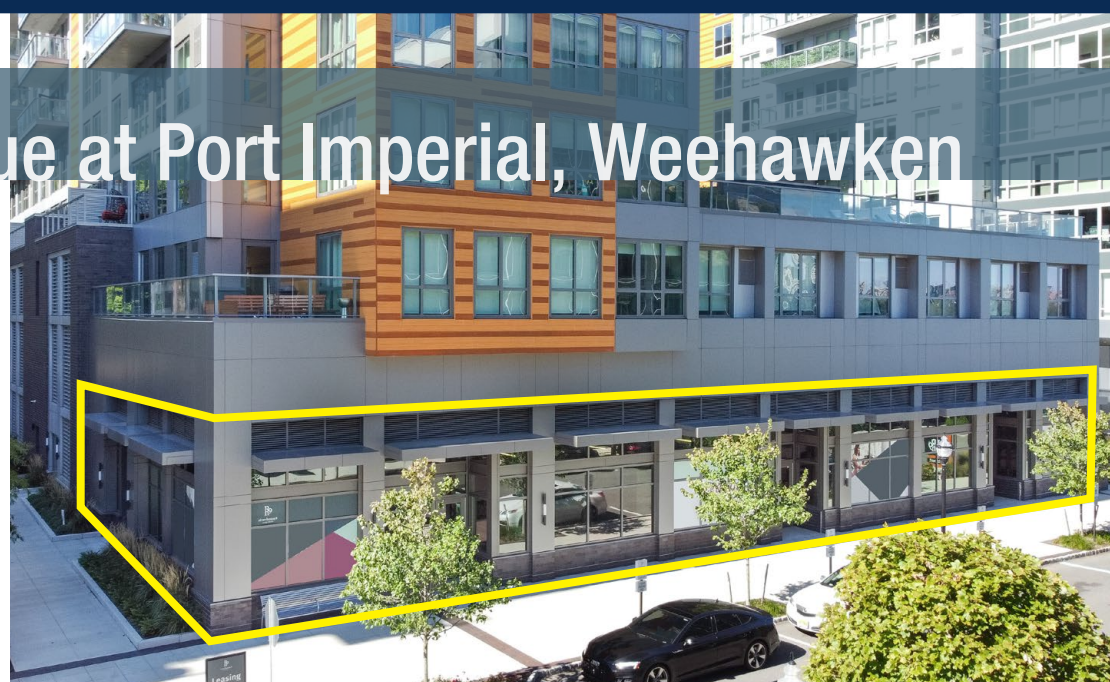
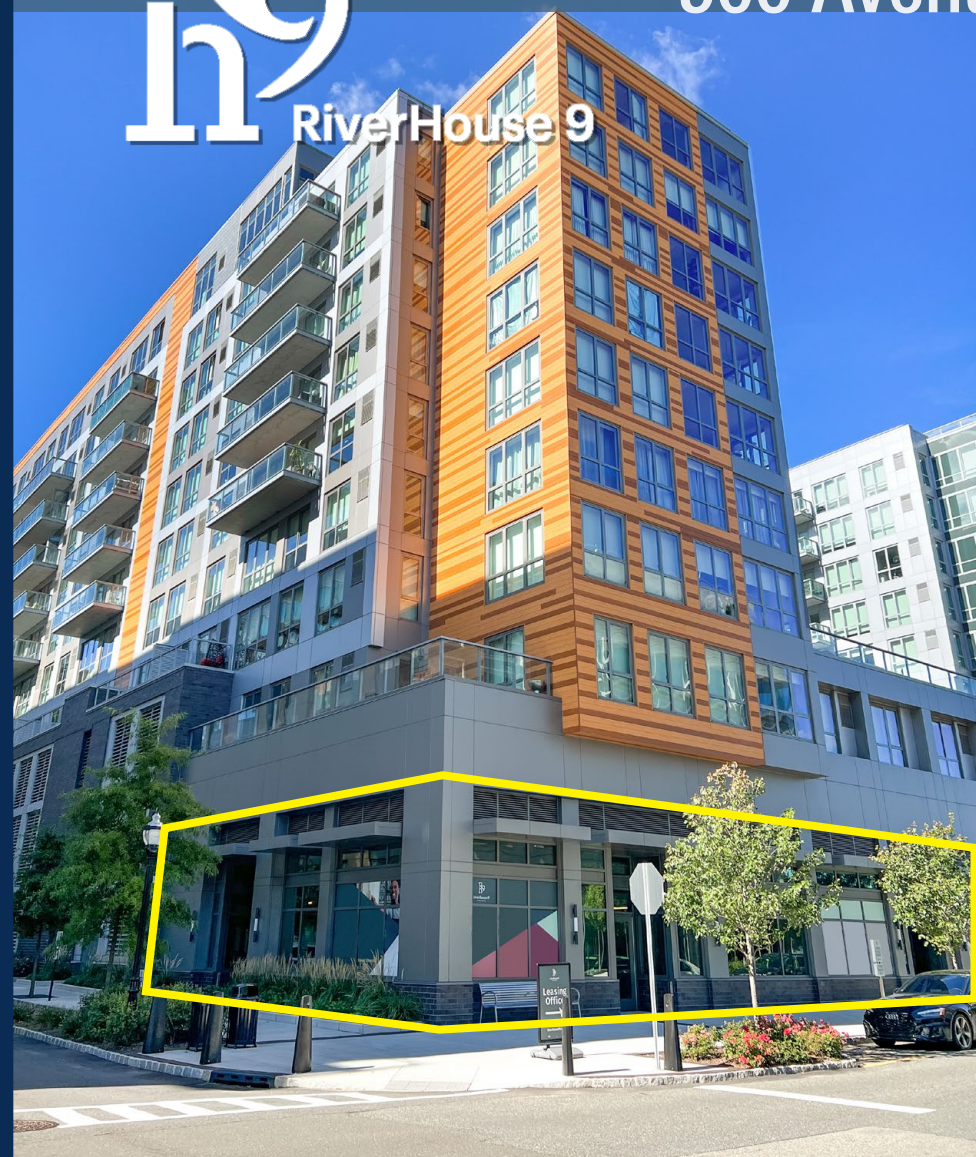

**veris**  
RESIDENTIAL

**Retail for Lease - Contact**

Rob Mackowski  
Ph. 732.724.4089  
[rob@piersonre.com](mailto:rob@piersonre.com)

**PIERSON**  
COMMERCIAL REAL ESTATE®

79 Route 520, Suite 202 • Englishtown, NJ 07726 • [www.piersonre.com](http://www.piersonre.com) • Licensed Real Estate Broker





# DETAILS

## Availability

+/- 4,252 SF (Divisible)

## Frontage

+/- 122 feet on Avenue at Port Imperial

## Neighboring Tenants



## Site Description

- Premier new construction retail space at the base of a 313-unit luxury residential building and in a highly dense residential market with a captive audience
- Located along River Road and in-between the Lincoln Tunnel & George Washington Bridge. River Road sees over 22,893 vehicles per day.
- Under a five-minute walk to the Port Imperial Ferry Terminal, Port Imperial Light Rail Station & NJ Transit Bus Stop
- 2-hour parking is available directly in front of the subject property
- Ability to provide flexible space size accommodations

## Demographics

| Radius  | Population | Employee Population | Median HH Income | Median Age |
|---------|------------|---------------------|------------------|------------|
| .5 Mile | 15,447     | 4,447               | \$102,060        | 37.6       |
| 1 Mile  | 73,290     | 20,457              | \$81,162         | 37.8       |
| 2 Mile  | 211,812    | 71,433              | \$82,860         | 37.4       |

# SPACE PLAN

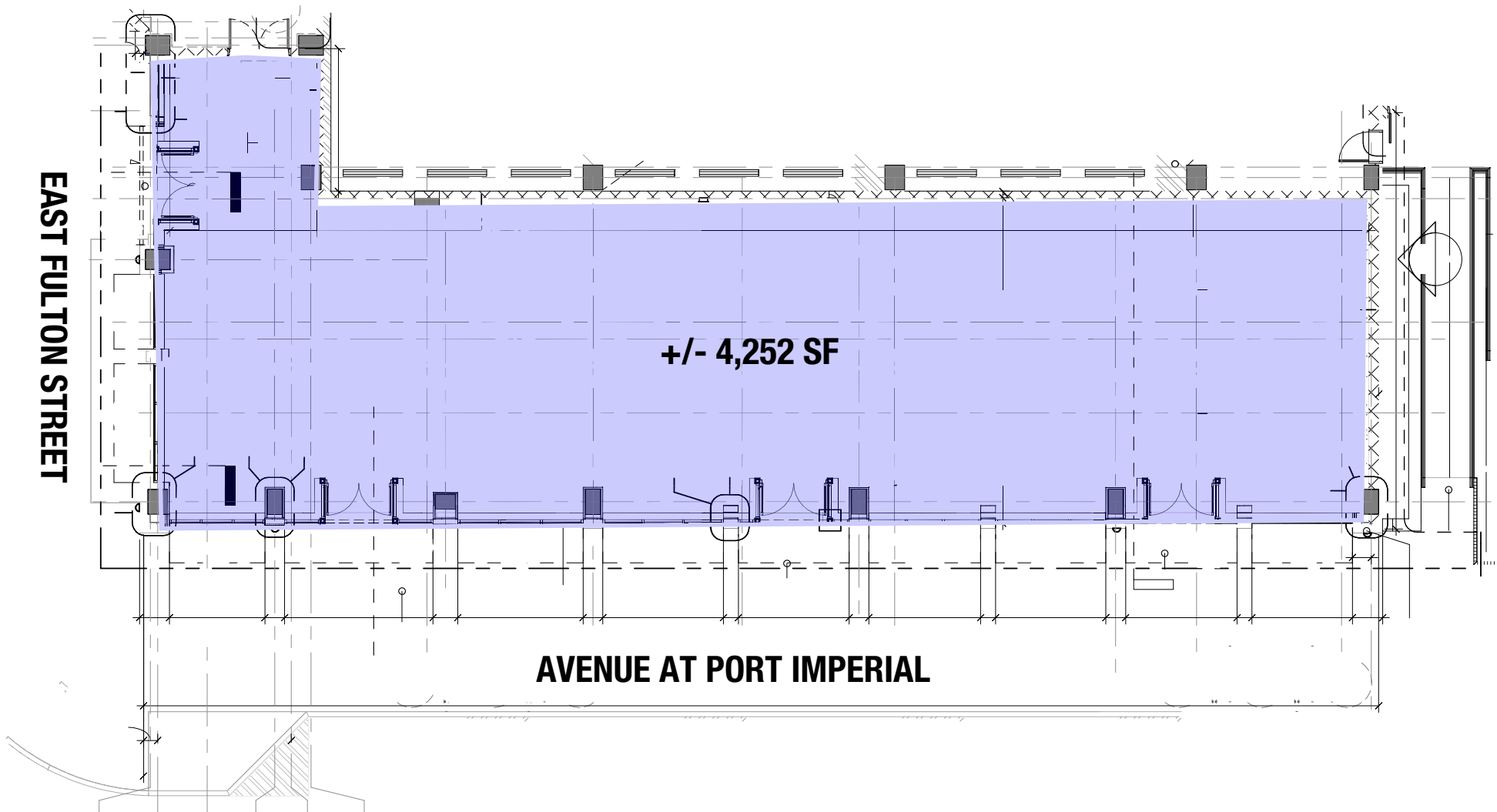



# AREA VIEWS / STATE MAP

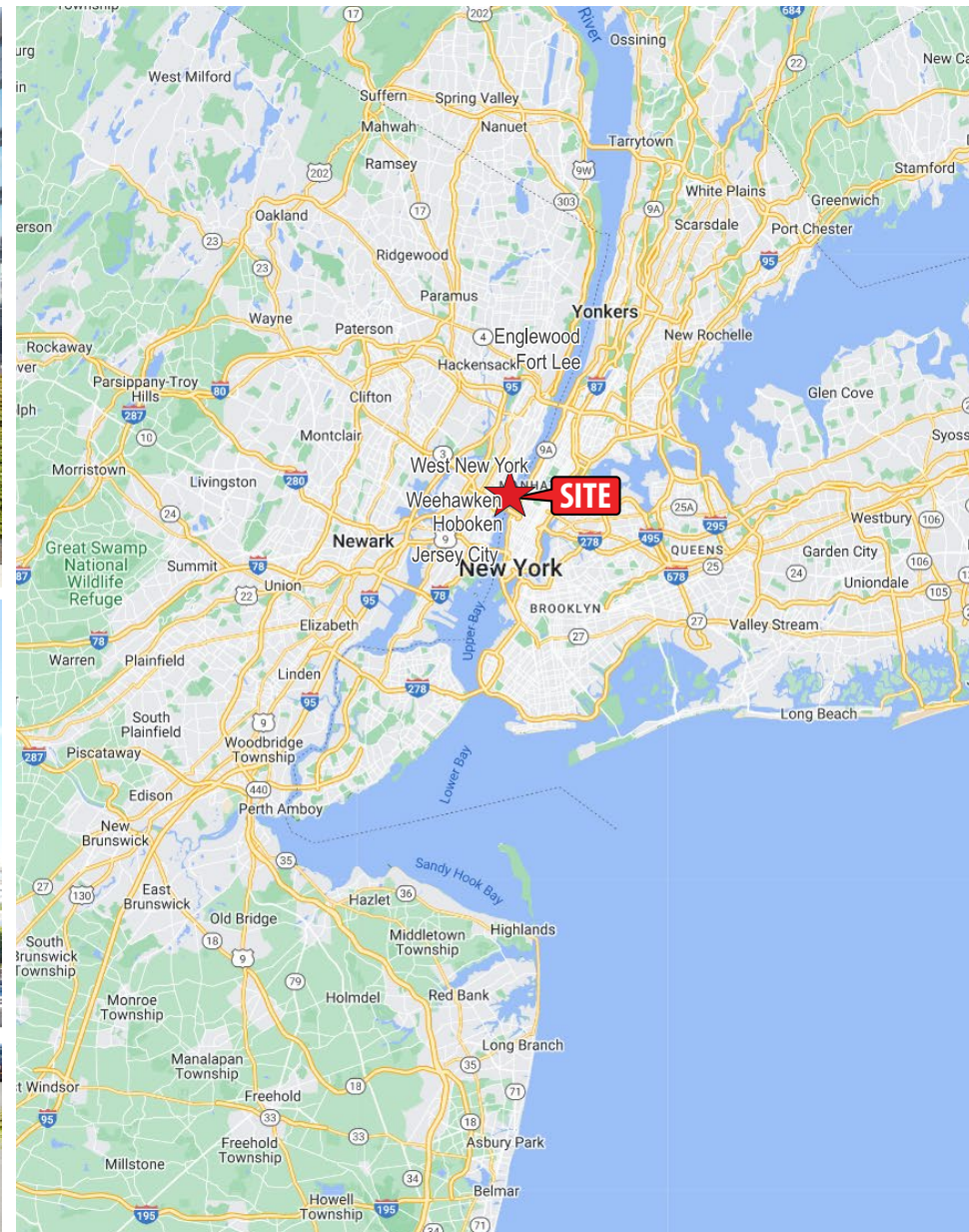
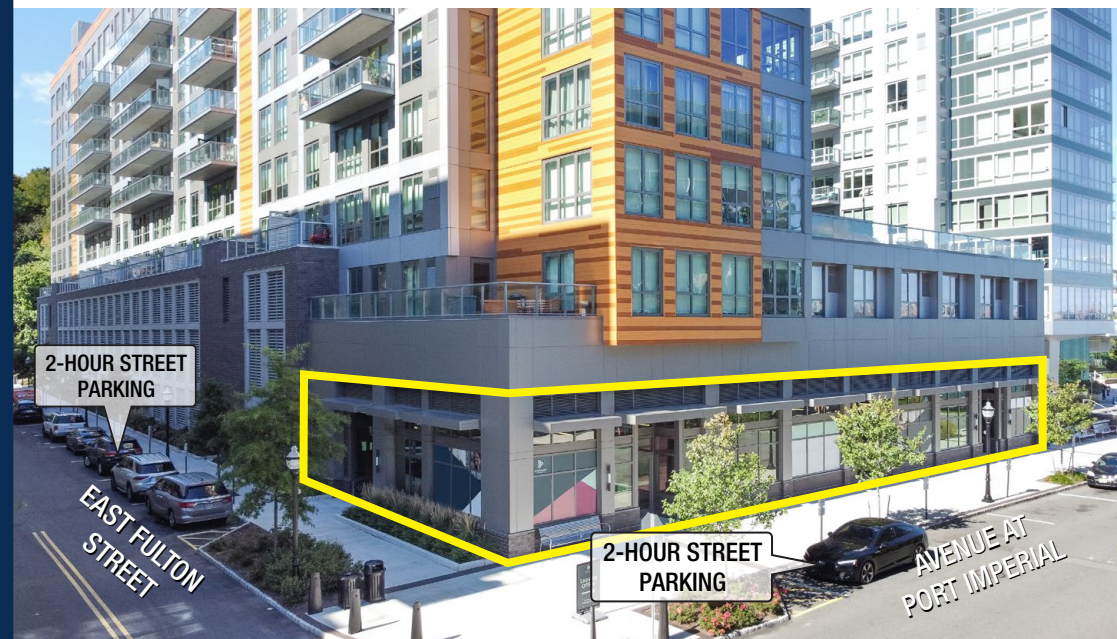



# MARKET AERIAL





# Rh

RiverHouse 9

# CONTACT



**veris**  
RESIDENTIAL

## Retail for Lease - Contact

Rob Mackowski  
Ph. 732.724.4089  
[rob@piersonre.com](mailto:rob@piersonre.com)

**PIERSON**  
COMMERCIAL REAL ESTATE®

© Pierson Commercial Real Estate LLC. This information has been obtained from sources believed reliable. We have not verified it and make no guarantee, warranty or representation about it. Any renderings, projections, opinions, assumptions or estimates used are for example only and do not represent the current or future performance of the property. You and your advisors should conduct a careful, independent investigation of the property to determine to your satisfaction the suitability of the property for your needs.