



100,000 SF Proposed

PHASE 2



ROSA LIND FRANKLIN  
UNIVERSITY  
of MEDICINE AND SCIENCE

# Innovation and Research Park

3333 GREEN BAY ROAD  
NORTH CHICAGO, IL

PURPOSE BUILT LAB





- **Promote innovation, entrepreneurship and workforce development with access to RFU students and University Researchers**
- **Grow your business in outstanding research facilities and proximity to the Midwest's largest concentration of life science companies**
- **Proximity to 122 bioscience companies in Lake County and 33,000 bioscience jobs**
- **Collaborate with RFU Research's Disease-Based Centers (>100 research scientists) including: neuroscience, genetic diseases, cancer, immunology & infection, diabetes, and woundcare**
- **Workforce development opportunity: 2,100 graduate level students from 6 healthcare related colleges including:**
  - **Chicago Medical School**
  - **Scholl College of Podiatric Medicine**
  - **College of Pharmacy**
  - **College of Nursing**
- **Access to 2 airports: O'Hare (30 minutes), Milwaukee (45 minutes)**

The Innovation and Research Park offers a **fertile environment for collaboration and creativity** among academic and industry scientists, innovators and entrepreneurs. The **100,000 square feet of laboratory and office space** will increase interaction, the free exchange of ideas and a sharing of expertise and scientific tools.

**Expansive Atrium Lobby with On-Site Cafe and Lounge**

**Large Auditorium, Training Rooms, and a Variety of Conferencing Spaces**

**Thoughtfully Designed Common Spaces for Industry and University to Collaborate**

**Fitness Center located in the Rothstein Warden Centennial Learning Center**

**Free Surface Parking Immediately Adjacent**

**Access to RFU Vivarium and Research Cores Including Medical Simulation Labs**



# PHASE 2

# Site Plan

- A** Proposed IRP Phase II Building
- B** Main Entry Plaza
- C** Rear Entry/Employee Plaza
- D** Service Yard/Load Dock

- E** Existing IRP Phase I Building
- F** Existing Solomon Learning Center/Boxer Library
- G** Access to Green Bay Road

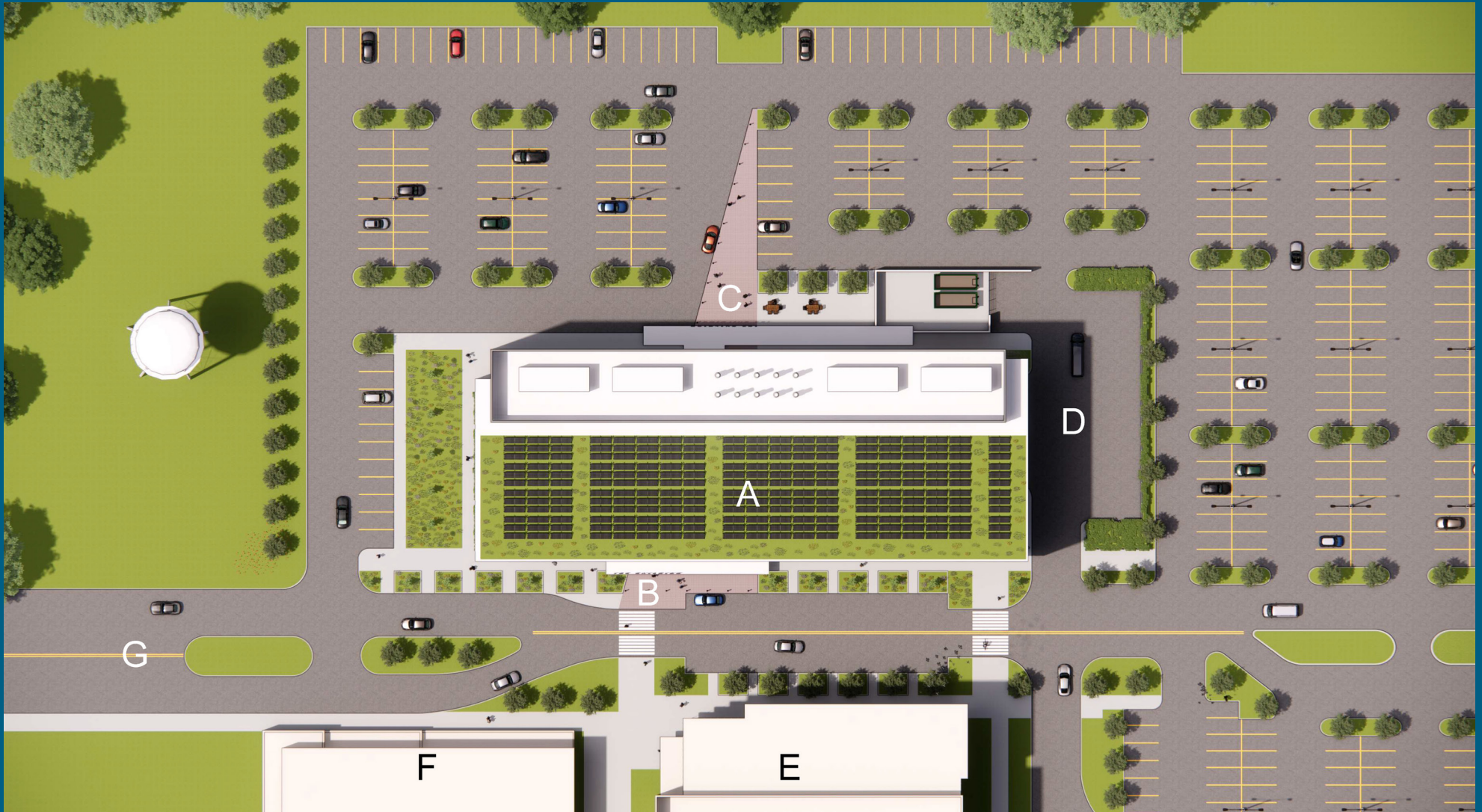

Labs

Lab Support

Office/Conferences

Core



**First Floor** 25,000 SF Available

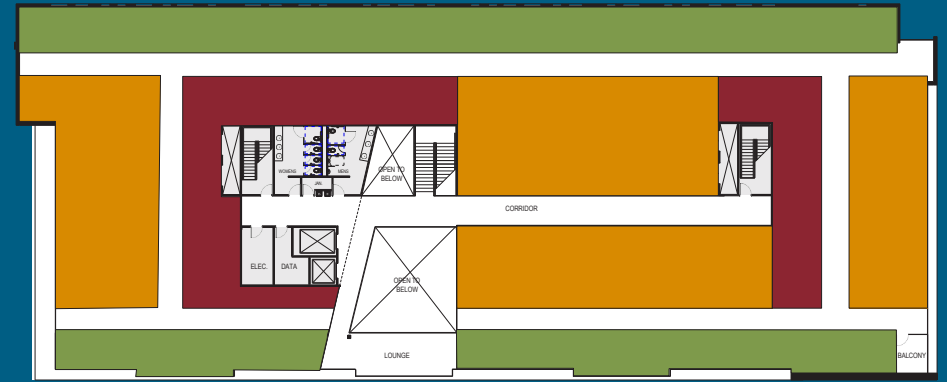

**Second Floor** 25,000 SF Available



**Third Floor** 25,000 SF Available



**Fourth Floor** 25,000 SF Available

**Prime location** between Chicago and Milwaukee **with direct access** to the region's largest concentration of pharmaceutical and medical device companies.

Located in Chicago's north shore suburbs, IRP leverages the many benefits of its location between two major metropolitan areas - Chicago and Milwaukee. This prime location gives the RFU community access to a significant range of clinical and service learning experiences.

From IRP, you can reach downtown Chicago in less than an hour's drive, or can catch the nearby commuter train. Milwaukee, the largest city in Wisconsin, is an hour's drive north of campus.

Lake Michigan's sandy shoreline is just a few miles from campus, and Lake County Forest Preserves land - more than 30,000 acres containing 182 miles of trails for hiking and biking - surrounds the campus.

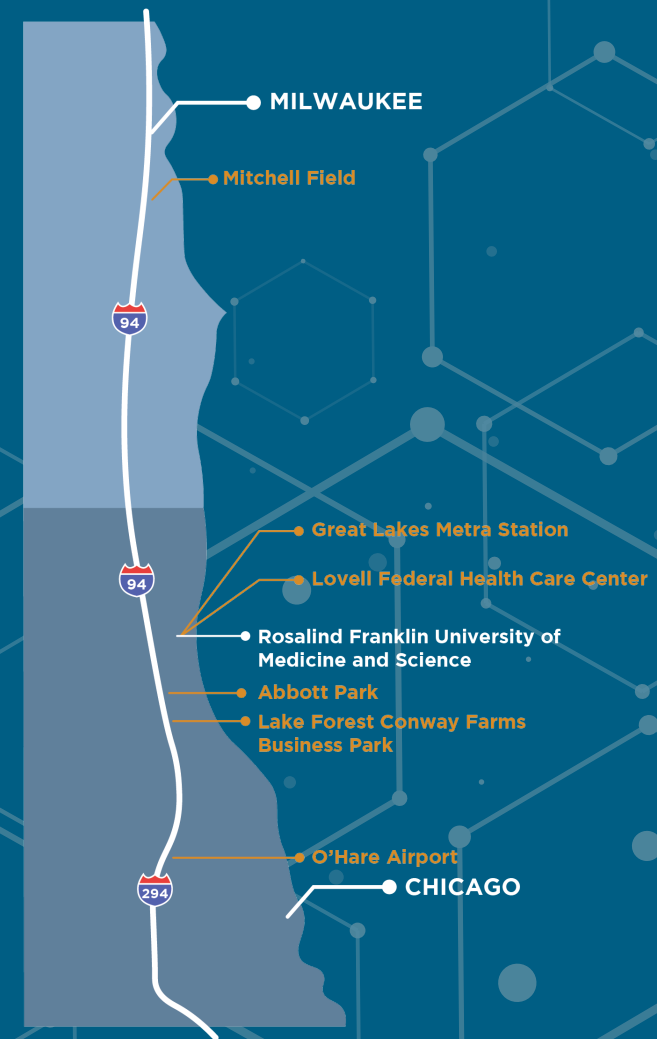



**ROSALIND FRANKLIN UNIVERSITY**  
of MEDICINE AND SCIENCE

**Property Highlights**  
3333 GREEN BAY ROAD | NORTH CHICAGO, IL 60064

- Immediate access to Highway 41
- Walking distance from the Great Lakes Metra station
- Close proximity to the Lovell Federal Healthcare Center, Naval and Veteran's hospitals

● HOTELS & INNS    ● RESTAURANTS    ● HOSPITALS



AVISON  
YOUNG



[Watch Video](#)

For more information,  
please get in touch.

**CHAD BERMINGHAM**

Vice President  
312.796.0361  
[chad.bermingham@avisonyoung.com](mailto:chad.bermingham@avisonyoung.com)

**EMILY MARQUARDT**

Vice President  
312.796.0446  
[emily.marquardt@avisonyoung.com](mailto:emily.marquardt@avisonyoung.com)

**KEVIN MALLOY**

Principal  
617.250.7603  
[kevin.malloy@avisonyoung.com](mailto:kevin.malloy@avisonyoung.com)