

# Hackberry Market

1602 East Houston Street, SA, TX 78202

Suite 109 - **2,025 +/- USF**

2<sup>nd</sup> Generation Brewery with possibility for brewing equipment and other FF&E. Brewery could be for sale. Landlord open to new concepts.

Roll up garage door on brewing side of space.  
Prime inline space w/patio space.  
Keg cooler in place.  
Various FF&E could be included.

26 - Parking Spaces in the center.

Property video links here:

[https://1drv.ms/v/s!AkcDmJfDgty\\_hcd4mj6G0dmaWk3ugw](https://1drv.ms/v/s!AkcDmJfDgty_hcd4mj6G0dmaWk3ugw)

[https://1drv.ms/v/s!AkcDmJfDgty\\_hcd5O17N8J9fxe9puA?e=](https://1drv.ms/v/s!AkcDmJfDgty_hcd5O17N8J9fxe9puA?e=)

Zoned: IDZ (alcohols sales ok)

**\$26.00 per Sq. Ft. Annually + NNN's & utilities.**

**ZURICH U.S. PROPERTIES, INC.**

Laurence P. Seiterle

O: 210.225.5877 Cell: 210.279.7509

[Laurence@zurichproperties.com](mailto:Laurence@zurichproperties.com)



The information contained herein is based upon information supplied by third parties; however Zurich U.S. Properties, Inc. makes no representation or warranties as to its accuracy or as to its suitability, merchantability or condition of the property. This offering is subject to errors, omissions, changes of price or withdrawn from the market without notice.

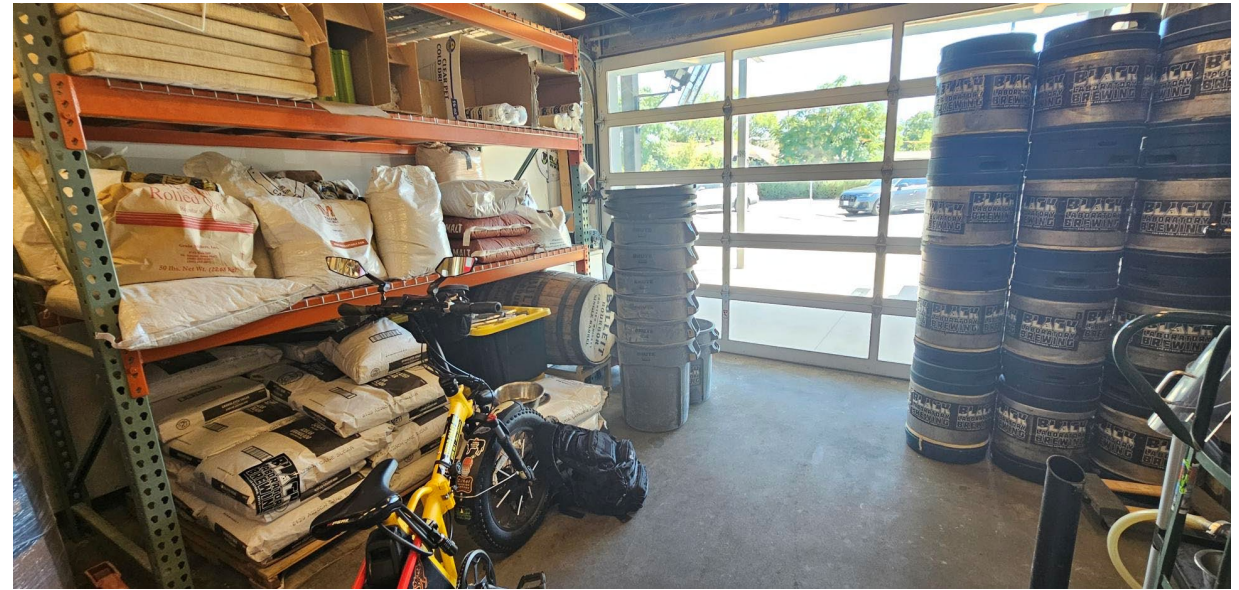



**Co-Tenants Include:**

Credit Human

Cake Thieves

The Magpie

2-1 Dough Pizza



**Houston Street**

Double Sided

Full Color Signage.

Downtown is blocks away.  
Full Shaded Store Fronts.  
Each Tenant can add their  
own patio furniture to the  
shaded space in from of  
their space.

Area Tenants:

Velocity Texas Bio-  
Incubator, Estate Coffee –  
Con Huevos,  
Dignowity Meats, Rock Box,

Blocks from:

Downtown, Alamo Dome,  
Saint Paul Square, Velocity  
Texas BioMed Incubator,  
The Carver, IDEA School.

Hackberry Street Signage.

Hackberry Street Ingress-Egress.



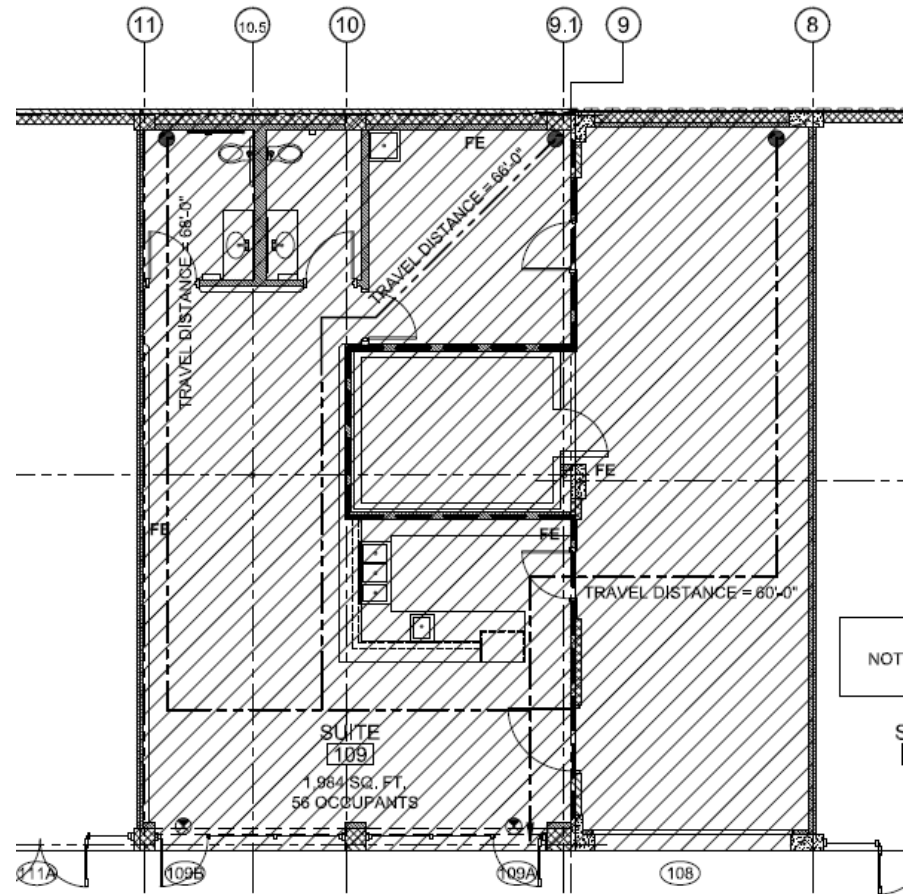

**PLAN**  
Scale: 1/8"=1'-0"

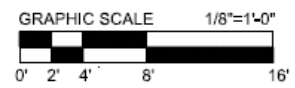

Floor Plan to be verified.