



# SCHOOL SPACE FOR LEASE

13205 PHILADELPHIA ST, WHITTIER, CA



## Offering

First Friends Church Whittier is offering the opportunity to lease school space within its church campus. The offering provides exclusive use with 24/7 availability . Two classrooms with private entrance and bathrooms. This space would work great for private, public/charter, or after school programs.

**RILEY ROHDE**  
858.369.3041  
riley.rohde@kidder.com  
LIC N° 02207141

**ROBERT FLETCHER**  
858.369.3034  
robert.fletcher@kidder.com  
LIC N°01706060

**ERIC KNOWLES**  
858.369.3017  
eric.knowles@kidder.com  
LIC N° 00944210

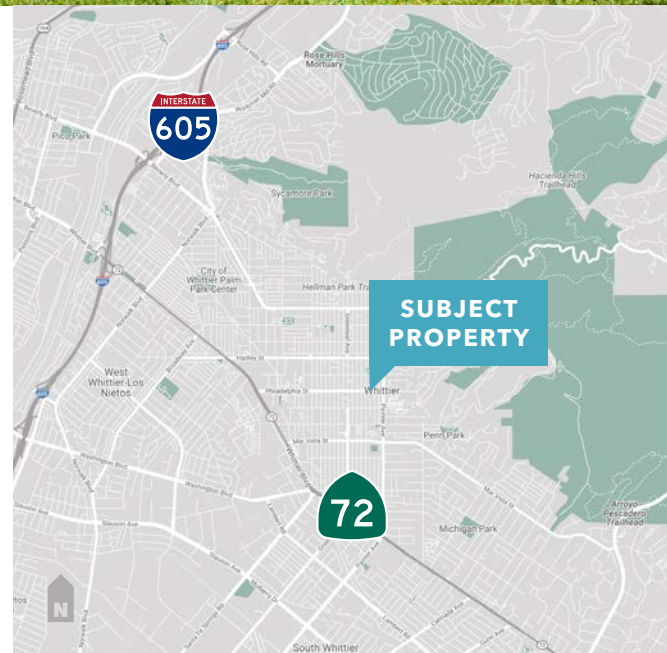

This information supplied herein is from sources we deem reliable. It is provided without any representation, warranty, or guarantee, expressed or implied as to its accuracy. Prospective Buyer or Tenant should conduct an independent investigation and verification of all matters deemed to be material, including, but not limited to, statements of income and expenses. Consult your attorney, accountant, or other professional advisor.

KIDDER.COM

**FOR LEASE**

# School Space

13205 PHILADELPHIA ST, WHITTIER, CA

## Summary

<b>PREMISES</b>	±2,148 SF, 2 large classrooms on 2nd floor.
<b>UTILITIES</b>	Tenant to pay its share of sewer, water, gas, electric, and trash.
<b>PARKING</b>	On-site parking.
<b>RESTROOMS</b>	2 restrooms in upper level.
<b>APPROVALS</b>	Tenant to verify if Conditional Use Permit is required.
<b>NON-PROFIT / FOR PROFIT</b>	Non-profit is preferred; Landlord will consider for-profit (Tenant to be responsible for any increase in property taxes).
<b>LEASE RATE</b>	\$2.00/PSF



**RILEY ROHDE**  
858.369.3041  
riley.rohde@kidder.com  
LIC N° 02207141

**ROBERT FLETCHER**  
858.369.3034  
robert.fletcher@kidder.com  
LIC N°01706060

**ERIC KNOWLES**  
858.369.3017  
eric.knowles@kidder.com  
LIC N° 00944210

**KIDDER.COM**

This information supplied herein is from sources we deem reliable. It is provided without any representation, warranty, or guarantee, expressed or implied as to its accuracy. Prospective Buyer or Tenant should conduct an independent investigation and verification of all matters deemed to be material, including, but not limited to, statements of income and expenses. Consult your attorney, accountant, or other professional advisor.



**FOR LEASE**

# School Space

13205 PHILADELPHIA ST, WHITTIER, CA

## Floor Plan - Second Floor | ±2,418 SF

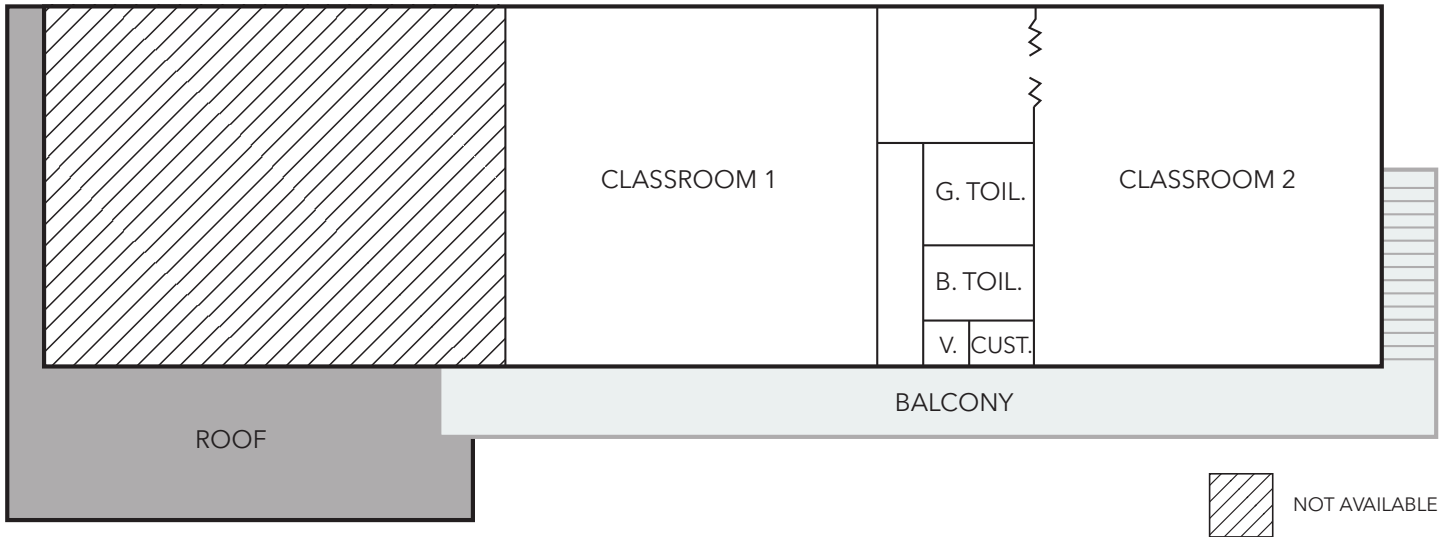

**RILEY ROHDE**  
858.369.3041  
riley.rohde@kidder.com  
LIC N° 02207141

**ROBERT FLETCHER**  
858.369.3034  
robert.fletcher@kidder.com  
LIC N°01706060

**ERIC KNOWLES**  
858.369.3017  
eric.knowles@kidder.com  
LIC N° 00944210

**KIDDER.COM**

This information supplied herein is from sources we deem reliable. It is provided without any representation, warranty, or guarantee, expressed or implied as to its accuracy. Prospective Buyer or Tenant should conduct an independent investigation and verification of all matters deemed to be material, including, but not limited to, statements of income and expenses. Consult your attorney, accountant, or other professional advisor.

