

MEDINA RETAIL

RETAIL FOR LEASE/GROUND LEASE/B-T-S

3105 MEDINA ROAD, MEDINA, OHIO 44256



JESSE SHKOLNIK ADVISOR

MOBILE 614.208.5360 | DIRECT 614.334.7818
JSHKOLNIK@EQUITY.NET



MATT COOPER SENIOR VICE PRESIDENT

MOBILE 614.403.4732 | DIRECT 614.334.7831
MCOOPER@EQUITY.NET



The information contained herein has been obtained from the property owner or other sources that we deem reliable. Although we have no reason to doubt its accuracy, no representation or warranty is made regarding the information, and the property is offered "as is". The submission may be modified or withdrawn at any time by the property owner.

PROPERTY HIGHLIGHTS

MEDINA RETAIL

RETAIL FOR LEASE/GROUND LEASE/B-T-S
3105 MEDINA ROAD, MEDINA, OHIO 44256

- +/- 2,880 SF free-standing restaurant building; built in 1999
- +/- 1.65 acre lot—can be ground leased or build-to-suit
- 57 parking spaces (19.79 per 1,000 SF)
- Pylon signage available with visibility from Interstate 71
- High visibility location with 300' frontage
- 24,097 vehicles per day on Medina Road
- Located ¼ mile off I-71 (57,983 VPD)

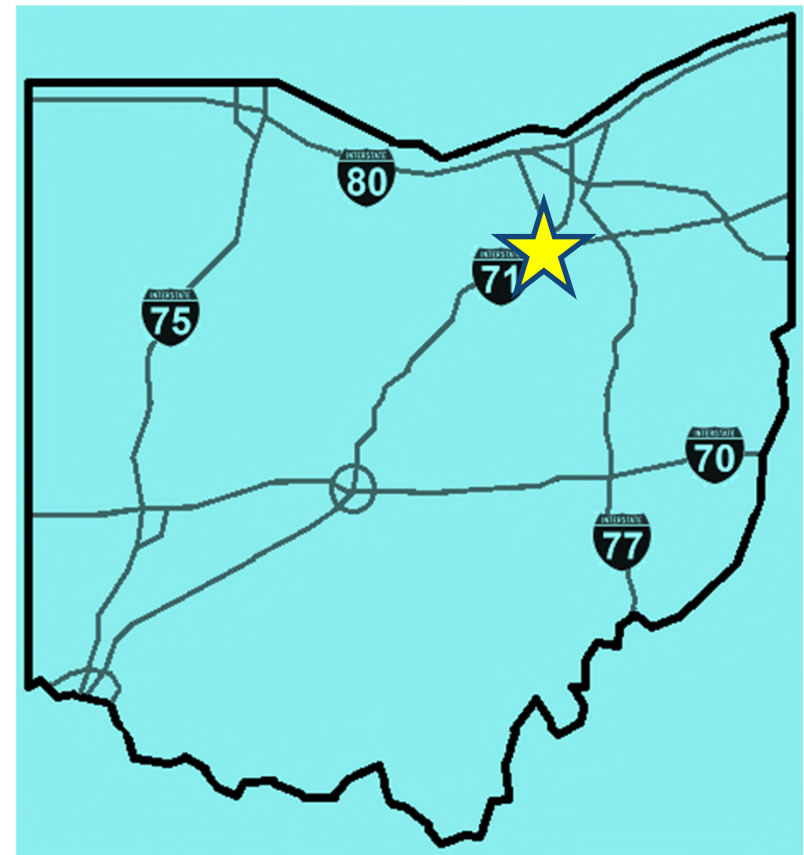

SITE PLAN

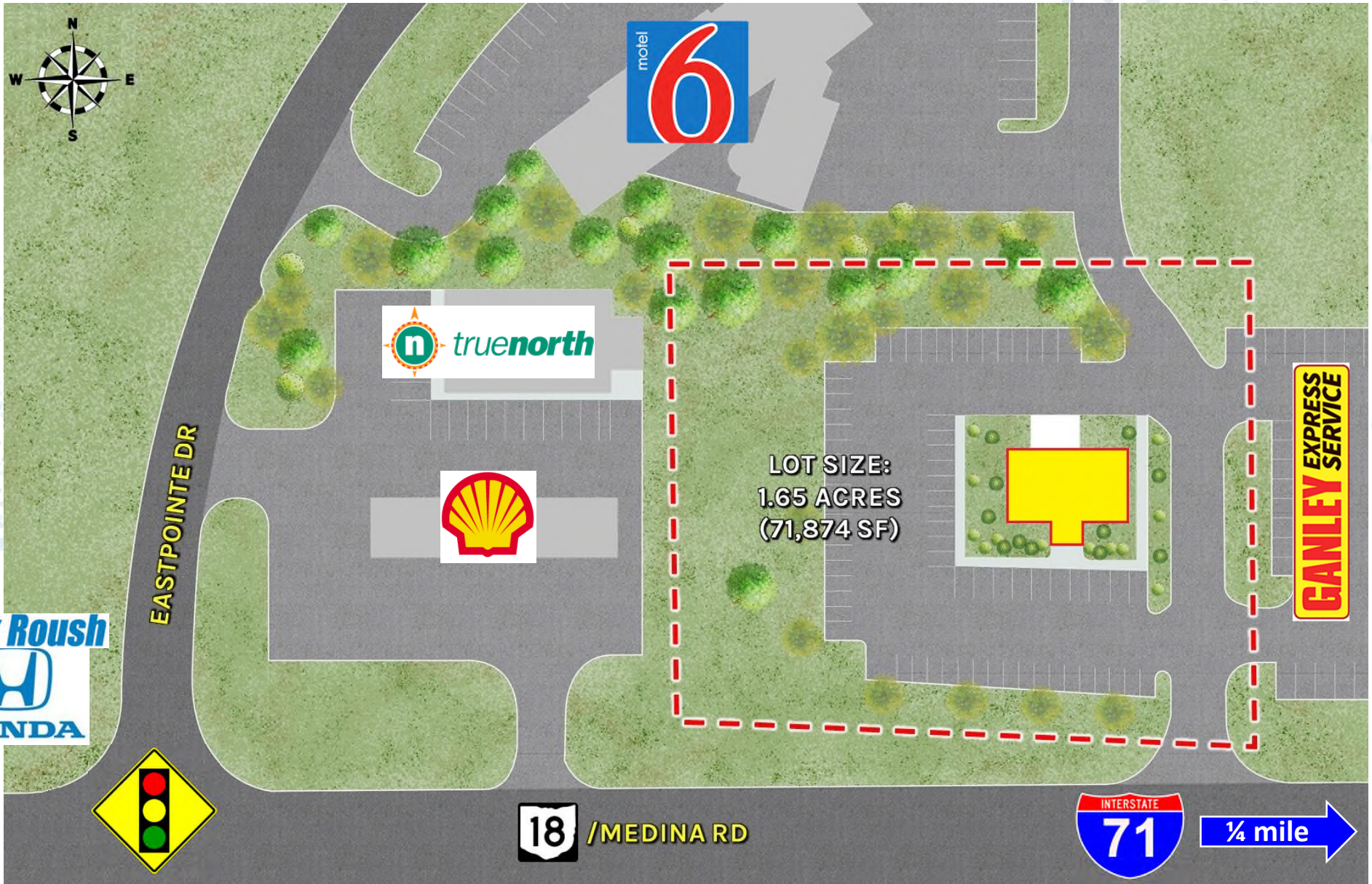

equity | brokerage

www.equity.net

The information contained herein has been obtained from the property owner or other sources that we deem reliable. Although we have no reason to doubt its accuracy, no representation or warranty is made regarding the information, and the property is offered "as is". The submission may be modified or withdrawn at any time by the property owner.

PHOTOS



SITE AERIAL



equity | brokerage

www.equity.net

The information contained herein has been obtained from the property owner or other sources that we deem reliable. Although we have no reason to doubt its accuracy, no representation or warranty is made regarding the information, and the property is offered "as is". The submission may be modified or withdrawn at any time by the property owner.

1-MILE RADIUS DEMOS

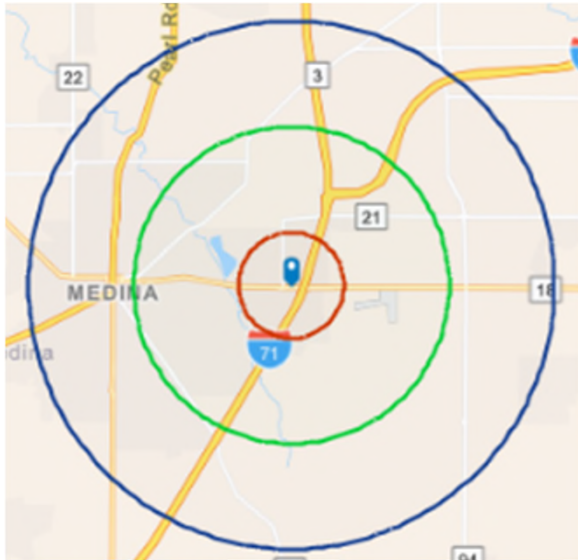

KEY FACTS

3,572
Population

2.3
Average
Household Size

48.4
Median Age

\$117,670
Median Household Income

BUSINESS

235

Total Businesses

2,181

Total Employees

EDUCATION

2%

No High School
Diploma

16%

High School
Graduate

21%

Some
College

61%

Bachelor's/Grad/Prof
Degree

INCOME



\$65,298
Per Capita
Income



\$117,670
Median
Household
Income



\$155,296
Average
Household
Income

EMPLOYMENT



79.3
White
Collar %



8.5
Blue
Collar %



12.2
Services
%

equity | brokerage

The information contained herein has been obtained from the property owner or other sources that we deem reliable. Although we have no reason to doubt its accuracy, no representation or warranty is made regarding the information, and the property is offered "as is." The submission may be modified or withdrawn at any time by the property owner.

3-MILE RADIUS DEMOS

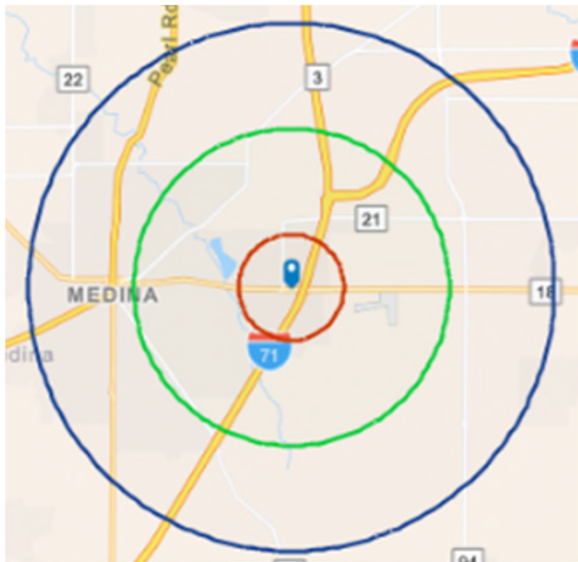

KEY FACTS

19,889
Population

2.6
Average
Household Size

44.3
Median Age

\$116,967
Median Household Income

BUSINESS

882

Total Businesses

9,646

Total Employees

EDUCATION

2%

No High School
Diploma

20%

High School
Graduate

23%

Some
College

55%

Bachelor's/Grad/Prof
Degree

INCOME



\$60,061
Per Capita
Income



\$116,967
Median
Household
Income



\$155,740
Average
Household
Income

EMPLOYMENT

77.5
White
Collar %

12.6
Blue
Collar %

9.9
Services
%

equity | brokerage

The information contained herein has been obtained from the property owner or other sources that we deem reliable. Although we have no reason to doubt its accuracy, no representation or warranty is made regarding the information, and the property is offered "as is." The submission may be modified or withdrawn at any time by the property owner.

5-MILE RADIUS DEMOS

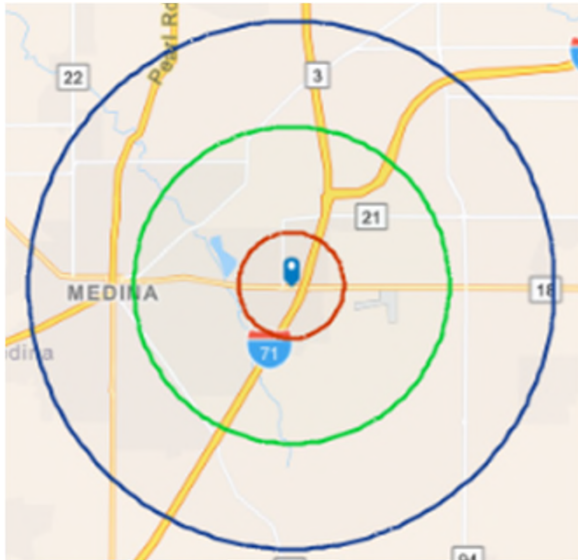

KEY FACTS

55,044
Population

2.5
Average
Household Size

43.5
Median Age

\$103,870
Median Household Income

BUSINESS

2,435

Total Businesses

27,435

Total Employees

EDUCATION

3%
No High School
Diploma

24%
High School
Graduate

26%
Some
College

47%
Bachelor's/Grad/Prof
Degree

INCOME

\$54,018
Per Capita
Income

\$103,870
Median
Household
Income

\$135,576
Average
Household
Income

EMPLOYMENT

72.1
White
Collar %

15.6
Blue
Collar %

12.3
Services
%

equity | brokerage

The information contained herein has been obtained from the property owner or other sources that we deem reliable. Although we have no reason to doubt its accuracy, no representation or warranty is made regarding the information, and the property is offered "as is." The submission may be modified or withdrawn at any time by the property owner.