

FOR LEASE

24,188 S.F. Industrial Building (Divisible to 17,396 S.F.)



DORIN REALTY
COMPANY, INC.



1247-1249 East 58th Place, Los Angeles, CA 90001

Great Building for Distribution or Manufacturing

- Three (3) Dock High Loading Positions
- Grade Level Access via Ramps
- 400 Amp, 240 Volt, 3 Phase Electrical - Well Distributed
- Fenced Parking Lot for 24 Cars
- Sprinklers, Foil Insulation
- 3,000 S.F. Bonus Storage Mezzanine, Not Included in Square Footage
- 3,200 S. F. Office Area and Ample Restrooms
- Unincorporated Los Angeles Location with Good Proximity to I-110 Freeway and Metro Blue Line



DORIN REALTY
COMPANY, INC.

Contact exclusive agent:

Mark Whitman

mwhitman@dorinrealty.com

213-627-0007 Ext 124

4555 Pacific Blvd., Vernon, CA 90058-2207

Industrial and Commercial Real Estate Specialists

Since 1959

www.dorinrealty.com

The information contained herein is from sources we believe to be reliable but, we do not guarantee its accuracy. All measurements & dimensions are approximations and are not to scale. Clients are encouraged to verify their accuracy.

1247-1249 East 58th Place, Los Angeles, CA 90001

E. Slauson Avenue

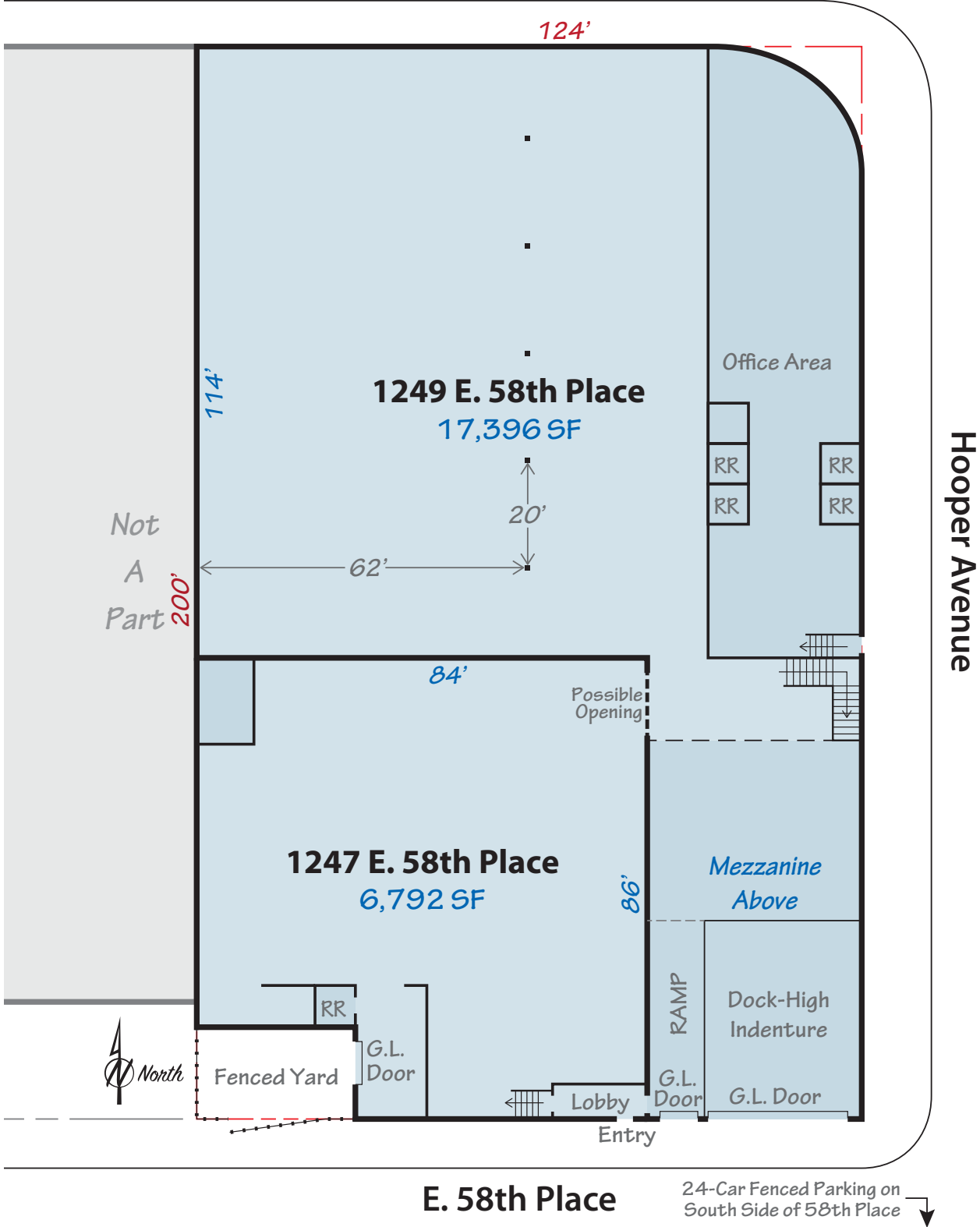

E. 58th Place

24-Car Fenced Parking on South Side of 58th Place



Contact exclusive agent:
Mark Whitman
mwhitman@dorinrealty.com
213-627-0007 Ext 124
4555 Pacific Blvd., Vernon, CA 90058-2207

Industrial and Commercial Real Estate Specialists
Since 1959
www.dorinrealty.com

The information contained herein is from sources we believe to be reliable but, we do not guarantee its accuracy. All measurements & dimensions are approximations and are not to scale. Clients are encouraged to verify their accuracy.



Contact exclusive agent:
Mark Whitman
mwhitman@dorinrealty.com
213-627-0007 Ext 124

www.dorinrealty.com

The information contained herein is from sources we believe to be reliable but, we do not guarantee its accuracy. All measurements & dimensions are approximations and are not to scale. Clients are encouraged to verify their accuracy.