

FOR SALE

0.4 - 1.7 AC LOTS

Sermon Rd | Mobile, AL



Pete Riehm, SIOR
251.442.4349 | priehm@cre-mobile.com





PROPERTY DESCRIPTION



SIZE

7 lots ranging from 0.4 AC - 1.7 AC



IDEAL LOCATION

Proximity to I-10, with over 70,000 cars per day



READY LOTS

Industrial zoned lots, cleared and level with all utilities available.



SALE PRICE

\$130,000 - \$450,000 (see page 4)

LOCATION ADVANTAGES



Central Location

Located right off Highway 90 From Exit 15 on I-10.



Proximity to Major Roads

Lighted access onto Highway 90 from Sermon Road.

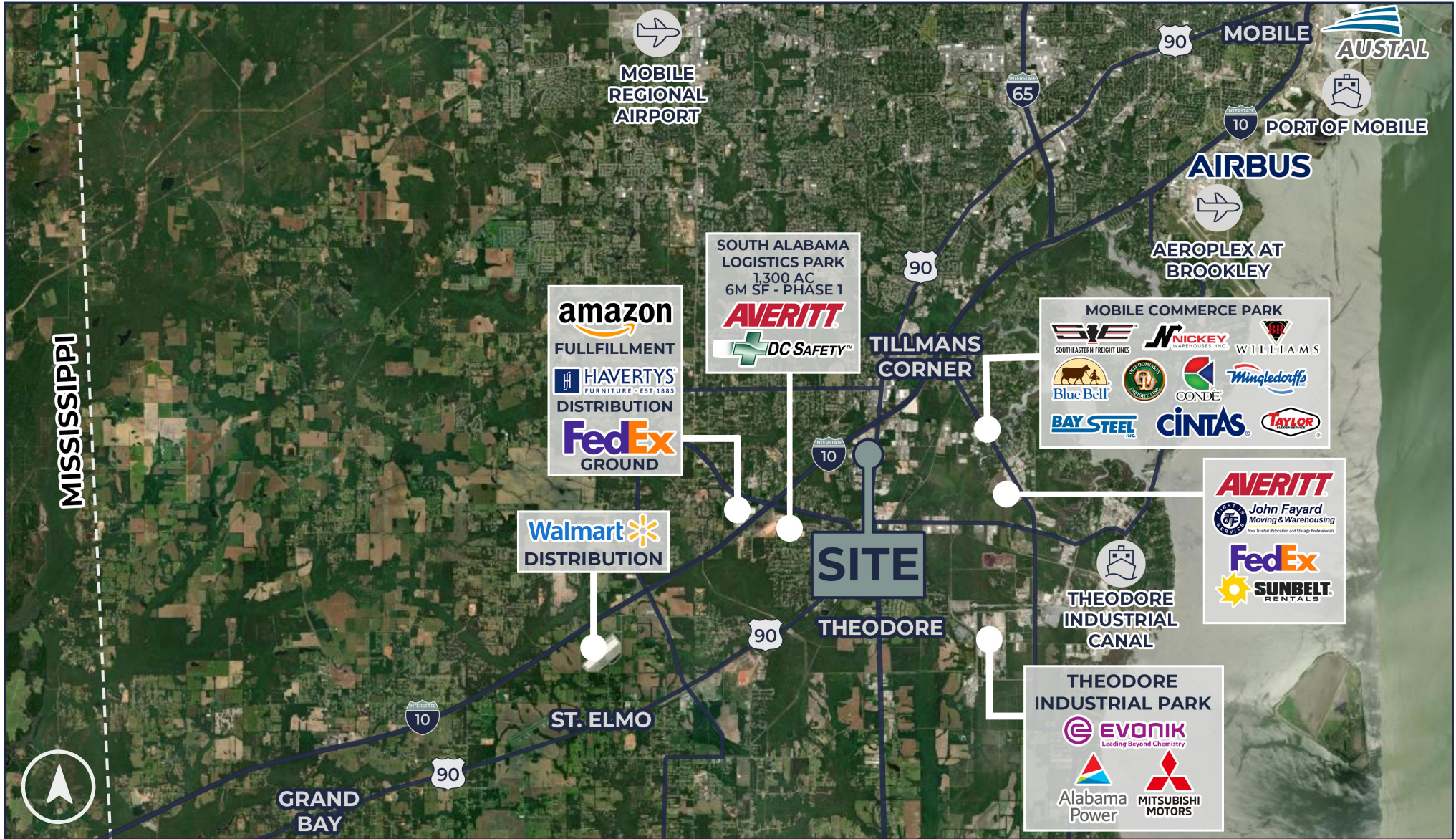

CLICK TO VIEW ON
GOOGLE EARTH

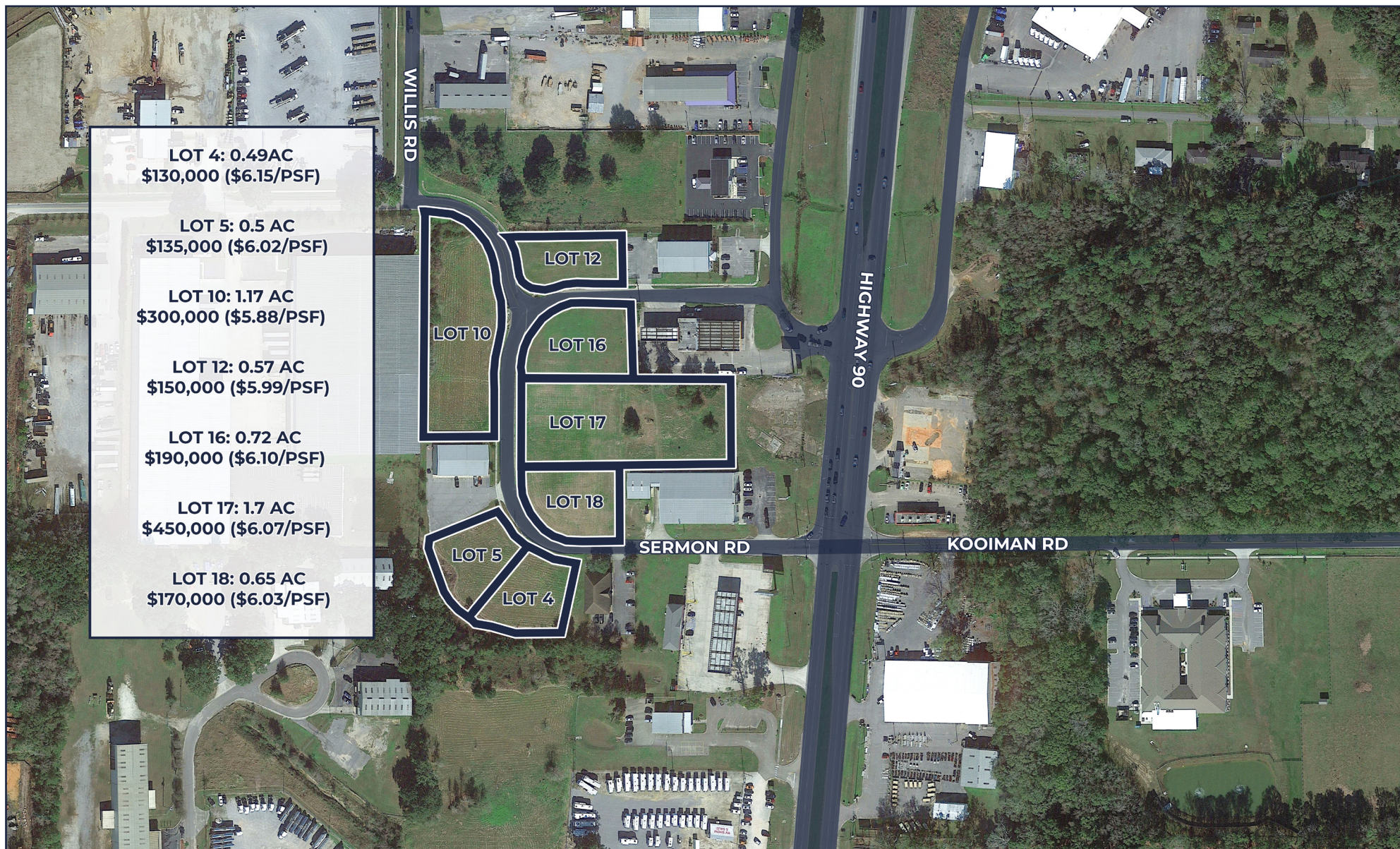

NO WARRANTY OR REPRESENTATION, EXPRESS OR IMPLIED, IS MADE AS TO THE ACCURACY OF THE INFORMATION CONTAINED HEREIN, AND THE SAME IS SUBMITTED SUBJECT TO ERRORS, OMISSIONS, CHANGE OF PRICE, RENTAL OR OTHER CONDITIONS, PRIOR SALE, LEASE OR FINANCING, OR WITHDRAWAL WITHOUT NOTICE, AND OF ANY SPECIAL LISTING CONDITIONS IMPOSED BY OUR PRINCIPALS. NO WARRANTIES OR REPRESENTATIONS ARE MADE AS TO THE CONDITION OF THE PROPERTY NOR ANY HAZARDS CONTAINED THEREIN ARE ANY TO BE IMPLIED.