

ALL PARTITIONS TO BE TYPE **A** UNLESS SPECIFICALLY NOTED OTHERWISE.

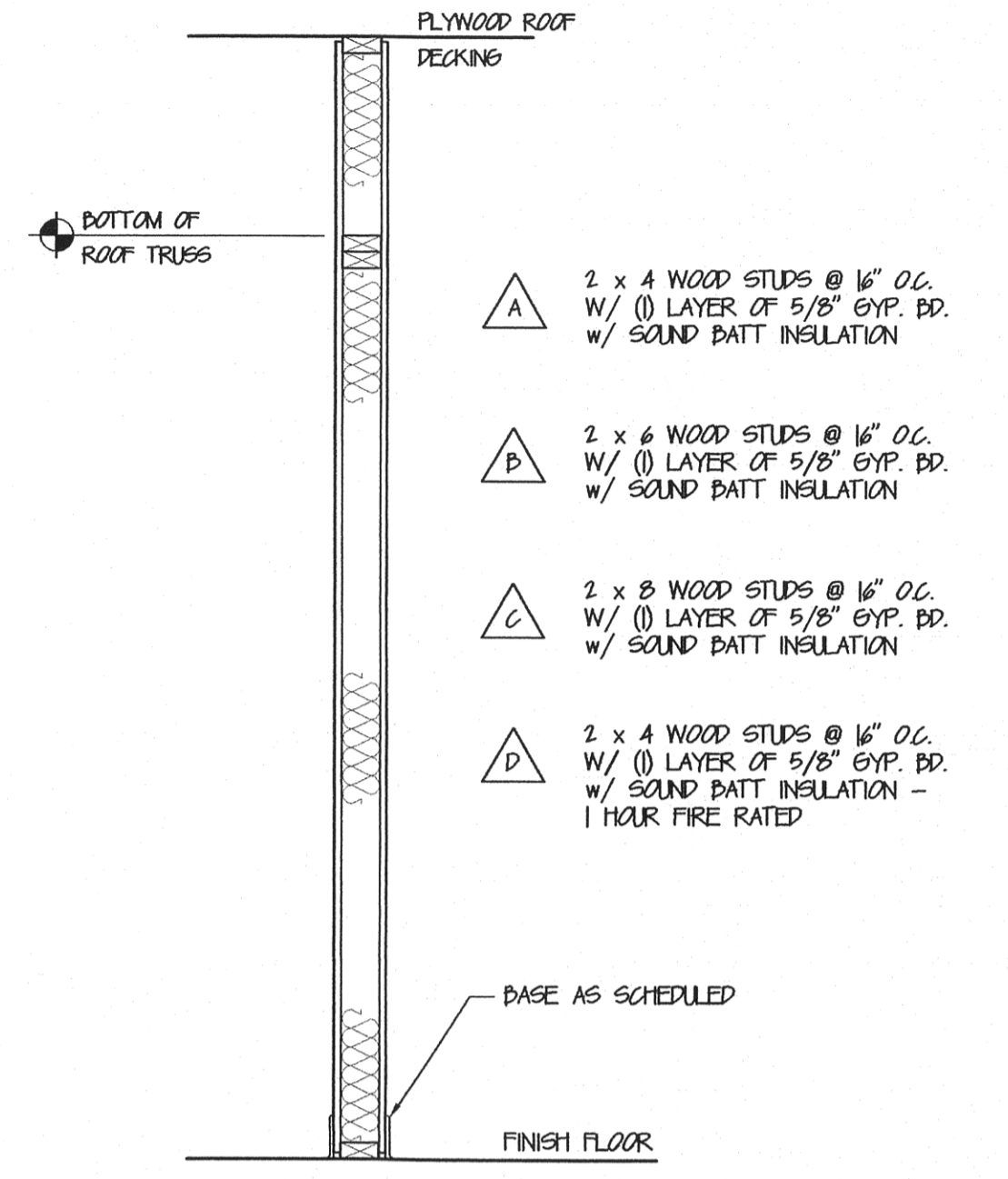

2 PARTITION TYPES

- A** 2 x 4 WOOD STUDS @ 16" O.C. W/ (1) LAYER OF 5/8" EYP. PD. W/ SOUND BATT INSULATION
- B** 2 x 6 WOOD STUDS @ 16" O.C. W/ (1) LAYER OF 5/8" EYP. PD. W/ SOUND BATT INSULATION
- C** 2 x 8 WOOD STUDS @ 16" O.C. W/ (1) LAYER OF 5/8" EYP. PD. W/ SOUND BATT INSULATION
- D** 2 x 4 WOOD STUDS @ 16" O.C. W/ (1) LAYER OF 5/8" EYP. PD. W/ SOUND BATT INSULATION - 1 HOUR FIRE RATED

2 A2.1 NT'S PARTITION TYPES

1 FLOOR PLAN
A2.1 1/4"=1'-0"
NOT PLANNED

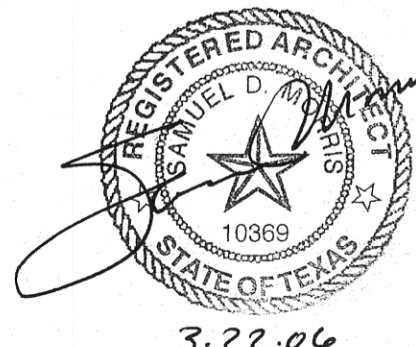

RICHTER ARCHITECTS
201 SOUTH UPPER BROADWAY CORPUS CHRISTI, TX 78401, 361-882-1288 / FAX 361-882-1388
FOOD BANK OF CORPUS CHRISTI
New Administration Offices
826 Krill Street
CORPUS CHRISTI, TEXAS
FLOOR PLAN

PROJECT # 20513.00
SCALE: 1/4"=1'-0"
DATE: 3-22-06

A2.1