

# FASHION BOULEVARD OFFICE SPACE FOR LEASE

6095 SOUTH FASHION BLVD., MURRAY, UTAH 84107



## PROPERTY INFORMATION

- ✓ Newly Remodeled Office Available
- ✓ Suite 135: 766 RSF
- ✓ Suite 140: 800 RSF
- ✓ Suite 150: 3,425 RSF
- ✓ Suite 135/140: 1,566 RSF Total
- ✓ Excellent Location Adjacent to Fashion Place
- ✓ Mall and Many Other Amenities
- ✓ Close Proximity to Tosh Medical Center
- ✓ Ample Parking: 4-1,000 SF Low Load Factor
- ✓ Easy Access to 1-215 and 1-15

## TRAVEL TIMES

INTERMOUNTAIN MEDICAL CENTER/IMC	<b>3 MINS</b>
SALT LAKE INTERNATIONAL AIRPORT	<b>15 MINS</b>
DOWNTOWN SALT LAKE	<b>15 MINS</b>
SILICONE SLOPES	<b>20 MINS</b>
UNIVERSITY OF UTAH	<b>20 MINS</b>
PARK CITY	<b>40 MINS</b>
6 SKI RESORTS	<b>30 MINS</b>
15 GOLF COURSES	<b>15 MINS</b>

**LEASE RATE : \$19.75/SF YEAR FULL SERVICE**

## CONTACT US

**KELLEN KONCAR**

✉ kellen@cresutah.com 📞 801.824.1311

**COLTER SMITH**

✉ colter@cresutah.com 📞 801.755.8794 🌐 www.cresutah.com

Call Us  
**801.876.6070** 📞



# FASHION BOULEVARD OFFICE SPACE FOR LEASE

6095 SOUTH FASHION BLVD., MURRAY, UTAH 84107

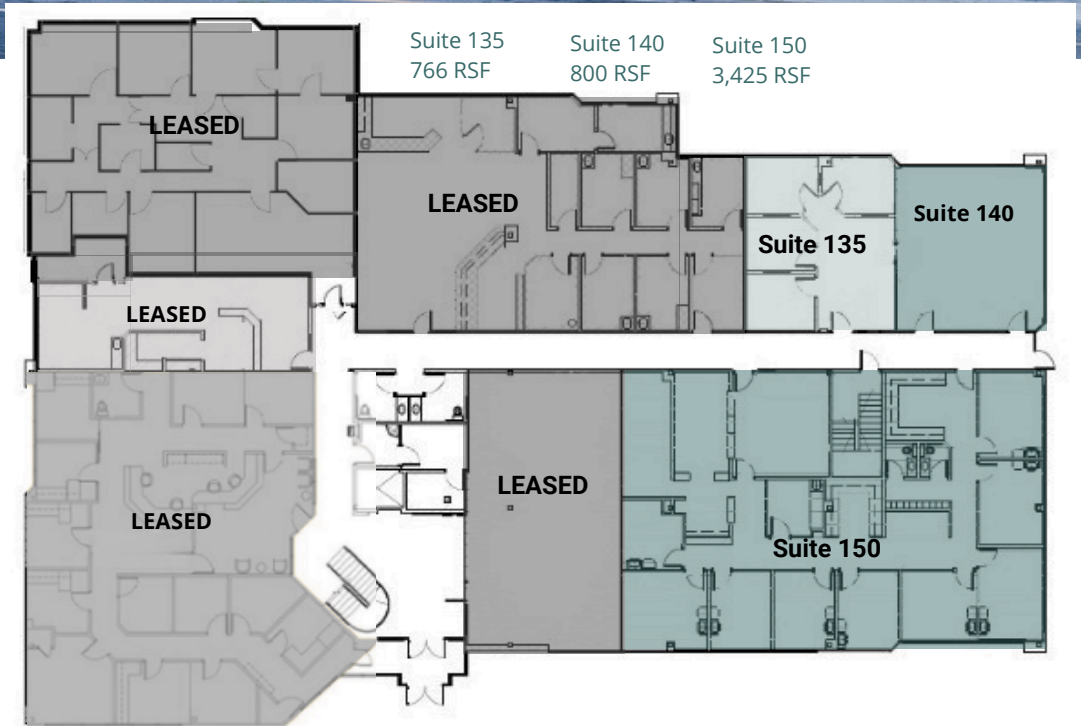

This information is given with the understanding that all negotiations and/or real estate activity related to the property described above shall be conducted through this CRE Specialists office. The above information while not guaranteed, was obtained from sources we believe to be reliable.

## CONTACT US

**KELLEN KONCAR**

✉ kellen@cresutah.com 📞 801.824.1311

**COLTER SMITH**

✉ colter@cresutah.com 📞 801.755.8794 🌐 www.cresutah.com

Call Us  
**801.876.6070** 📞