

# Honey Creek Village

## Food Depot Anchored Center

Three Spaces Available - 1,000 SF; 1,000 SF; & 1,500 SF



**3500 Highway 20, Conyers, GA 30013**

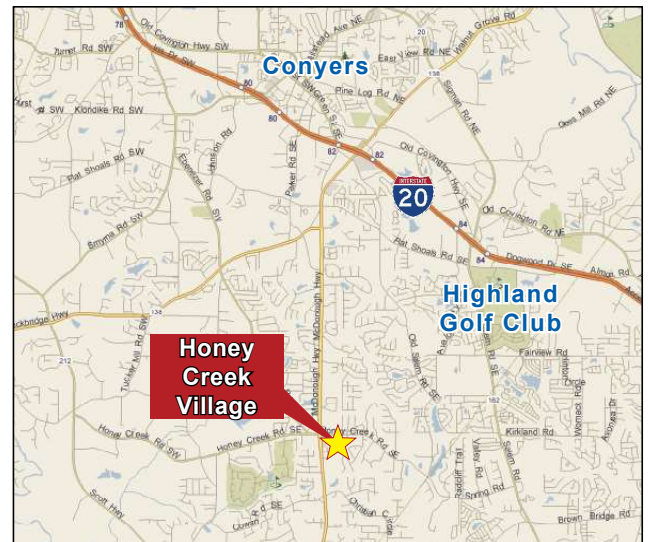

**FOR LEASE**

- One (1) 1,500 SF and two (2) 1,000 SF spaces available
- Honey Creek Village is a busy shopping center with almost 10,000 vehicles passing by daily
- Just a few miles south of Interstate 20
- Mix of national and local tenants
- Average household income of almost \$100,000 in a 2 mile radius

### Demographics

	2-Mile Radius	5-Mile Radius	10-Mile Radius
Total Population 2020	17,429	86,076	222,178
Annual Growth 2010-2020	1.0%	1.0%	1.0%
Projected Growth 2020-2025	0.8%	0.9%	1.0%
Total Households 2020	6,161	30,340	77,941
Average Household Income	\$97,232	\$82,120	\$80,095
Bachelor's Degree or Above	28%	29%	26%

### Traffic Count

**9,984** Honey Creek Road

### FOR MORE INFORMATION, CONTACT:

Adam Hale  
404.281.2788 Cell  
678.894.1580 Direct  
ahale@haleretailgroup.com

1303 Hightower Trail, Suite 201  
Atlanta, Georgia 30350  
www.haleretailgroup.com  
770.594.1309 Office



# LEASE AT Honey Creek Village

3500 Highway 20, Conyers, GA 30013

SUITE	TENANT	SF	SUITE	TENANT	SF
1043	Van's Nails II	1,250	3504	Pizza Hut	1,500
<b>1041</b>	<b>VACANT</b>	<b>1,000</b>	3510	Custom Shirts & Signs	2,100
1039	Electronics Repair	1,000	3520	Beauty Supply	2,100
<b>1037</b>	<b>VACANT</b>	<b>1,000</b>	3530	Food Depot	42,256
1035	Allstate	1,000	3540	Yummy House Chinese	1,500
1033	Honey Creek Wings	1,000	3540 A	Rolling Rock Vapor	1,500
1031	Hair Studio	1,250	3550	Sports Massage	1,800
1029	Pharmacy	2,108	3560	Los Charros	9,000
			3570	Just Smoke Shop	1,500
			<b>3574</b>	<b>VACANT</b>	<b>1,500</b>
			3580	Rite Aid	1,500

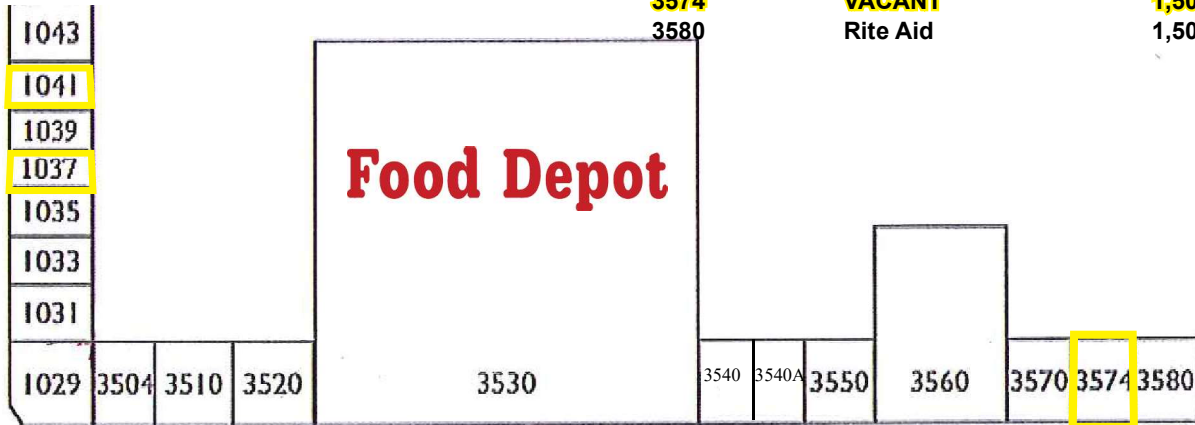

**75,864 Total SF**



**FOR MORE INFORMATION, CONTACT:**

Adam Hale	1303 Hightower Trail, Suite 201
404.281.2788 Cell	Atlanta, Georgia 30350
678.894.1580 Direct	<a href="http://www.haleretailgroup.com">www.haleretailgroup.com</a>
<a href="mailto:ahale@haleretailgroup.com">ahale@haleretailgroup.com</a>	770.594.1309 Office



The information herein was obtained from sources deemed reliable and, while believed correct, is offered subject to errors, price changes, and prior sale or withdrawal without notice.