

# NEW LEASE OPPORTUNITY EUREKA LEISURE

## FORMER CHIQUITOS—A3 RESTAURANT OPPORTUNITY

Split Unit 5, Eureka Leisure Park, Ashford, TN25 4BN



### KEY HIGHLIGHTS

- Prominently located just off Junction 9 of the M20 and less than 1km from the A292
- Arranged over ground floor
- Adjacent to Cineworld (planning received for extension), Nando's, McDonalds, Premier Inn and Travelodge
- Potential to split the unit.

The restaurant is arranged over ground floor and split into the following floor area:

Unit A	UNDER OFFER	
Unit B	260 sq m	2,800 sq ft

### SAVILLS LONDON

33 Margaret Street  
W1G 0JD

[savills.co.uk](https://www.savills.co.uk)

savills



## Location

The Eureka Leisure Centre is located in Ashford, Kent. It is located just off Junction 9 of the M20 and less than 1km from the A292. It is located 1km from Ashford International Railway Station. The area is also well served by a number of buses. Other occupiers in the park include; **Cineworld, Nandos, Pizza Hut, KFC, Burger King and McDonald's.**

## Use Class

A3 (other uses considered, subject to planning).

## Rent

Upon Application.

## Tenure

A new lease for a term to be agreed.

## Legal Costs

Each party to be responsible for their own legal and professional costs incurred in this transaction.

## Viewing & Further Information

Appointments to view should be made strictly by appointment.

## CONTACT

**Carlene Hughes**

CHughes@savills.com

020 7409 8177

## IMPORTANT NOTICE

Maps are reproduced from the Ordnance Survey Map with the permission of the Controller of H.M. Stationery Office. © Crown copyright licence number 100022432 Savills (UK) Ltd, published for the purposes of identification only and although believed to be correct accuracy is not guaranteed.

Savills, their clients and any joint agents give notice that: 1. They are not authorised to make or give any representations or warranties in relation to the property either here or elsewhere, either on their own behalf or on behalf of their client or otherwise. They assume no responsibility for any statement that may be made in these particulars. These particulars do not form part of

any offer or contract and must not be relied upon as statements or representations of fact. 2. Any areas, measurements or distances are approximate. The text, photographs and plans are for guidance only and are not necessarily comprehensive. It should not be assumed that the property has all necessary planning, building regulation or other consents and Savills have not tested any services, equipment or facilities. Purchasers must satisfy themselves by inspection or otherwise.

**savills**

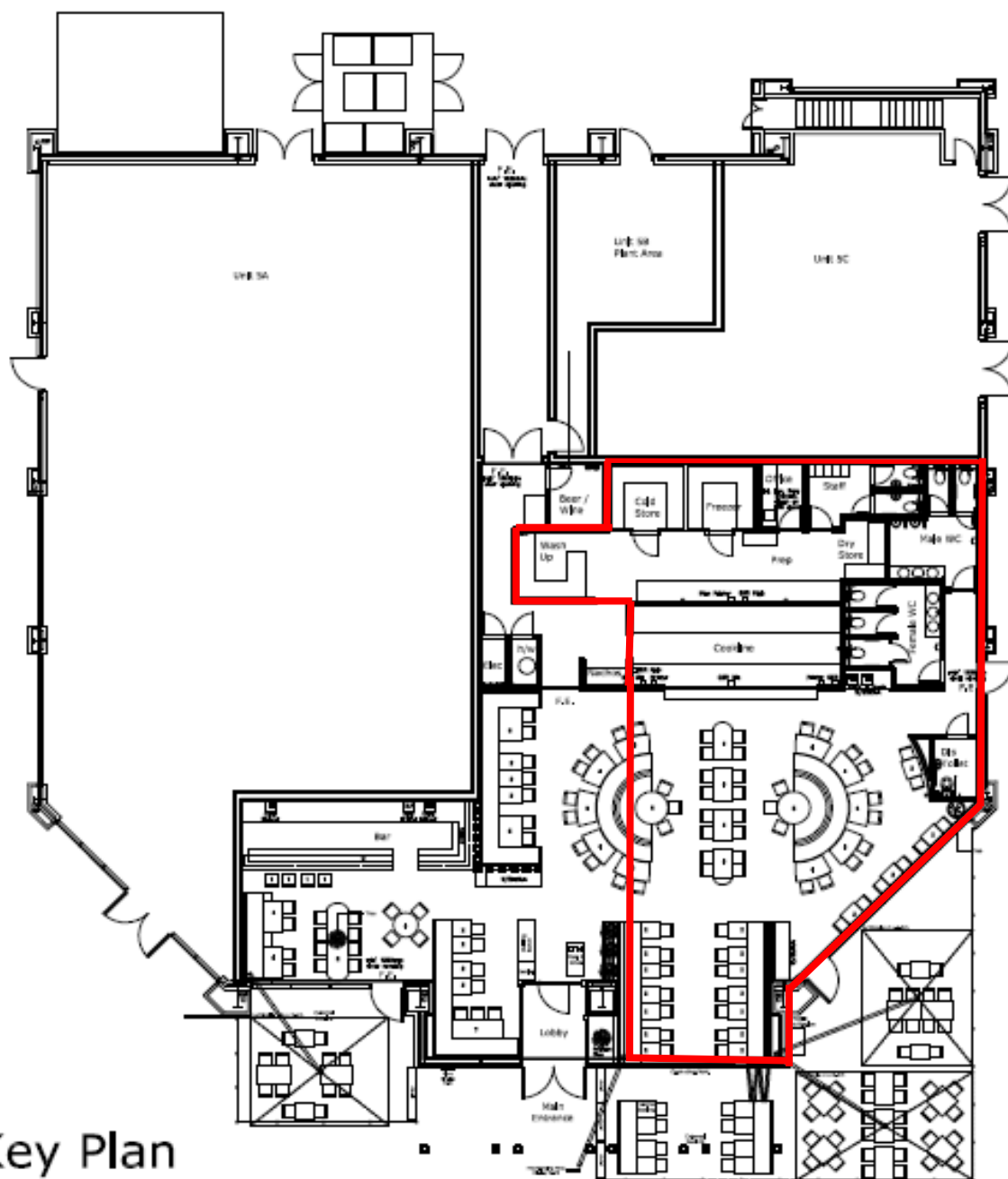

**Key Plan**  
Scale 1:250 @ A1

## CONTACT

**Carlene Hughes**

CHughes@savills.com

020 7409 8177

## IMPORTANT NOTICE

Maps are reproduced from the Ordnance Survey Map with the permission of the Controller of H.M. Stationery Office. © Crown copyright licence number 100022432 Savills (UK) Ltd, published for the purposes of identification only and although believed to be correct accuracy is not guaranteed.

Savills, their clients and any joint agents give notice that: 1. They are not authorised to make or give any representations or warranties in relation to the property either here or elsewhere, either on their own behalf or on behalf of their client or otherwise. They assume no responsibility for any statement that may be made in these particulars. These particulars do not form part of

any offer or contract and must not be relied upon as statements or representations of fact. 2. Any areas, measurements or distances are approximate. The text, photographs and plans are for guidance only and are not necessarily comprehensive. It should not be assumed that the property has all necessary planning, building regulation or other consents and Savills have not tested any services, equipment or facilities. Purchasers must satisfy themselves by inspection or otherwise.

**savills**