

- Legend:
- IP Found
  - Set 1/2" Rebar w/cap
  - ⊗ Utility Pole
  - D Deeded
  - M Measured
  - Concrete Monument
  - ◇ Reservation Monument



**Notes:**  
 This survey was prepared for a transfer of title of lands. This map of survey dated January 12, 2022, was prepared from an instrument survey, with field work completed on January 11, 2022.

It is a violation of New York State Education Law for any person, unless acting under the direction of a licensed surveyor, to alter an item in any way.

Only copies of this survey marked with an original signature and an original embossed or ink seal are the product of the land surveyor.

This survey was prepared for the parties and purpose indicated hereon. Any extension of the use beyond the purpose agreed to, exceeds the scope of the engagement.

This survey was prepared without the benefit of an up to date abstract of title and is subject to any state of facts revealed by an examination of such.

This plan NOT valid with an Affidavit of No Change.

Distances are Deeded and Measured unless otherwise indicated.

Map symbols are not to scale.

Only visible utility services and/or encumbrances were located and shown.

Remove not the ancient landmark, which thy fathers have set. Prov. 22:28  
 Cursed be he that removeth his neighbor's landmark. And the people shall say Amen. Deuteronomy 27:17

Survey by William J Tucker, II PLS #050369  
 Clear Creek Land Surveying, L.L.C.  
 7449 Mill Street, Canaan, N.Y. 14717  
 Phone 716-592-5800 Fax 716-592-5566

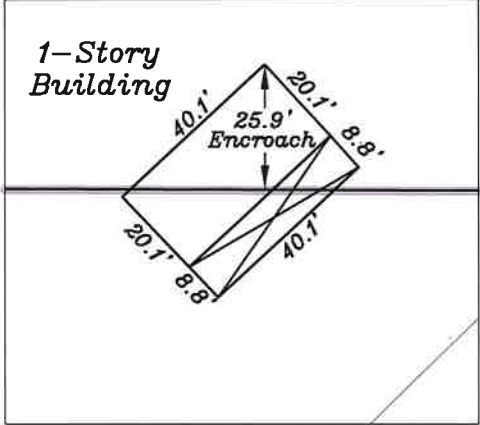

Detail Scale: 1"=40'

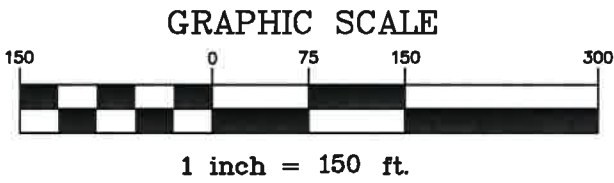

**Boundary Survey of**  
**Lands Off Southwestern Boulevard**  
**Part of Lot 78 T8 R9 HLC**  
**Town of Brant**  
**Erie County, New York**  
 Survey by William J Tucker II PLS #050369 dated January 12, 2022  
 Job No. 21-093 Field Bk LL