

For Lease

8475 Pacheco Road
Bakersfield, CA



Scott Wells

Senior Vice President | Principal

License# 01126196

+1 661 631 3822

scott.wells@colliers.com

10000 Stockdale Hwy, Suite 102

Bakersfield, CA 93311

P: +1 661 631 3800

F: +1 661 631 3829

Colliers

— Accelerating success. —



Property Overview

- Lease Rate: \$5,500/mo. NNN
- Showroom: +/- 2,978 SF
- Warehouse: +/- 3,022 SF
- Land Size: +/- 26,571 SF

Highlights

- Excellent Southwest Bakersfield Location
- Metal frame construction
- Clear Height: 16' Min - 18' Max
- Finished showroom
- Free span
- One (1) 12' x 14' drive-in door
- Zoning: M-2PD
- Fenced yard area
- Large yard and parking area
- Monument signage available
- Excellent access to major transit corridor on Gosford Road
- Adjacent to new Wal-Mart Supercenter

8475 Pacheco Road is a 6,000 square foot office warehouse building, located in the Stockdale Industrial Park, just south of White Lane in Southwest Bakersfield. Located approximately 1 mile west of Highway 99.

colliers.com/bakersfield



Scott Wells

Senior Vice President | Principal
License # 01126196
+1 661 631 3822
scott.wells@colliers.com

Colliers International

Central California
License # 0452468
10000 Stockdale Hwy, Suite 102
Bakersfield, CA 93311

Site & Floor Plan

Site Plan

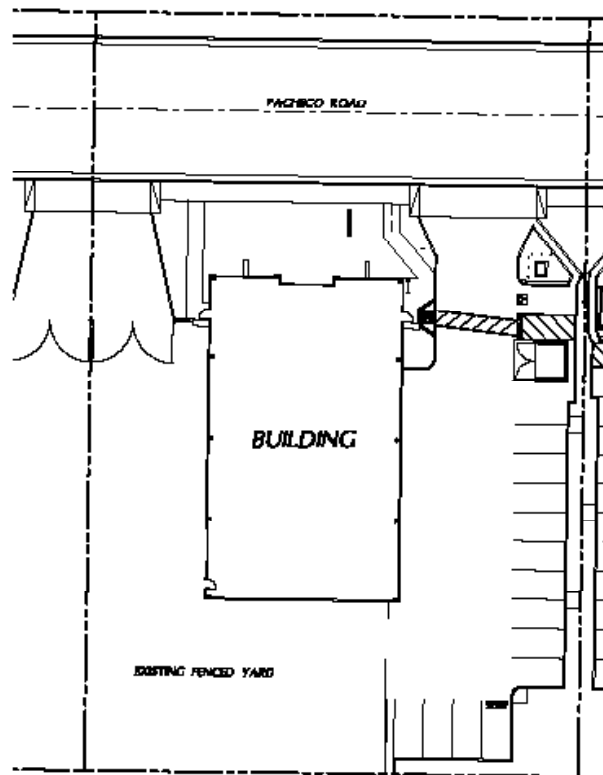

Floor Plan

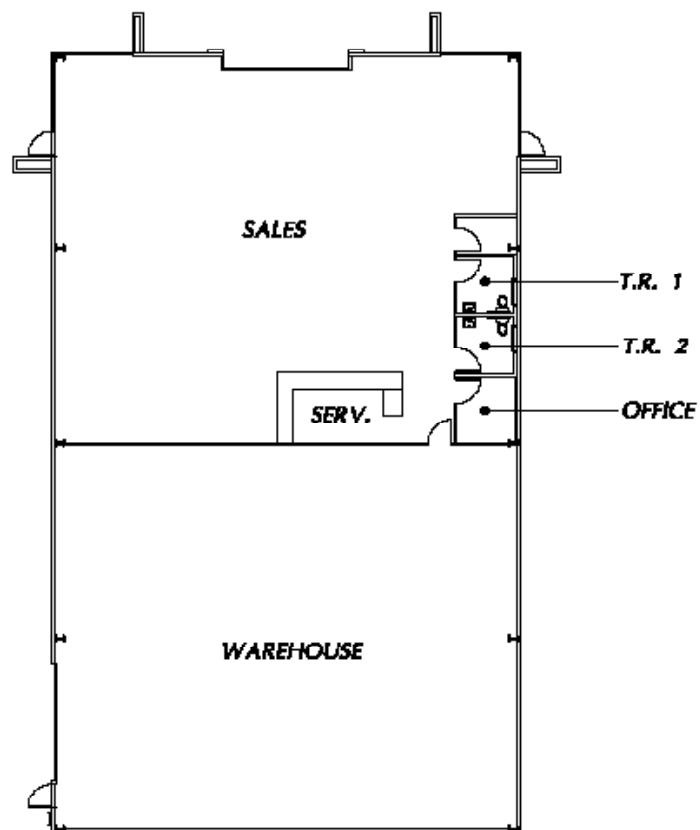

Aerial Map

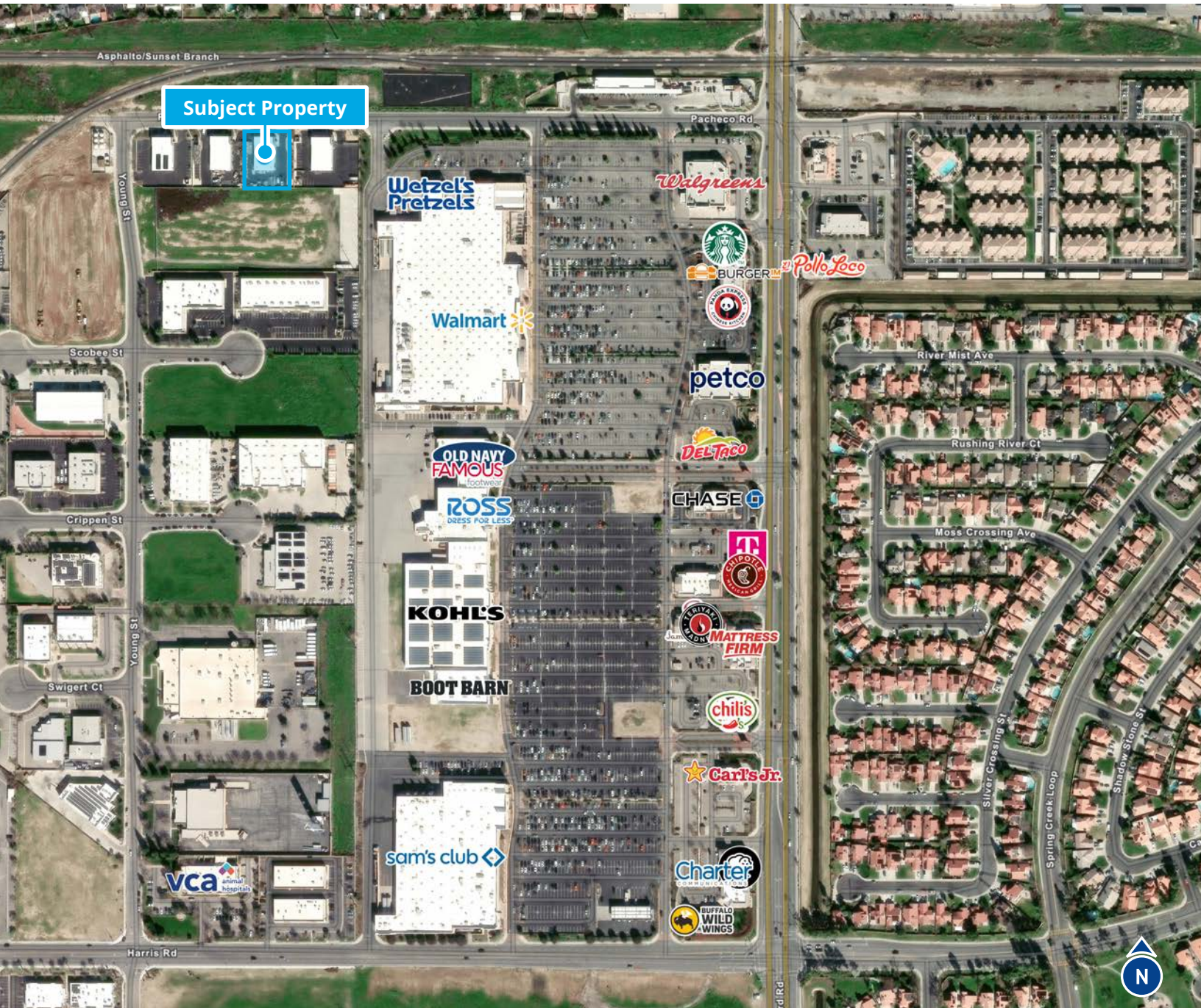

This document has been prepared by Colliers International for advertising and general information only. Colliers International makes no guarantees, representations or warranties of any kind, expressed or implied, regarding the information including, but not limited to, warranties of content, accuracy and reliability. Any interested party should undertake their own inquiries as to the accuracy of the information. Colliers International excludes unequivocally all inferred or implied terms, conditions and warranties arising out of this document and excludes all liability for loss and damages arising there from. This publication is the copyrighted property of Colliers International and/or its licensor(s). ©2026. All rights reserved.