

WASTEWATER SYSTEM AND POTABLE WATER SUPPLY PERMIT**LAWS/REGULATIONS INVOLVED**10 V.S.A. Chapter 64, Potable Water Supply and Wastewater System Permit
Wastewater System and Potable Water Supply Rules, Effective April 12, 2019**Landowner: Matt Martelle**
127 VT Route 15
Jericho VT 05465**Permit Number: WW-4-2512-3**

This permit affects the following properties in the Town of Jericho, Vermont:

<i>Lot</i>	<i>Parcel</i>	<i>SPAN</i>	<i>Acres</i>	<i>Book/Page#’s</i>
<i>127</i>	<i>VT 127</i>	<i>333-103-12184</i>	<i>1.00</i>	<i>Book:151 Page:201</i>

This project, consisting of the addition of 2 employees to an existing car wash business on an existing, 1.00 acre parcel utilizing an existing, municipal water service and existing, on-site wastewater disposal system, located at 127 VT Route 15 in the Town of Jericho, Vermont, is hereby approved under the requirements of the regulations named above subject to the following conditions.

1. GENERAL

- 1.1 The project shall be completed as shown on the plans and/or documents prepared by O’Leary – Burke Civil Associates, PLC (Paul J. O’Leary, Jr. P.E.), with the stamped plans listed as follows:

<i>Title</i>	<i>Plan Sheet #</i>	<i>Plan Date</i>	<i>Revision Date</i>
<i>Site Plan</i>	<i>1</i>	<i>2-01-12</i>	<i>8-8-19</i>
<i>Details</i>	<i>3</i>	<i>2-01-12</i>	<i>7-25-19</i>

- 1.2 This permit does not relieve the landowner from obtaining all other approvals and permits PRIOR to construction including, but not limited to, those that may be required from the Act 250 Environmental Commission; the Drinking Water and Groundwater Protection Division; the Watershed Management Division; the Division of Fire Safety; the Vermont Department of Health; the Family Services Division; or other State departments and local officials.
- 1.3 The conditions of this permit shall run with the land and will be binding upon and enforceable against the landowner and all assigns and successors in interest. The landowner shall record and index this permit in the Town of Jericho Land Records within thirty, (30) days of issuance of this permit and prior to the conveyance of any lot subject to the jurisdiction of this permit.
- 1.4 The landowner shall record and index all required installation certifications and other documents that are required to be filed under these Rules or under a specific permit condition in the Town of Jericho Land Records and ensure that copies of all certifications are sent to the Secretary.
- 1.5 The project/lot is approved for with the existing car wash facility. No alterations to the existing building that would change or affect the water supply or wastewater system shall be allowed without prior approval by the Drinking Water and Groundwater Protection Division. Construction of additional nonexempt buildings including commercial and residential buildings is not allowed without prior permitting by the Drinking Water and Groundwater Protection Division and such permit may not be granted unless the proposal conforms to the applicable laws and regulations. No construction is allowed that will cause non-compliance with an existing permit.
- 1.6 Each purchaser of any portion of the project shall be shown a copy of the Wastewater System and Potable Water Supply Permit and the stamped plan(s), if applicable, prior to conveyance of any portion of the project to that purchaser.



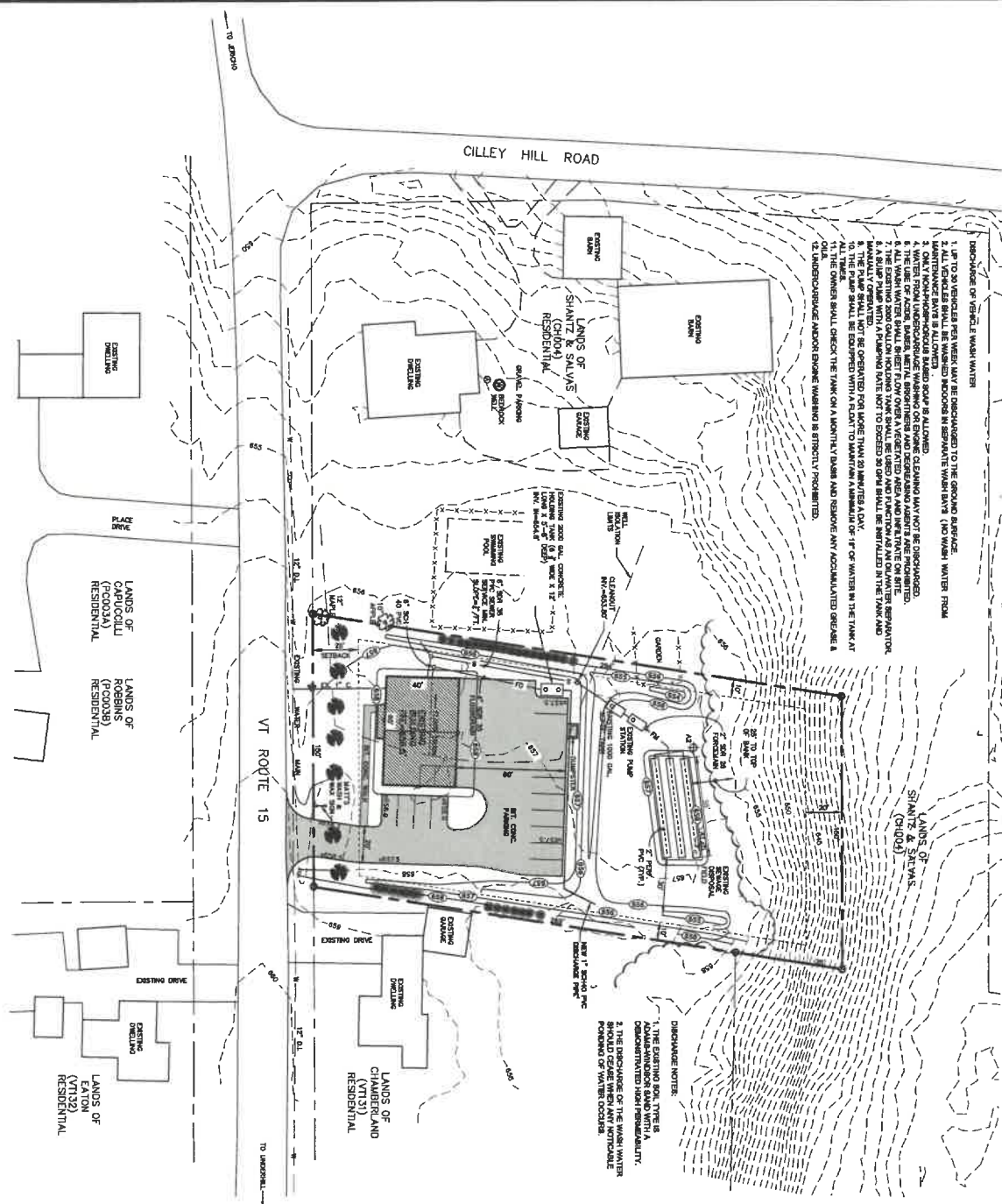

- DISCHARGE OF VEHICLE WASH WATER
1. UP TO 20 VEHICLES PER WEEK MAY BE DISCHARGED TO THE GROUND SURFACE.
 2. ALL VEHICLES SHALL BE WASHED INDOORS IN SEPARATE WASH BAYS (NO WASH WATER FROM EXTERIOR).
 3. ONLY NON-HYDROCARBON BASED SOAP IS ALLOWED.
 4. WATER FROM UNDERGROUND WASHING OR ENGINE CLEANING MAY NOT BE DISCHARGED.
 5. WASH WATER SHALL BE COLLECTED IN A HOLDING TANK AND PUMPED TO THE DISCHARGE AREA.
 6. ALL WASH WATER SHALL BE FLOW OVER A RECEPTED MEDIA AND FILTERED ON SITE.
 7. THE DISCHARGE SOIL COLUMN HOLDING TANK SHALL BE USED AND FUNCTION AS AN OIL/WATER SEPARATOR.
 8. THE HOLDING TANK SHALL NOT BE DESIGNED OR OPERATED TO BE FILLED BY THE TANK AND MANUALLY OPERATED.
 9. THE PUMP SHALL NOT BE OPERATED FOR MORE THAN 20 MINUTES A DAY.
 10. THE HOLDING TANK SHALL BE EQUIPPED WITH A FLOAT TO SHUT OFF A MINIMUM OF 1" OF WATER IN THE TANK AT ALL TIMES.
 11. THE OWNER SHALL CHECK THE TANK ON A MONTHLY BASIS AND REMOVE ANY ACCUMULATED DEBRIS.
 12. UNDERGROUND AND/OR ENGINE WASHING IS STRICTLY PROHIBITED.

DISCHARGE NOTES:
 1. THE EXISTING SOIL TYPE IS A QUARTZSAND WITH A SAND-TO-SILT RATIO OF 70/30.
 2. THE DISCHARGE OF THE WASH WATER FROM THE HOLDING TANK SHALL BE THROUGH THE MEDIA FILTER.

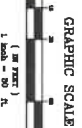

SOIL AUGER LOG

1'	1.0' LIGHT BROWN SANDY LOAM
2'	2.0' 2.0' FINE BROWN GRANULY SAND
3'	3.0' 3.0' COARSE BROWN GRANULY SAND
4'	4.0' 4.0' COARSE BROWN GRANULY SAND
5'	5.0' 5.0' COARSE BROWN GRANULY SAND
6'	6.0' 6.0' COARSE BROWN GRANULY SAND
7'	7.0' 7.0' COARSE BROWN GRANULY SAND
8'	8.0' 8.0' COARSE BROWN GRANULY SAND
9'	9.0' 9.0' COARSE BROWN GRANULY SAND
10'	10.0' 10.0' COARSE BROWN GRANULY SAND
11'	11.0' 11.0' COARSE BROWN GRANULY SAND
12'	12.0' 12.0' COARSE BROWN GRANULY SAND
13'	13.0' 13.0' COARSE BROWN GRANULY SAND
14'	14.0' 14.0' COARSE BROWN GRANULY SAND
15'	15.0' 15.0' COARSE BROWN GRANULY SAND
16'	16.0' 16.0' COARSE BROWN GRANULY SAND
17'	17.0' 17.0' COARSE BROWN GRANULY SAND
18'	18.0' 18.0' COARSE BROWN GRANULY SAND
19'	19.0' 19.0' COARSE BROWN GRANULY SAND
20'	20.0' 20.0' COARSE BROWN GRANULY SAND
21'	21.0' 21.0' COARSE BROWN GRANULY SAND
22'	22.0' 22.0' COARSE BROWN GRANULY SAND
23'	23.0' 23.0' COARSE BROWN GRANULY SAND
24'	24.0' 24.0' COARSE BROWN GRANULY SAND
25'	25.0' 25.0' COARSE BROWN GRANULY SAND
26'	26.0' 26.0' COARSE BROWN GRANULY SAND
27'	27.0' 27.0' COARSE BROWN GRANULY SAND
28'	28.0' 28.0' COARSE BROWN GRANULY SAND
29'	29.0' 29.0' COARSE BROWN GRANULY SAND
30'	30.0' 30.0' COARSE BROWN GRANULY SAND
31'	31.0' 31.0' COARSE BROWN GRANULY SAND
32'	32.0' 32.0' COARSE BROWN GRANULY SAND
33'	33.0' 33.0' COARSE BROWN GRANULY SAND
34'	34.0' 34.0' COARSE BROWN GRANULY SAND
35'	35.0' 35.0' COARSE BROWN GRANULY SAND
36'	36.0' 36.0' COARSE BROWN GRANULY SAND
37'	37.0' 37.0' COARSE BROWN GRANULY SAND
38'	38.0' 38.0' COARSE BROWN GRANULY SAND
39'	39.0' 39.0' COARSE BROWN GRANULY SAND
40'	40.0' 40.0' COARSE BROWN GRANULY SAND
41'	41.0' 41.0' COARSE BROWN GRANULY SAND
42'	42.0' 42.0' COARSE BROWN GRANULY SAND
43'	43.0' 43.0' COARSE BROWN GRANULY SAND
44'	44.0' 44.0' COARSE BROWN GRANULY SAND
45'	45.0' 45.0' COARSE BROWN GRANULY SAND
46'	46.0' 46.0' COARSE BROWN GRANULY SAND
47'	47.0' 47.0' COARSE BROWN GRANULY SAND
48'	48.0' 48.0' COARSE BROWN GRANULY SAND
49'	49.0' 49.0' COARSE BROWN GRANULY SAND
50'	50.0' 50.0' COARSE BROWN GRANULY SAND

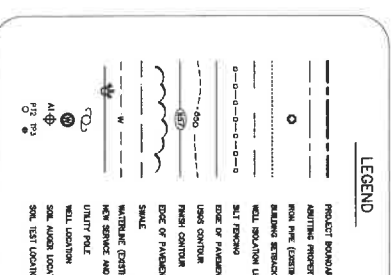

PROJECT STATISTICS

ZONING DISTRICT - VILLAGE CENTER (VC2R)	LOT 1 - PROPOSED
MINIMUM LOT SIZE - 0.25 ACRES (10,890 SF)	MINIMUM FRONTAGE - 75'
MINIMUM FRONT SETBACK - 25'	MINIMUM SIDE SETBACK - 10'
MINIMUM REAR SETBACK - 25'	MINIMUM REAR YARD SETBACK - 25'
MINIMUM FRONT YARD SETBACK - 25'	MINIMUM FRONT SETBACK - 25'
MINIMUM SIDE YARD SETBACK - 10'	MINIMUM SIDE SETBACK - 10'
MINIMUM REAR YARD SETBACK - 25'	MINIMUM REAR SETBACK - 25'
MAX. BUILDING HEIGHT - 40'	MAX. BUILDING HEIGHT - 40'
MAX. NUMBER OF STORIES - 3	MAX. NUMBER OF STORIES - 3
MAX. NUMBER OF UNITS - 4	MAX. NUMBER OF UNITS - 4
MAX. NUMBER OF SPACES - 8	MAX. NUMBER OF SPACES - 8
MAX. NUMBER OF SPACES / OVERLAPPING UNIT - 11	MAX. NUMBER OF SPACES / OVERLAPPING UNIT - 11

OWNER
 MATT MARTELE
 1227 VT ROUTE 15
 JERICHO, VT 05465

APPLICANT
 MATT MARTELE
 1227 VT ROUTE 15
 JERICHO, VT 05465

OTIARY-BURKE CIVIL ASSOCIATES, P.C.

Matt Wash & J
 1227 VT ROUTE 15, JERICHO
 WASH WATER DISCHARGE

SITE PLAN

- 1.6 This project is approved for the construction of two-two bedroom residential units and a vehicle detail shop with a maximum of two employees washing a maximum of four vehicles per day. Construction of additional nonexempt buildings, including commercial and residential buildings, is not allowed without prior review and approval by the Drinking Water and Groundwater Protection Division and such approval will not be granted unless the proposal conforms to the applicable laws and regulations. No construction is allowed that will cause non-compliance with an existing permit.
- 1.7 All conditions set forth in Permit Number #WW-4-2512 shall remain in effect except as amended or modified herein.
- 1.8 Each purchaser of any portion of the project shall be shown a copy of the Wastewater System and Potable Water Supply Permit and the stamped plans prior to conveyance of any portion of the project to that purchaser.
- 1.9 By acceptance of this permit, the landowner agrees to allow representatives of the State of Vermont access to the property covered by the permit, at reasonable times, for the purpose of ascertaining compliance with the Vermont environmental and health statutes and regulations, and permit conditions.
- 1.10 Any person aggrieved by this permit may appeal to the Environmental Court within 30 days of the date of issuance of this permit in accordance with 10 V.S.A. Chapter 220 and the Vermont Rules of Environmental Court Proceedings.

2. WATER SUPPLY

- 2.1 This project is approved for connection to the municipal water supply system as depicted on the plans stamped by the Drinking Water and Groundwater Protection Division. The project is approved for a maximum of 690 gallons of water per day (including 60 gallons per day for the car wash).
- 2.2 The components of the potable water supply herein approved shall be routinely and reliably inspected during construction by a qualified Vermont Licensed Designer (or where allowed, the installer) who shall, upon completion and prior to occupancy of the associated building, report in writing to the Drinking Water and Groundwater Protection Division that the installation was accomplished in accordance with the referenced plans and permit conditions, as specifically directed in Condition #1.5 herein.
- 2.3 This permit is based, in part, on a municipal approval for connection to their water distribution system. If the municipal approval expires, this permit shall be invalid unless the municipality renews its approval. If the municipality approval expires, a new permit must be issued for the project. An updated application form and an application fee will be required for the project. A new municipal approval letter shall be required. The rules in effect at the time of the filing of the application for a new permit will be applied to the project.

3. WASTEWATER DISPOSAL

- 3.1 This project is approved for the disposal of sanitary wastewater in accordance with the design depicted on the stamped plans for a maximum of 590 gallons of wastewater per day and sized for 150 percent of the daily design flow. The system shall be operated at all times in a manner that will not permit the discharge of effluent onto the surface of the ground or into the waters of the State. Should the system fail and not qualify for the minor repair or replacement exemption, the current landowner shall engage a qualified Vermont Licensed Designer to evaluate the cause of the failure and to submit an application to this office and receive written approval prior to correcting the failure.
- 3.2 The components of the sanitary wastewater system herein approved shall be routinely and reliably inspected during construction by a Vermont Licensed Designer who shall, upon completion and prior to occupancy of the associated building, report in writing to the Drinking Water and Groundwater Protection Division that the installation was accomplished in accordance with the referenced plans and permit conditions, as specifically directed in Condition #1.5 herein.
- 3.3 The corners of the proposed primary sanitary wastewater disposal area shall be accurately staked out and flagged prior to construction with the flagging/staking being maintained until construction is complete.
- 3.4 This project is approved for the disposal of process wastewater from vehicle washing for a maximum of 60 gallons per day into a floor drain discharging to an exterior holding tank, complete with audio and visual alarms, as depicted on the plans stamped by the Drinking Water and Groundwater Protection Division. All exterior portions of the floor drain and holding tank shall be installed as shown on the stamped plans. There shall be no onsite discharge from the floor drain and holding tank. The contents of the holding tank shall be pumped and transported by a certified waste hauler to an approved wastewater treatment facility. If the waste in the holding tank meets the criteria of a hazardous waste, a permit from the state Hazardous Waste Management Program may be required and the waste shall be handled as required for hazardous waste. For information about the

- requirements for the storage, transport and disposal of hazardous waste, please contact the Waste Management Division.
- 3.5 Annually, on or before December 1st, the current landowner shall submit a report to the Drinking Water and Groundwater Protection Division showing the date(s) the holding tank was pumped, the amount quantity of wastewater pumped, the name of the hauler and the name of the treatment facility accepting the waste.
- 3.6 The floor drain must be registered with the Underground Injection Control program of the Department of Environmental Conservation.
- 3.7 Record drawings and the required certification language shall be submitted to the Division where changes are allowed under Section 1-911 of the Wastewater System and Potable Water Supply Rules. The certification shall include the wastewater collection, delivery and holding tank serving the structure. The wastewater holding tank shall be hydrostatically or vacuum tested for water tightness under the direction of a Class 1 Licensed Designer. The results of the leakage test and a description of the test method used shall be specifically addressed and included in the designer's Installation Certification. Compliance with this condition is required prior to occupancy of the structure served by the disposal system.
- 3.8 The wastewater holding tank system herein approved shall be operated and maintained at all times in a manner that will not permit the discharge of tank process wastewater onto the ground surface or into the waters of the State.
- 3.9 No buildings, roads, water lines, earthwork, re-grading, excavation or other construction that might interfere with the installation or operation of the wastewater disposal system are allowed on or near the site-specific wastewater disposal system depicted on the stamped plans. All isolation distances that are set forth in the Wastewater System and Potable Water Supply Rules shall be adhered to and will be incorporated into the construction and installation of the wastewater disposal field.

David K. Mears, Commissioner
Department of Environmental Conservation

By Dolores M Eckert
Dolores M. Eckert, Assistant Regional Engineer
Dated September 6, 2012

cc Jericho Planning Commission
Paul O'Leary
Matt Martelle
Drinking Water and Groundwater Protection Division (UIC)
Department of Public Safety, Division of Fire Safety