



# Industrial Space For Sublease

## Greg Evans

Vice President  
+1 408 507 1787  
greg.evans@colliers.com  
CA Lic. 01956927

---

225 W Santa Clara St  
10<sup>th</sup> Floor, Suite 1000  
San Jose, CA 95113  
P: +1 408 282 3800  
F: +1 408 282 3855  
[colliers.com/siliconvalley](http://colliers.com/siliconvalley)

## Montague East Business Park

### 1013 Pecten Court, Milpitas

- **±1,680 SF**
- 20% Office, Balance Warehouse
- 1 Grade Level Door
- Fully Fire Sprinklered
- 100 Amps, 120/208 Volts
- Available with 30 Days Notice
- Lease expires 9/30/25
- Direct Deal Possible
- Asking \$1.65/SF Gross + \$0.26/SF CAM

# Floor Plan

1013 Pecten Court, Milpitas  
**±1,680 SF**

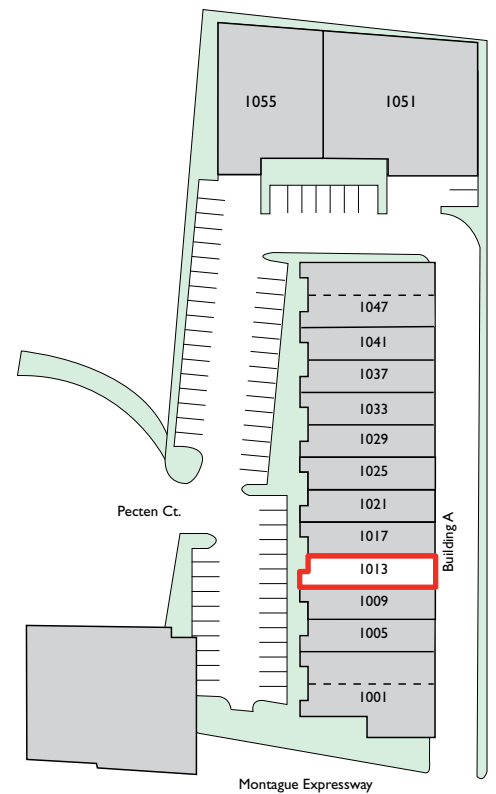
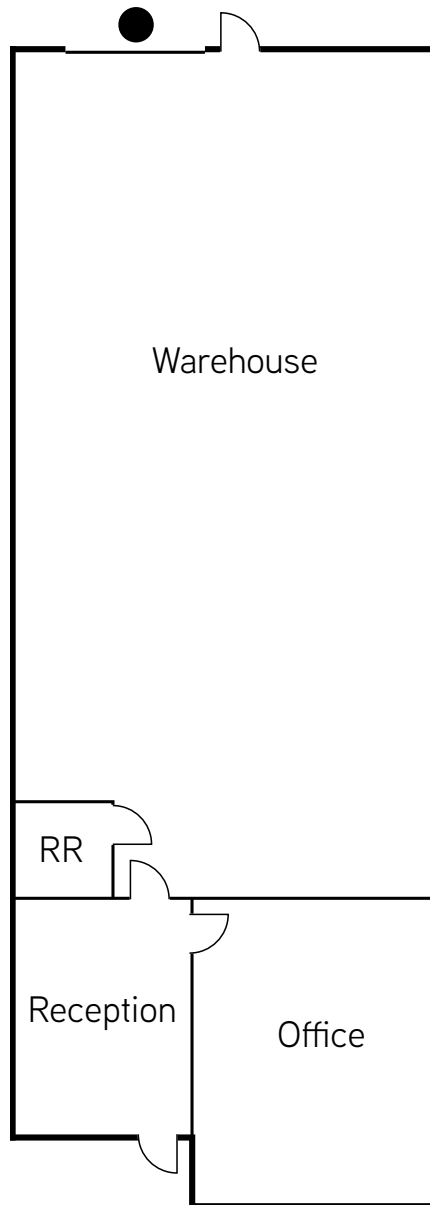

- ☐ = Available
- ☒ = GL Door
- ☐ = Leased
- = Lockbox

## Contact us:

### Greg Evans

Vice President  
+1 408 507 1787  
greg.evans@colliers.com  
CA Lic. 01956927

## Colliers

225 W Santa Clara St  
10<sup>th</sup> Floor, Suite 1000  
San Jose, CA 95113  
P: +1 408 282 3800  
F: +1 408 282 3855



# Location Map

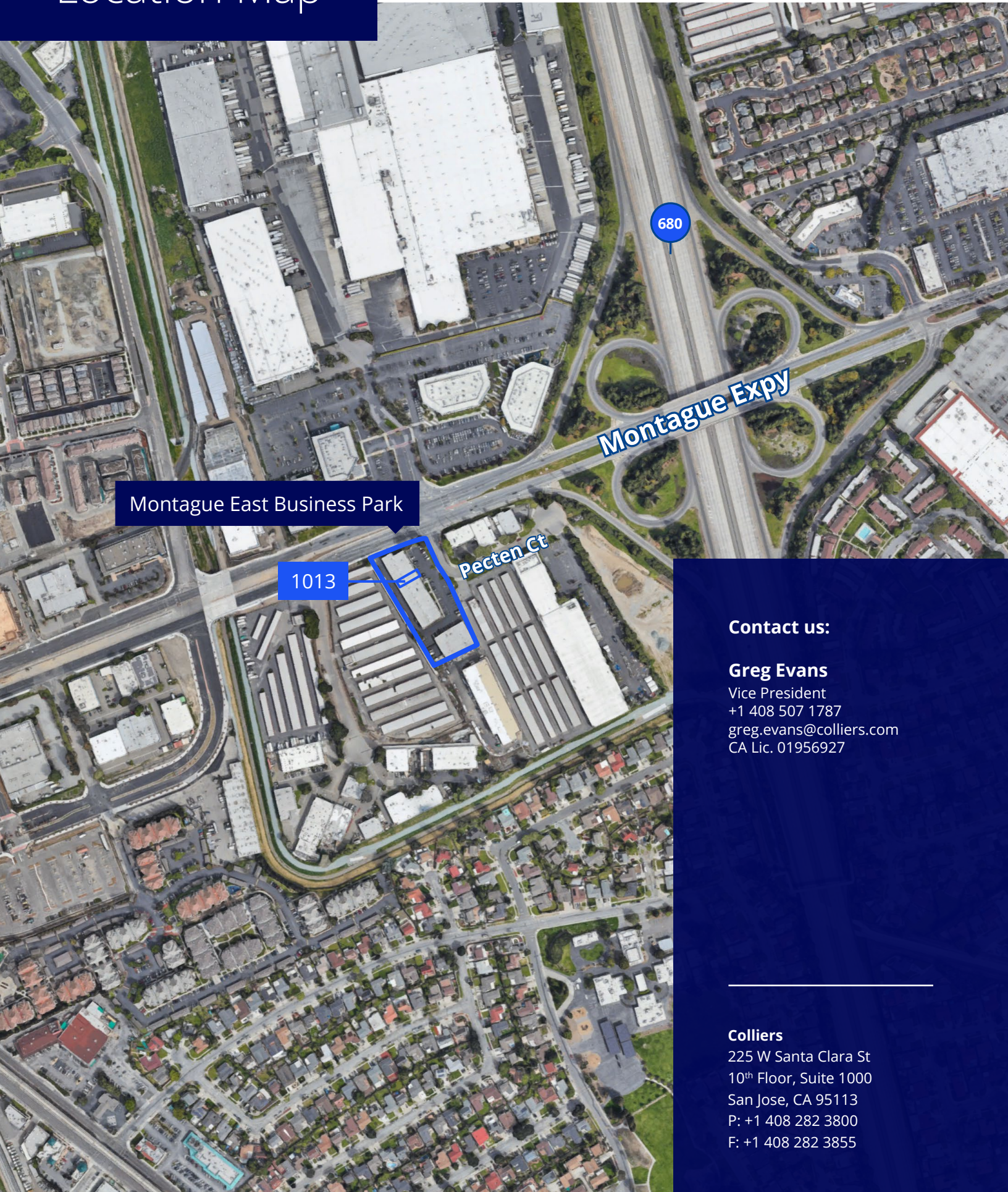

Montague East Business Park

1013

Pecten Ct

## Contact us:

### Greg Evans

Vice President  
+1 408 507 1787  
greg.evans@colliers.com  
CA Lic. 01956927

---

### Colliers

225 W Santa Clara St  
10<sup>th</sup> Floor, Suite 1000  
San Jose, CA 95113  
P: +1 408 282 3800  
F: +1 408 282 3855



# Amenities Map

## McCarthy Ranch Marketplace



## Great Mall



## Montague East Business Park

## North Park Plaza



## Brokaw Commons



## Sprout @ Brokaw



## Milpitas Square



## River Oaks



## Contact us:

### Greg Evans

Vice President  
+1 408 507 1787  
greg.evans@colliers.com  
CA Lic. 01956927

### Colliers

225 W Santa Clara St  
10<sup>th</sup> Floor, Suite 1000  
San Jose, CA 95113  
P: +1 408 282 3800  
F: +1 408 282 3855