



**MEDICAL ASSET
MANAGEMENT**
MEDICAL PROPERTY SPECIALISTS



8327 Reseda Blvd. | Northridge, CA
Surgery Center/Medical Suite For Lease

Available Suites	Rentable SF	Rental Rate
Ground Floor	9,700 RSF*	\$2.50 MG
*Divisible Space		

Features

- Move-In Ready Equipped Surgery Center
- Recently Renovated
- Building Signage Available
- Abundant Free Parking
- Adjacent to Dignity Health Northridge Hospital
- Medical Center

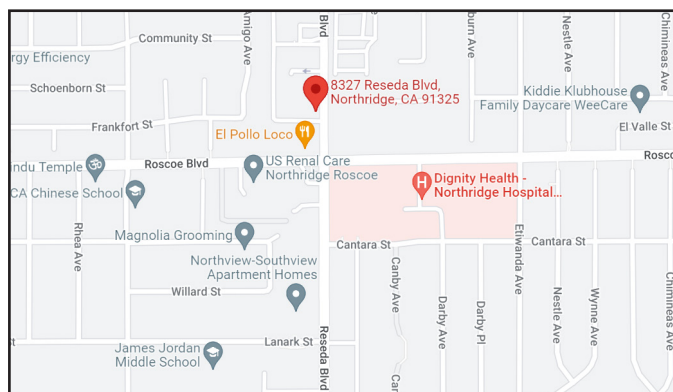

Contact

Brock Burnett
(818) 990-5200 x102
brockb@medicalasset.com
DRE#: 01814211

Mitch Yankowitz
(310) 517-4861
mitchy@medicalasset.com
DRE#: 01360137

www.medicalasset.com

South Bay
201 Continental Blvd., Ste. 210
El Segundo, CA 90245

Downtown Los Angeles
1400 S. Grand Ave., Ste. 808
Los Angeles, CA 90015

San Fernando Valley
5411 Eriwanda Ave., Ste. 208
Tarzana, CA 91356

Long Beach
1040 Elm Ave., Ste. 308
Long Beach, CA 90813



MEDICAL ASSET
MANAGEMENT
MEDICAL PROPERTY SPECIALISTS

8327 Reseda Blvd. | Floor Plans

1st Floor

9,700 sq. ft.

Surgical Center Space

- 4 Operating Rooms (OR.)
- 1 Business Office
- Reception and Lobby
- Pre-Op Space
- Recovery Room
- Staff Lounge
- Officer and Doctor Offices
- Procedure Room
- Sterilization Room

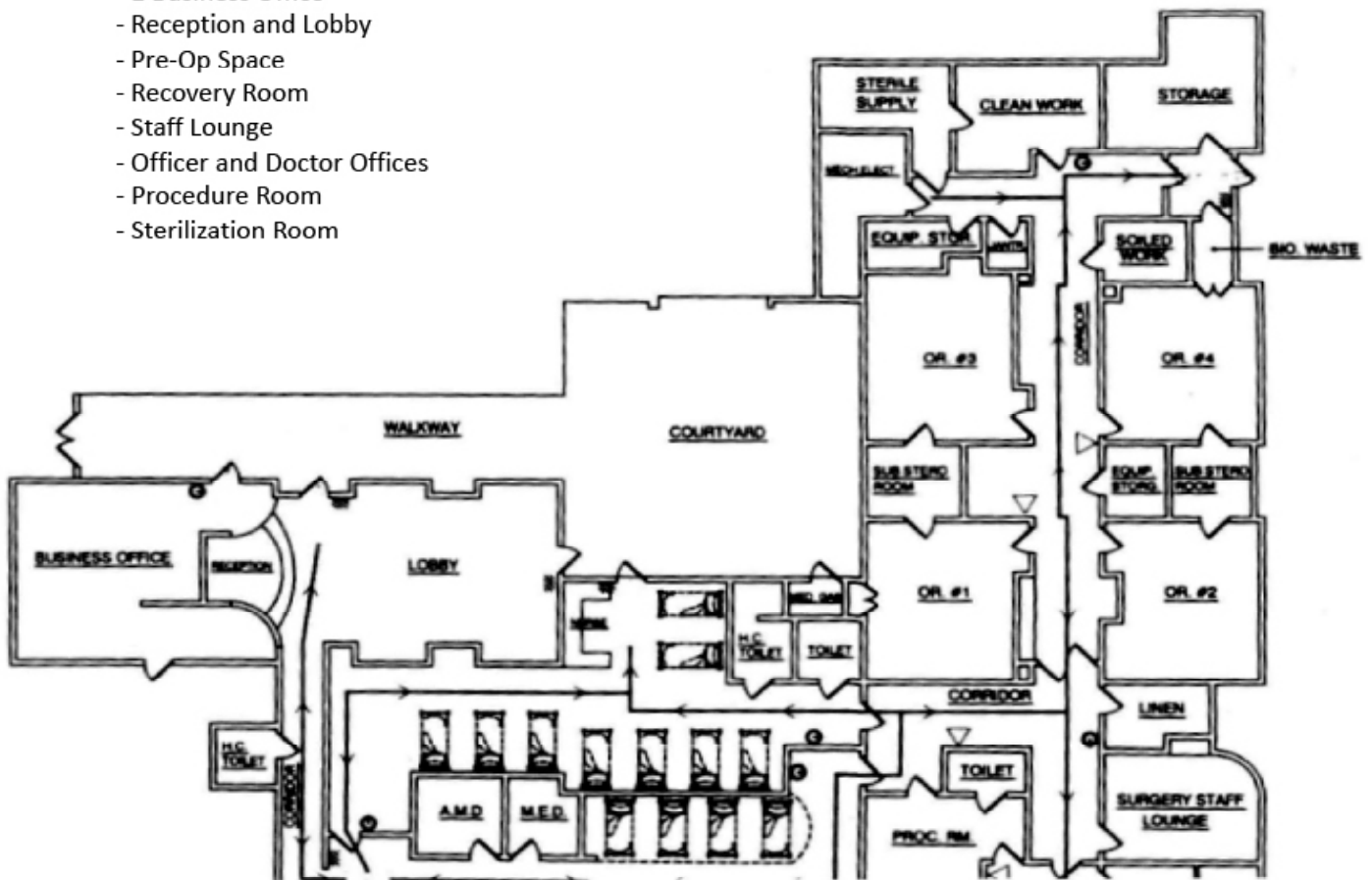



**MEDICAL ASSET
MANAGEMENT**
MEDICAL PROPERTY SPECIALISTS

Recovery Room



Reception

Pre Op



The information contained herein is deemed reliable, but cannot be guaranteed by Medical Asset Management and is subject to change.



**MEDICAL ASSET
MANAGEMENT**
MEDICAL PROPERTY SPECIALISTS

Staff Lounge



OR 2

OR 4



The information contained herein is deemed reliable, but cannot be guaranteed by Medical Asset Management and is subject to change.