

# FOR LEASE

**INSITE**  
81,385 SQUARE FEET

## LOCKWOOD DISTRIBUTION CENTER



### 1040 LOCKWOOD DRIVE • SUITE B HOUSTON, TX

- 81,385 SF Total
- +/- 2,100 SF Office
- Dock High, front loading (14 docks, 1 ramp)
- 18' Clear height
- Fully Sprinklered
- 205' Gated truck court
- Convenient access to I-10, 610 Loop, Highway 59, and Highway 45



## CONTACT INFORMATION

**STEVE HAZEL**  
shazel@insiterealty.com  
713.339.5317

**DAYNE WUNDERLICH**  
dwunderlich@insiterealty.com  
713.339.5329

# FOR LEASE

1040 LOCKWOOD DRIVE • SUITE B  
HOUSTON, TEXAS

**INSITE**  
81,385 SQUARE FEET

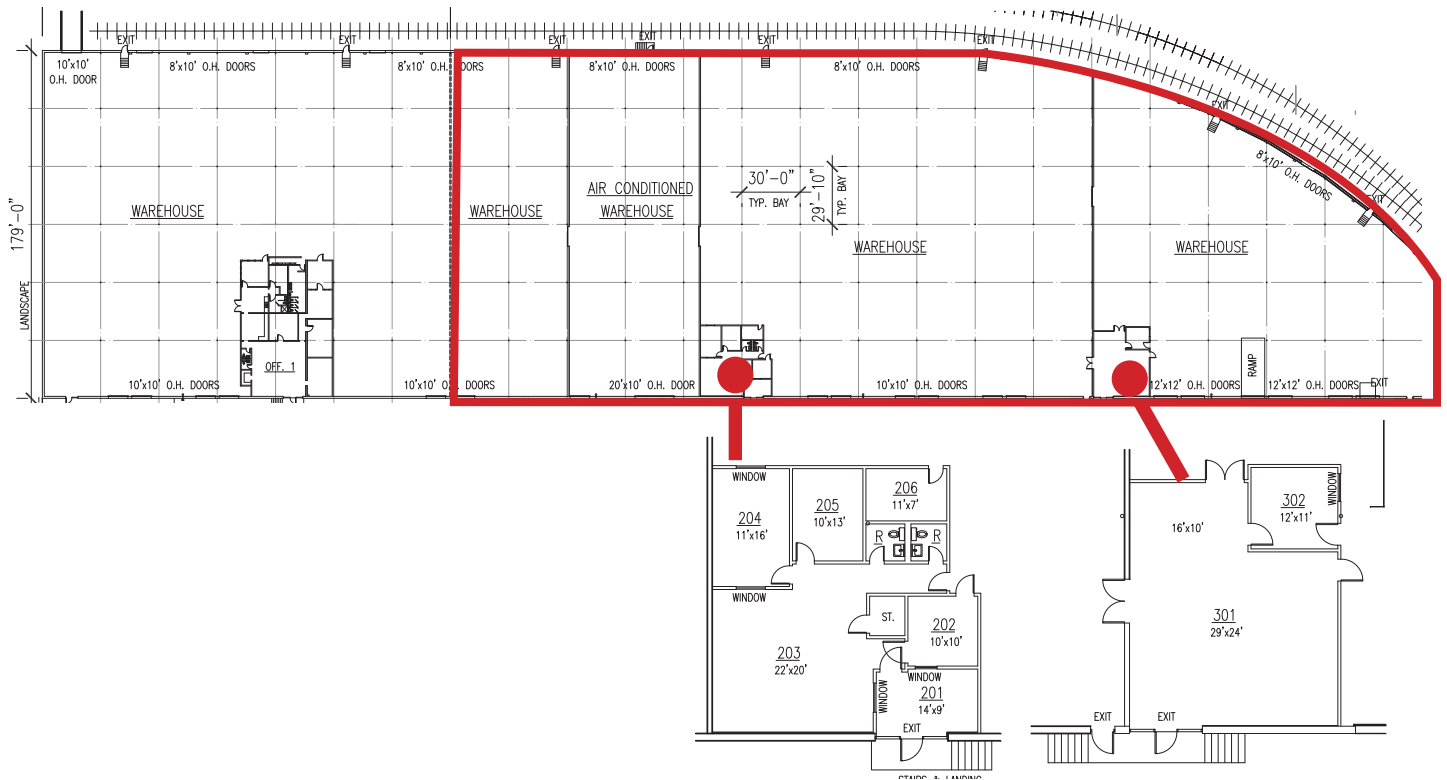

## CONTACT INFORMATION

**STEVE HAZEL**  
shazel@insiterealty.com  
713.339.5317

**DAYNE WUNDERLICH**  
dwunderlich@insiterealty.com  
713.339.5329



# FOR LEASE

1040 LOCKWOOD DRIVE • SUITE B  
HOUSTON, TEXAS

INSITE

81,385 SQUARE FEET

- 14 MINUTES PORT OF HOUSTON
- 24 MINUTES BUSH IAH
- 19 MINUTES HOBBY AIRPORT
- 10 MINUTES DOWNTOWN

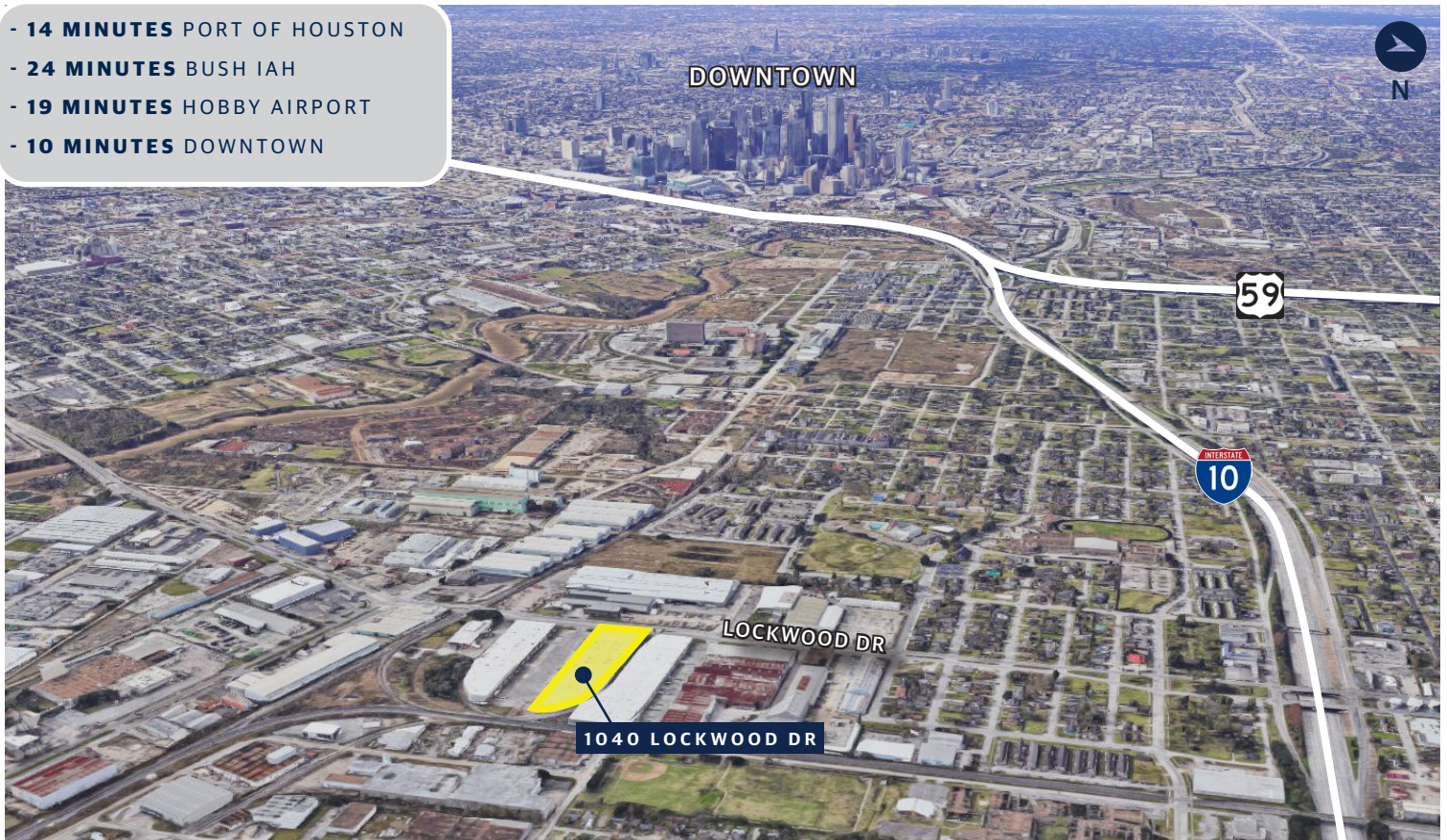

## CONTACT INFORMATION

**STEVE HAZEL**  
shazel@insiterealty.com  
713.339.5317

**DAYNE WUNDERLICH**  
dwunderlich@insiterealty.com  
713.339.5329