

NOTE: ALL HAZARDOUS HANDINGS SHALL BE PROVIDED THE ACCESSIBLE HEIGHT REQUIREMENTS OF 28"-34".

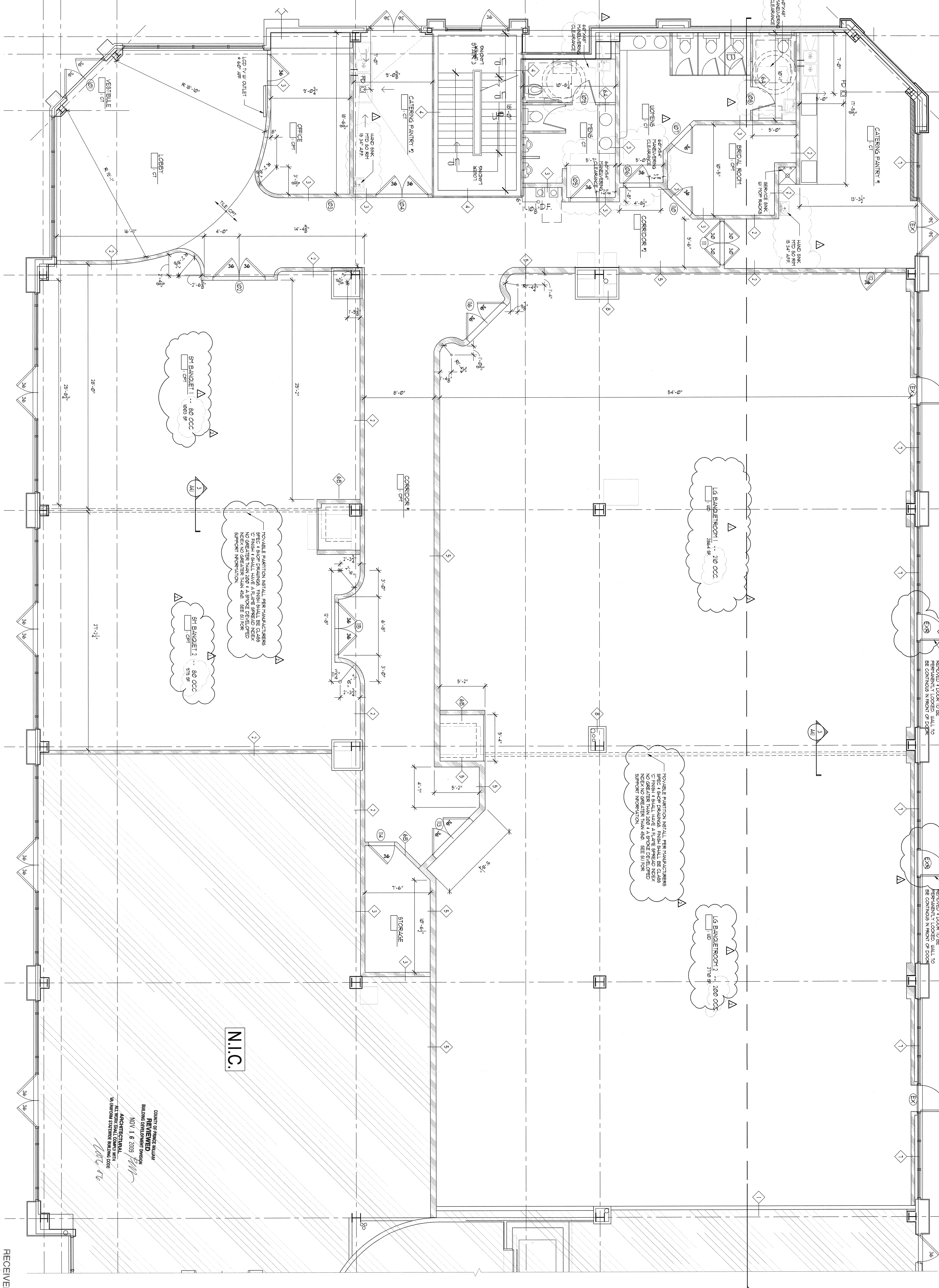

CONTRACTOR SHALL VERIFY THE SITE AND SHALL EXAMINE TO THEIR SATISFACTION ALL OF THE PHYSICAL CONDITIONS THAT AFFECT THE CONTRACT PRICE, NOTING THE LOCATION OF EXISTING UTILITIES AND RECORDS TO THE CONTRACT PRICE WILL BE DEEMED TO BE IN ACCORDANCE WITH THE CONTRACT CONDITIONS.

01 PROPOSED FLOOR PLAN
SCALE: 1/4" = 1'-0"

N.I.C.

COURT OF PRINCE WILLIAM
BUILDING DEVELOPMENT DIVISION
REVIEWED
NOV 16 2009
ARCHITECTURAL
ALL WORK SHALL COMPLY WITH
VA INTERNATIONAL BUILDING CODE
DATE: 11/16/09

RECEIVED
NOV 13 2009
PNC
BUILDING DEVELOPMENT

FLOOR PLANS

PROJECT:
**CONTINENTAL
EVENT CENTER**
9709 LIBERIA AVE, #101
MANASSAS, VA 20108

OWNER:
**CONTINENTAL
EVENT CENTER**
JAMES HESTER

KEY PLAN

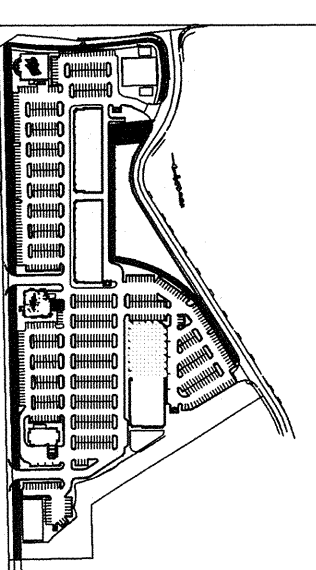

NO	DATE	DESCRIPTION
1	10/5/08	PERMIT SUBMISSION
2	10/28/09	PERMIT COMMENTS
3	11/11/09	PERMIT COMMENTS

EDWIN C. LEE
No. 000634
ARCHITECT

CETECH ENGINEERS, INC.
Mechanical Electrical Fire Protection
2000 Lee Highway
Suite 201
Fairfax, VA 22030
Phone: 703-356-2500
Fax: 703-356-2558
cedesign@comcast.net
http://cedesign.com

MPM
1011 Northwood Road
Baltimore, Maryland 21214
Phone: 410-251-7100
Fax: 410-251-7100

EDWIN LEE ARCHITECTS, LLC
RESIDENTIAL COMMERCIAL
1644 Spring Hill Rd, Suite 150
Vienna, VA 22182
tel: 703-356-4646
fax: 703-356-0037
1001 Lakeside Ave
Annapolis, MD 21017
tel: 410-969-7575
design@edwinlee.com
Edwin.Lee@architect.com