

PROPERTY MAP

MAP OF LOTS 96,97,108,109, AND PART OF
LOTS 100 THROUGH 107 INCLUSIVE IN BLOCK "C"
"MAP OF L.T. WALTER JR...."
MAP NO:259 , CASE NO.1946
FILED ON 04/12/1910

FINAL SURVEY

CERTIFY TO : HEMPSTEAD- DEPARTMENT OF BUILDINGS
DATE : AUGUST 18, 2013
SCALE : 1" to 20'

LEGEND:

BLD.....BUILDING
CLFCHAIN LINK FENCE
ENTENTRANCE
.....FIRE HYDRANT
.....GAS VALVE
.....UTILITY POLE
.....WATER VALVE

THIS SURVEY IS INTENDED FOR TITLE PURPOSES ONLY. UNAUTHORIZED ALTERATIONS OR ADDITIONS TO THIS SURVEY IS A VIOLATION OF SECTION 7209 OF THE NEW YORK STATE EDUCATION LAW. ONLY COPIES FROM THIS SURVEY MARKED WITH AN ORIGINAL OF THE LAND SURVEYORS INKED SEAL OR EMBOSSED SEAL SHALL BE CONSIDERED A TRUE COPY. CERTIFICATIONS INDICATED HEREON SHALL RUN ONLY TO THE PERSON FOR WHOM THE SURVEY IS PREPARED AND ON HIS BEHALF TO THE TITLE COMPANY, GOVERNMENTAL AGENCY AND LENDING INSTITUTIONS. CERTIFICATIONS ARE NOT TRANSFERABLE TO ADDITIONAL OR SUBSEQUENT OWNERS.

PARCEL DESCRIPTION:

BEGINNING AT A POINT ON THE NORTHERLY SIDE OF BURNSIDE AVENUE
DISTANCE 23.00 FEET FROM A LINE CONNECTING THE EASTERLY
SIDE OF WHEELOCK AVENUE WITH THE NORTHERLY SIDE OF BURNSIDE AVENUE;
RUNNING THENCE EASTERLY ALONG THE NORTHERLY SIDE OF BURNSIDE AVENUE
142.00 FEET TO A POINT;
RUNNING THENCE ALONG A LINE FORMING AN INTERIOR ANGLE OF 146°18'36"
A DISTANCE OF 21.63' TO THE WESTERLY SIDE OF TAFT AVENUE;
THENCE ALONG A LINE FORMING AN INTERIOR ANGLE OF 123°41'24"
WITH THE LAST MENTIONED LINE 115.60 FEET TO A POINT;
THENCE ALONG A LINE FORMING AN INTERIOR ANGLE WITH THE WESTERLY
SIDE OF TAFT AVENUE 90°05'20" AND PART OF A DISTANCE THROUGH A
PARTY WALL 200.00' TO THE EASTERLY SIDE OF WHEELOCK AVENUE;
THENCE ALONG THE EASTERLY SIDE OF WHEELOCK AVENUE 40.00' TO A POINT;
THENCE ALONG A LINE 90° TO THE EASTERLY SIDE OF WHEELOCK AVENUE
A DISTANCE OF 40.00' TO A POINT;
THENCE SOUTHERLY PARALLEL WITH THE EASTERLY SIDE OF WHEELOCK
AVENUE 87.50' TO THE NORTHERLY SIDE OF BURNSIDE AVENUE
TO THE POINT OR PLACE OF BEGINNING.
THE SAID PARCEL CONTAINING 21,902.00SQ.FT.

NOTES:

1. PROPERTY OBTAINS ALL NECESSARY UTILITIES FROM PUBLIC STREETS.
2. THE LEGAL DESCRIPTION DESCRIBES THE SAME PROPERTY AS THE TITLE COMMITMENT.
3. THE PROPERTY HAS ACCESS TO A PUBLIC WAY.
4. THE PROPERTY SHOWN HEREON IS NOT LOCATED WITHIN A FEDERALLY DESIGNATED SPECIAL FLOOD HAZARD AREA ("SFHA")

DAVID DYAL RUPNARAIN PLS.
NEW YORK LICENSE NO. 050295
24 KIPLING LANE
SCOTCH PLAINS, NJ 07076
TEL (347) 456-6646
FAX (347) 960-8901

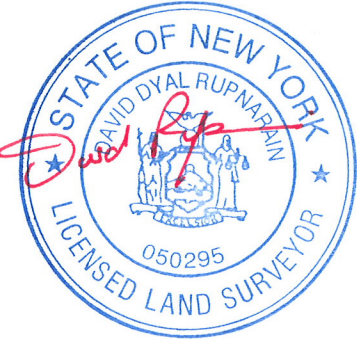

SURVEY
SECTION 40
BLOCK 15 LOT 96
INWOOD
TOWN OF HEMPSTEAD
COUNTY OF NASSAU
STATE OF NEW YORK

