

# Del Prado Place

24722 Del Prado Ave., Dana Point, CA

For  
Lease



## Property Highlights

### Del Prado Place

- New mixed-use development plans for 18 condominiums above 4,723 SF of commercial retail
- Restaurant & Retail available
- 22 Exclusive Retail Parking stalls
- Completion is set for 2nd quarter 2025

## Area Highlights

### DANA POINT

Located in southern Orange County, California, Dana Point is approximately half way between Los Angeles and San Diego, and is bordered by the cities of Laguna Niguel and Laguna Beach to the north, San Juan Capistrano to the east, and San Clemente to the south.

Dana Point is where the Pacific Coast Highway and Interstate-5 intersect. Interstate-5 is the most popular route to travel between San Diego and Los Angeles and the Pacific Coast Highway leads to popular Southern California beach cities.

Off shore, Dana Point Harbor acts as one of the main ports to and from Catalina Island.



# Del Prado Place

24722 Del Prado Ave., Dana Point, CA

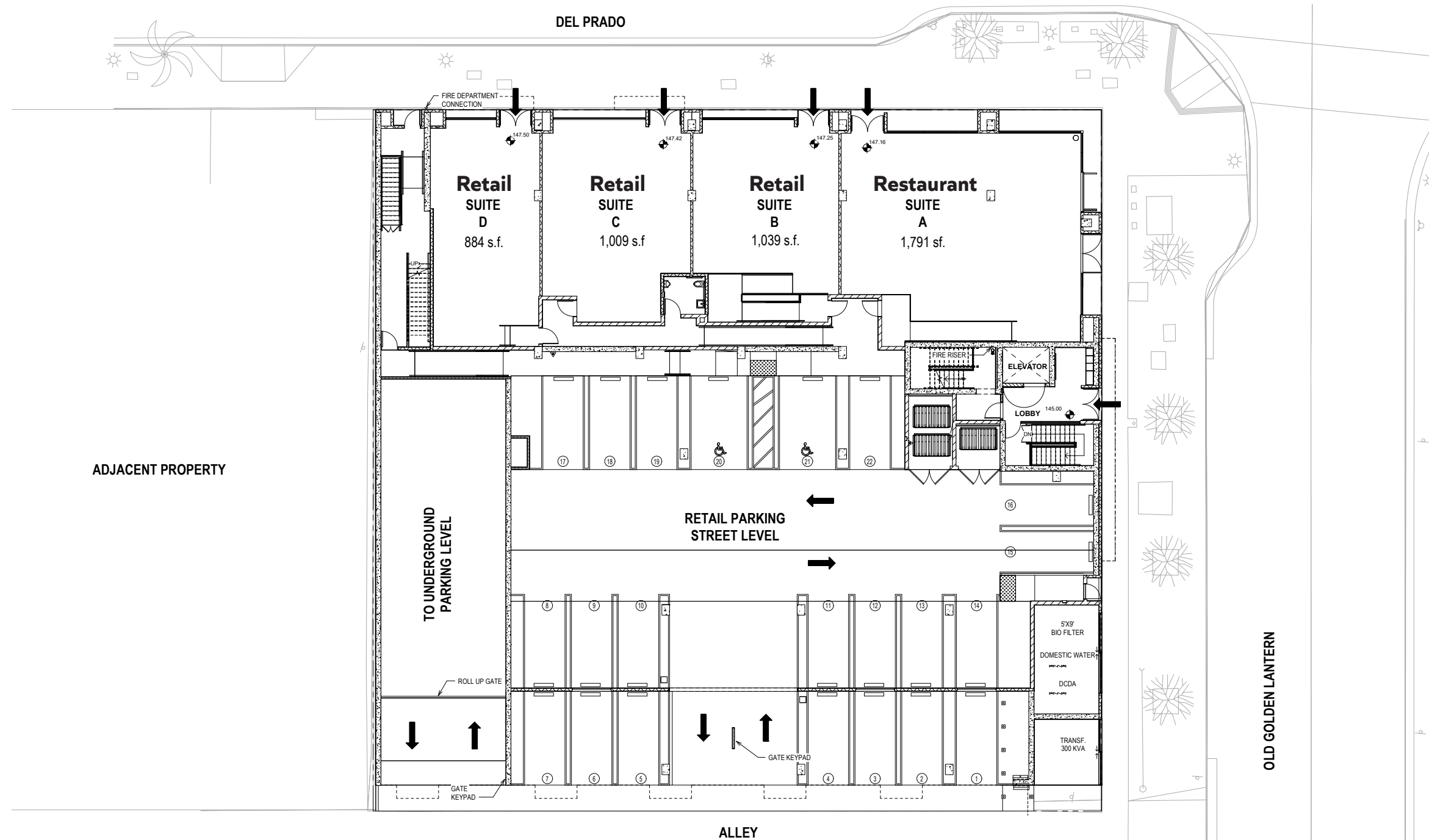

The information above has been obtained from sources believed to be reliable. While we do not doubt its accuracy, we have not verified it and make no guarantee, warranty or representation about it. It is your responsibility to independently confirm its accuracy and completeness. Any projections, opinions, assumptions or estimates used are for example only and do not represent the current or future performance of the property.



WEEKLY FARMER'S MARKET



GOLF COURSES

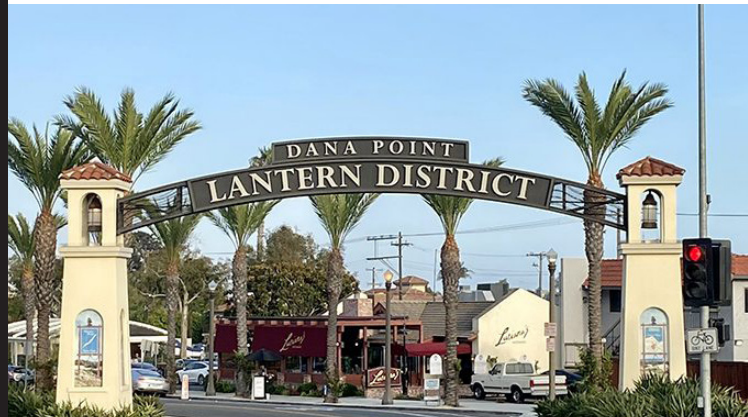

DANA POINT LANTERN DISTRICT FILLED WITH BOUTIQUE SHOPPING WITH SCENIC DINING



CONCERTS ON THE BEACH

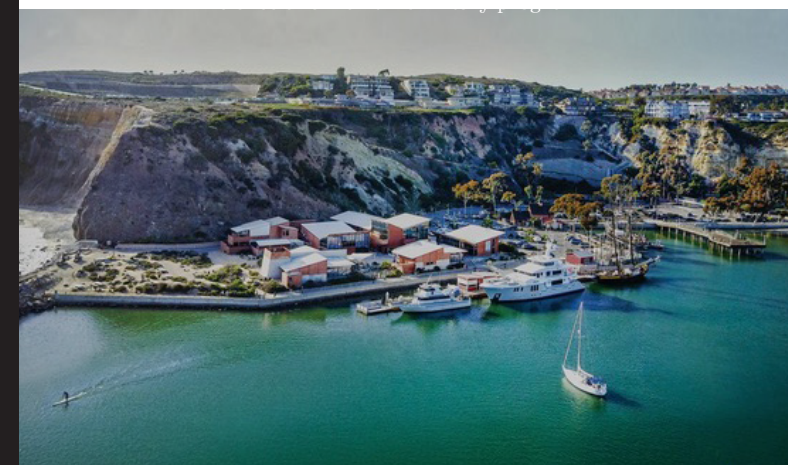

OCEAN INSTITUTE

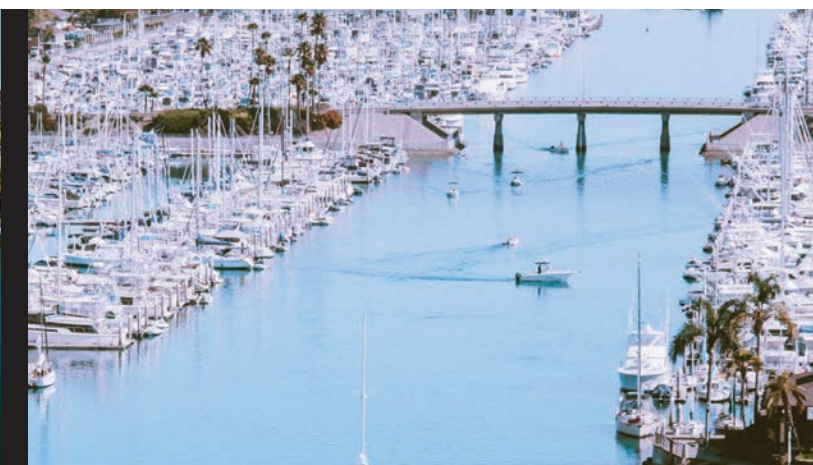

1/2 MILE FROM DANA POINT HARBOR REDEVELOPMENT

# The Neighborhood



**PRADO WEST**

MAISON CAFE-MARKET  
 DANA POINT ALE HOUSE  
 HOMESLICE  
 CLEAN JUICE  
 BEAR COAST  
 CHASE  
 YOGA SIX  
 BODY FIT TRAINING

**Spillover Cops**  
 COMING SOON

**Hobie**  
 POLARIZED

**KILLERDANA**  
 KILLER DANA SURF SHOP  
 DANA POINT, CALIFORNIA

**Ralphs**

**STATION OF CRAFT CA**  
 BREAD • BUTTER • BREAD

**Pacific Coast Hwy 17,000 ADT**

**Still Water**  
 FOOD, WINE, SPIRITS & SOUNDS

**Del Prado Pl 5,000 ADT**

**Golden Lantern St 15,154 ADT**

**GIANA**  
 BAKERY • PROVISIONS

**SITE**

**COASTAL KITCHEN**

**Luciana's**  
 RISTORANTE

**TRULY PIZZA**

**Jack's**  
 Restaurant & Bar

**Shwack**  
 BLACKSBALL

**Dana Point Harbor Dr 8,000 ADT**

**Baby Beach**

## Demographics

### EXPANDED DEMOGRAPHIC PROFILE



<b>Population</b>	<b>1 Mile</b>	<b>3 Miles</b>	<b>5 Miles</b>
Estimated Population	12,935	59,532	133,662
Forecasted Population (2029)	13,004	59,864	133,118
<b>Daytime Demos</b>			
Total Daytime Population	14,407	57,896	122,621
<b>Median HH Income</b>			
Estimated Median Household Income	\$115,273	\$128,140	\$134,186
Median Disposable Income	\$97,185	\$105,008	\$107,972
<b>Avg HH Income</b>			
Estimated Avg Household Income	\$164,741	\$182,438	\$190,087
Avg Disposable Income	\$111,609	\$120,047	\$124,239
<b>Age</b>			
Median Age	49.7	50.1	48.1

# Del Prado Place

24722 Del Prado Ave., Dana Point, CA

**RI** RETAIL INSITE

**Chris Hodgman** | 949.284.0223 | [chodgman@retailinsite.net](mailto:chodgman@retailinsite.net)

**Connor Stevens** | 949.490.1411 | [cstevens@retailinsite.net](mailto:cstevens@retailinsite.net)

**Mark Moser** | 858.788.9448 | [markmoser@retailinsite.net](mailto:markmoser@retailinsite.net)