

TEMECULA CORPORATE PARK

43391-43397 BUSINESS PARK DRIVE, TEMECULA, CA 92590

FOR LEASE

INDUSTRIAL / FLEX SPACE

+/-5,022 SF



FOR MORE INFORMATION, PLEASE CONTACT:

CAREY PASTOR | Senior Vice President

(951) 297-7434 | cpastor@cbcsocalgroup.com

CalDRE License # 01403298



**COLDWELL BANKER
COMMERCIAL**
SC

TEMECULA CORPORATE PARK

43391-43397 BUSINESS PARK DRIVE, TEMECULA, CA 92590

FOR LEASE
INDUSTRIAL / FLEX SPACE
+/-5,022 SF



PROJECT HIGHLIGHTS

- High image industrial/flex space for lease
- Located in the Rancho California Business Park
- Close proximity to the I-15 freeway via Rancho California Road
- Ample parking
- Rear loading 10' x 12' roll up doors
- Flexible floor plans

TEMECULA CORPORATE PARK

43391-43397 BUSINESS PARK DRIVE, TEMECULA, CA 92590

FOR LEASE
INDUSTRIAL / FLEX SPACE
+/-5,022 SF

AVAILABILITY

UNIT	UNIT SIZE (SF)	MONTHLY BASE RENT	2026 ESTIMATED MONTHLY COMMON AREA OPERATING EXPENSES (CAOE)	DESCRIPTION
43391 C-2	±5,022 SF	\$5,022.00 per month	\$2,260.00 per month	Reception area, 4 private offices, wet bar, storage closet, balance of space warehouse w/10'w x 12'h rear loading roll up door and man door

SITE PLAN



C-2 FLOOR PLAN

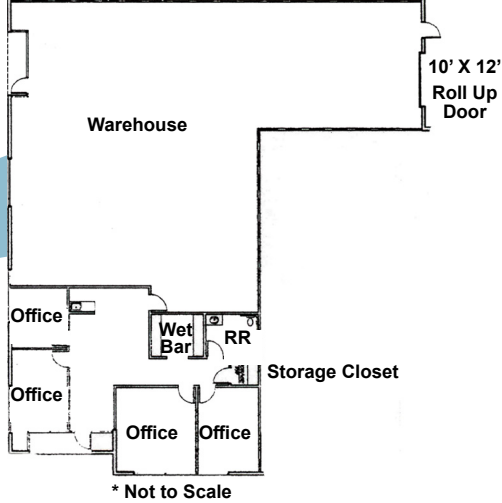

TEMECULA CORPORATE PARK

43391-43397 BUSINESS PARK DRIVE, TEMECULA, CA 92590

FOR LEASE
INDUSTRIAL / FLEX SPACE
+/-5,022 SF

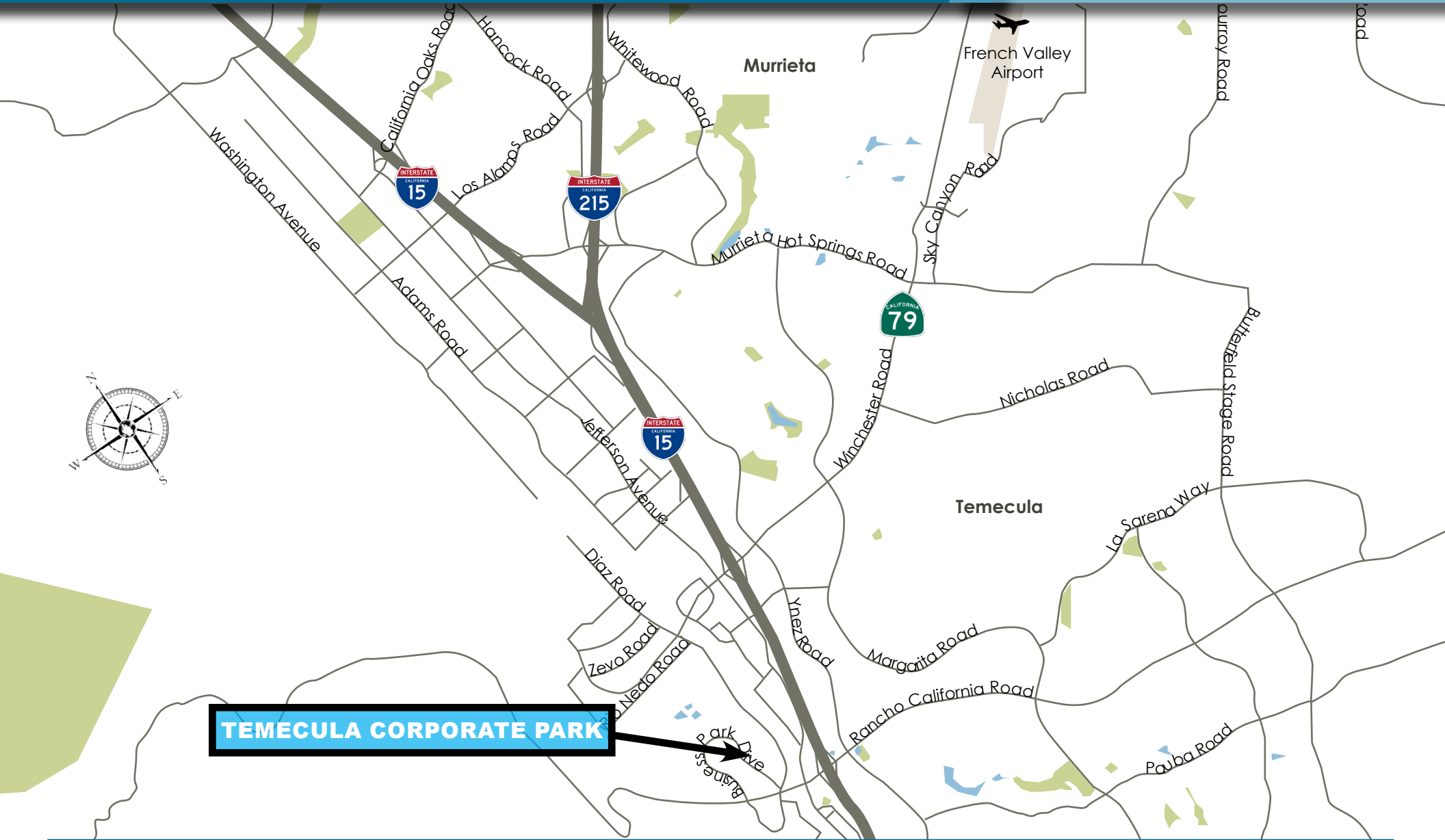

Coldwell Banker Commercial and the Coldwell Banker Commercial Logo are registered service marks licensed to Coldwell Banker Commercial Affiliates. Each Office is Independently Owned and Operated. All information contained herein has been obtained from sources deemed reliable. However, no warranty or guarantee is made as to the accuracy of the information.

CalDRE License # 02089395

TEMECULA CORPORATE PARK

43391-43397 BUSINESS PARK DRIVE, TEMECULA, CA 92590

FOR LEASE
INDUSTRIAL / FLEX SPACE
+/-5,022 SF



FOR MORE INFORMATION, PLEASE CONTACT:

CAREY PASTOR

Senior Vice President

951.297.7434

cpastor@cbcsocalgroup.com

CalDRE # 01403298

27368 Via Industria | Suite 102
Temecula | California | 92590
t 951.200.7683 | f 951.239.3147
cbcsocalgroup.com



COLDWELL BANKER
COMMERCIAL
SC