

FOR SUBLEASE

STRYKER BUSINESS CENTER

120,599 SF BUILDING AVAILABLE

20308 59th Pl S | Kent, WA



NEWMARK

THAD MALLORY, SIOR
thad.mallory@nmrk.com
425-362-1410

BLAKE BENTZ
blake.bentz@nmrk.com
425-362-1391

FOR SUBLEASE

STRYKER BUSINESS CENTER

120,599 SF BUILDING AVAILABLE

20308 59th Pl S | Kent, WA

SITE PLAN

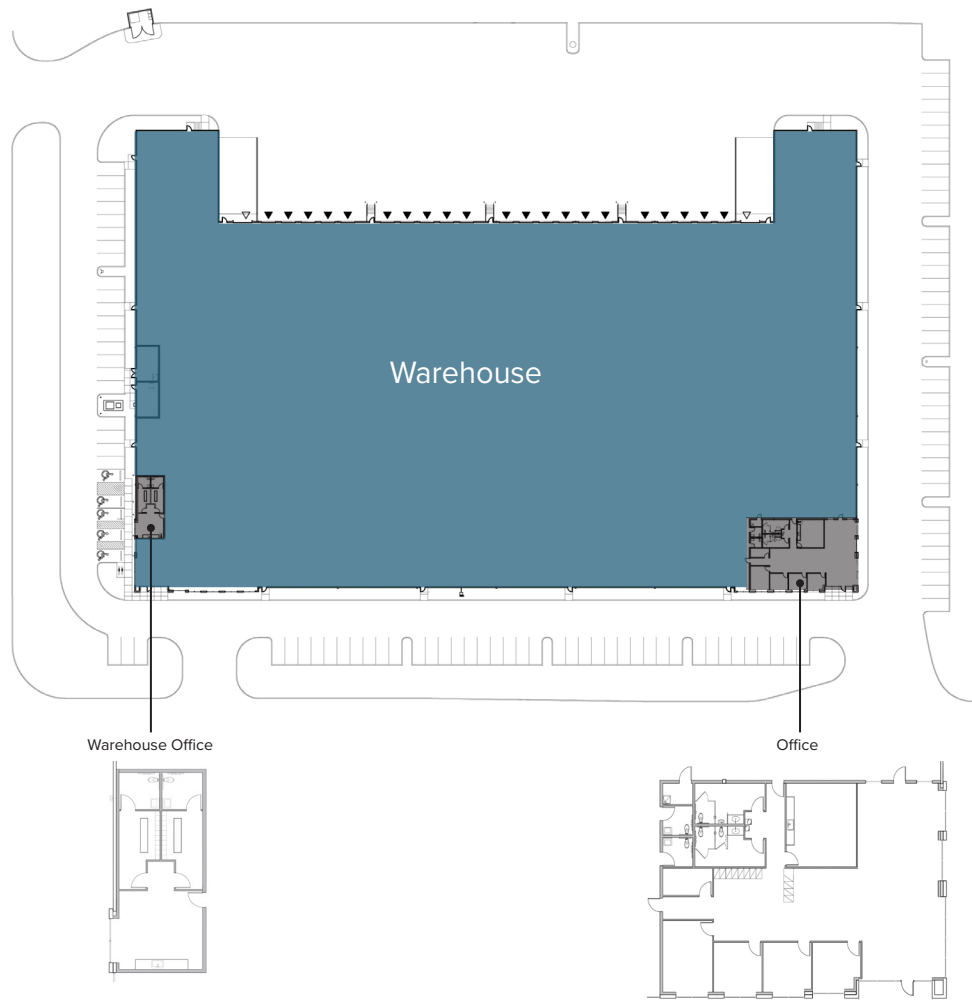

BUILDING DETAILS

BUILDING SF

120,599 SF

(3,336 SF Office & 767 SF Warehouse Office)

CLEAR HEIGHT

30'

LOADING

21 Dock High Doors & 2 Grade Level Doors

POWER

2,000 Amps, 277/480v, 3-phase

ESFR FIRE PROTECTION SYSTEM

130' TRUCK MANEUVERING

52' X 45' TYPICAL BAY SPACING

PROPERTY HIGHLIGHTS

- Sublease term through July 31, 2030
- Available January 1, 2024
- Excellent freeway access to I-5, I-405 and SR 167
- Generous concrete truck courts & Ample parking
- Zoned Manufacturing & Industrial Park

FOR SUBLEASE

STRYKER BUSINESS CENTER

120,599 SF BUILDING AVAILABLE

20308 59th Pl S | Kent, WA



The distributor of this communication is performing acts for which a real estate license is required. The information contained herein has been obtained from sources deemed reliable but has not been verified and no guarantee, warranty or representation, either express or implied, is made with respect to such information. Terms of sale or lease and availability are subject to change or withdrawal without notice.