



FOR LEASE
2150 KERPER BLVD

287,025 SF
DUBUQUE, IA

PATRICK DEDERING | 414-376-6933 | PATRICK@PHOENIXINVESTORS.COM



PHOENIX
INVESTORS

Opportunity. Execution. Value Creation.

This document has been prepared by Phoenix Investors for advertising and general information only. Phoenix Investors makes no guarantees, representations, or warranties of any kind, expressed or implied, regarding the information including, but not limited to, warranties of content, accuracy, and reliability.



PROPERTY HIGHLIGHTS



**3-PHASE HEAVY
POWER**



**RAIL SPUR SERVICED
BY CANADIAN
PACIFIC**



**IDEAL FOR HEAVY
MANUFACTURING &
DISTRIBUTION**



**EXTENSIVE
CAR & TRAILER
PARKING**



**QUALITY
BLUE COLLAR
WORKFORCE**



PROPERTY DETAILS

2150 KERPER BLVD | DUBUQUE, IA

AVAILABLE SPACE	287,025 SF
OFFICE SPACE	4,929 SF
DOCK DOORS	8 Exterior 4 Interior
GRADE-LEVEL DRIVE-IN DOORS	1
CLEAR HEIGHT	15' 6" - 24'
ROOF	TPO
WALLS	Precast, Masonry, & Insulated Metal Panel
YEAR BUILT	1959 (with Multiple Additions)
FIRE SUPPRESSION	100% Wet & Dry System
LIGHTING	LED & Fluorescent
POWER	4,500 Amp 227/480V 3-Phase
PARKING	60 Trailer Spaces 75 Car Spaces
LAND AREA	12.16 Acres
ZONING	Industrial
RAIL ACCESS	Rail Spur Serviced by Canadian Pacific



FLOOR PLAN

2150 KERPER BLVD | DUBUQUE, IA

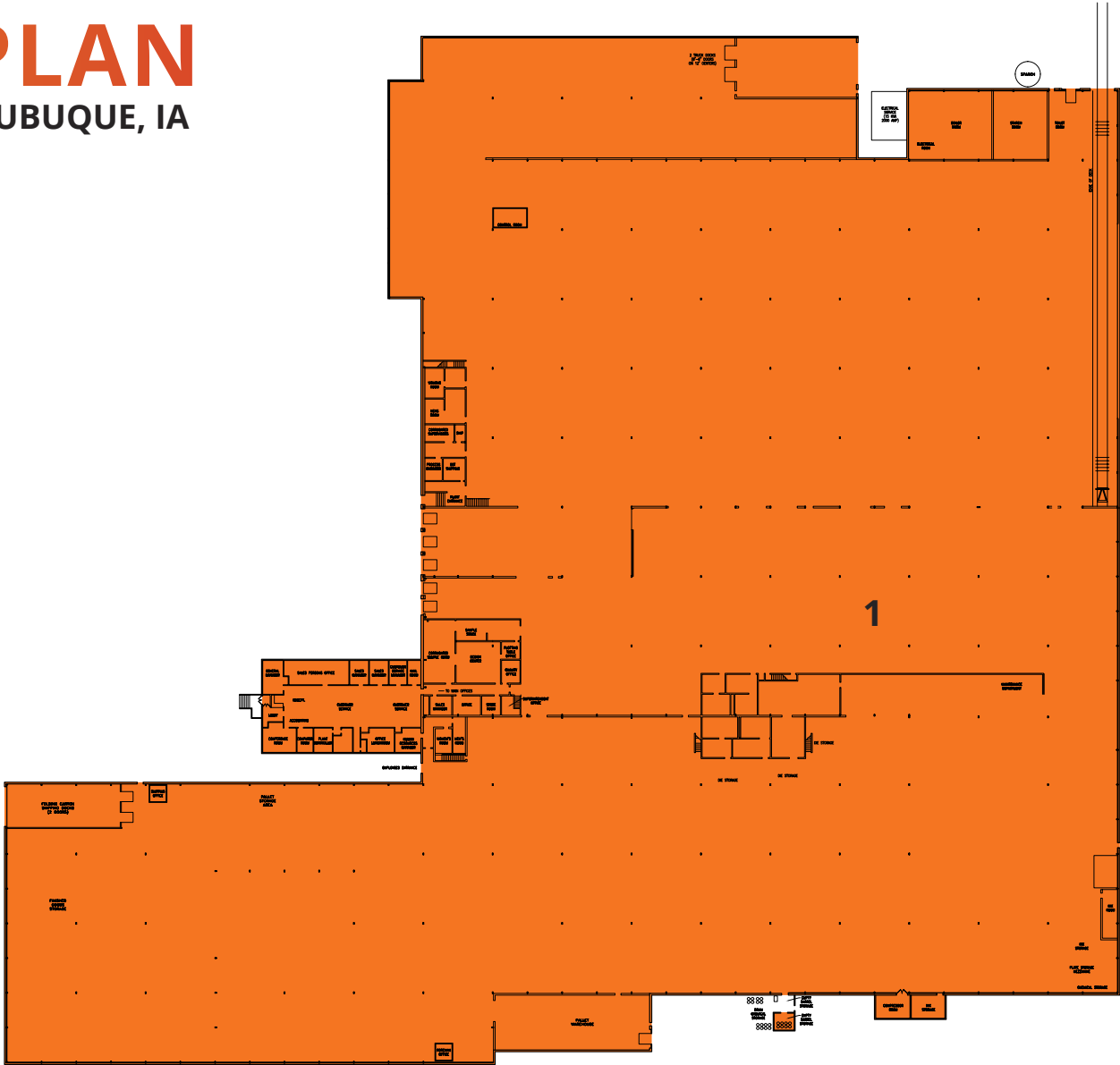

NUMBER	SPACE DESIGNATION	DOCKS	DRIVE-INS	CLEAR HEIGHT	SQUARE FEET
1	AVAILABLE	12	1	15' 6" - 24'	287,025 SF
TOTAL					287,025 SF

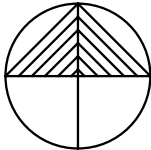

LOCATION MAP

2150 KERPER BLVD | DUBUQUE, IA

CEDAR RAPIDS, IA	75 MILES
MADISON, WI	91 MILES
ROCKFORD, IL	94 MILES
MILWAUKEE, WI	171 MILES

