

Copyright 2023 HEB Engineers, Inc.

No.	Revision	DATE	BY

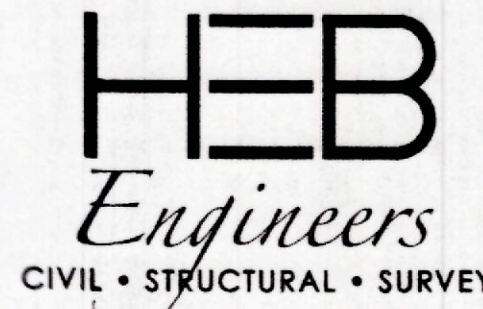
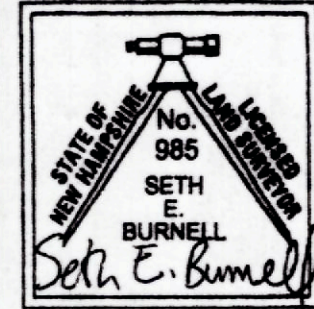

HEB Engineers, Inc.  
www.hebengineers.com  
NH Office (603) 356-6936  
Post Office Box 440  
North Conway, NH 03860  
ME Office (207) 803-8265  
Post Office Box 343  
Bridgton, ME 04009

SURVEYED BY	JAD,DW
DESIGNED BY	-
DRAWN BY	DAB
CHECKED BY	SEB
FIELD BOOK	372,374
SCALE	1"=250'
DATE	June 30, 2023

Boundary Plan  
of land of  
Eldridge Hill Group, LLC  
in  
Ossipee, New Hampshire  
prepared for  
Nick Castel