

For Lease | $\pm 11,036$ SF plus a $\pm 1,500$ SF shop space

NEC Harbor Blvd & Victoria St | Join Trader Joe's

2170-2180 Harbor Blvd, Costa Mesa, CA 92627



For leasing, please contact:

JOHN ROMM

714.906.9804
jromm@w-retail.com
Lic. 01752292

JOHN LEFFLER

714.454.7502
jleffler@w-retail.com
Lic. 01327613

LAUREN COLEMAN

949.988.3204
lcoleman@w-retail.com
Lic. 02123668



w-retail.com

3333 Michelson Dr, Suite 150 Irvine, CA 92612

The information contained within this brochure has been obtained from sources other than Western Retail Advisors, Inc. Western Retail Advisors has not verified such information and makes no guarantee warranty or representation about such information. It is your responsibility to independently confirm its accuracy and completeness. Any dimensions, specifications, floor plans and information may not be accurate and should be verified by you prior to the lease or purchase of the property.

PROJECT HIGHLIGHTS



Address 2170-2180 Harbor Blvd, Costa Mesa, CA

Population (2 mi) 96,435

Median HH Income (2 mi) \$102,496

Employees (2 mi) 56,171

Traffic Counts Harbor Blvd - 40,000 ADT
Victoria St - 30,000 ADT

- Available now for lease:
- ±11,036 SF - Suite 50 (demised portion of the former 99 Cents)
- Available on 4/26:
- ±1,500 SF shop space - Suite H (currently occupied by Intermex)
- Prominent street visibility with pylon and monument signage



[illegible]

REESTABLISHED FROM FOUND
REFERENCE POINTS PER
CORNER RECORD 2022-3457

COLLEGE AVENUE
PUBLIC RIGHT-OF-WAY WIDTH VARIES
(ASPHALT ROAD)

DEMISING PLAN

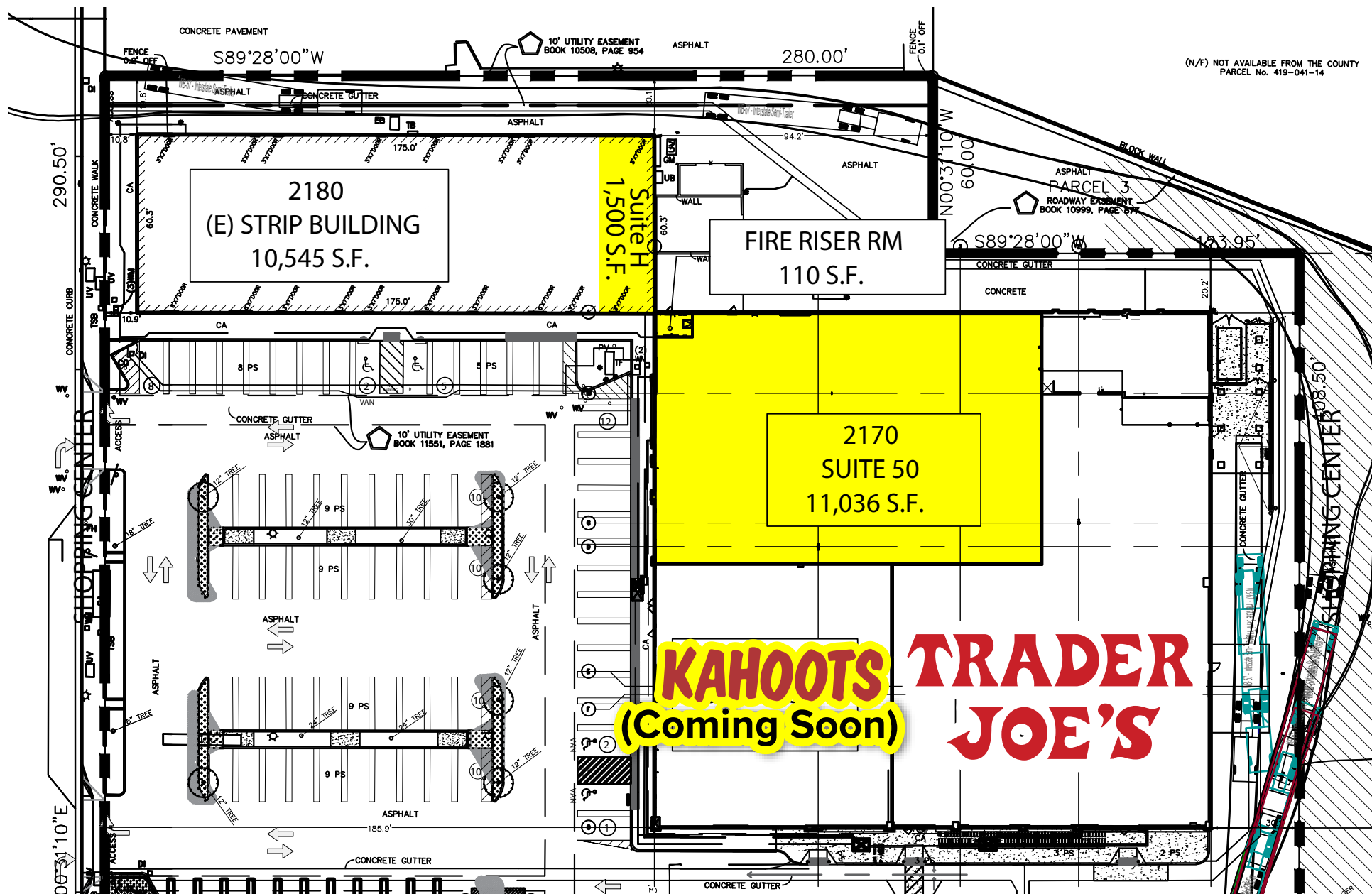

TRADE AREA HIGHLIGHTS



CONCEPTUAL ELEVATIONS



South Elevation



Corner Perspective



Corner Perspective Strip Building



West Elevation



Strip Building Storefront



JOHN ROMM

714.906.9804
jromm@w-retail.com
Lic. 01752292

JOHN LEFFLER

714.454.7502
jleffler@w-retail.com
Lic. 01327613

LAUREN COLEMAN

949.988.3204
lcoleman@w-retail.com
Lic. 02123668



w-retail.com

3333 Michelson Dr, Suite 150 Irvine, CA 92612

The information contained within this brochure has been obtained from sources other than Western Retail Advisors, Inc. Western Retail Advisors has not verified such information and makes no guarantee warranty or representation about such information. It is your responsibility to independently confirm its accuracy and completeness. Any dimensions, specifications, floor plans and information may not be accurate and should be verified by you prior to the lease or purchase of the property.