

Sandy Retail Showroom

10763 S. State Street
Sandy, UT 84070

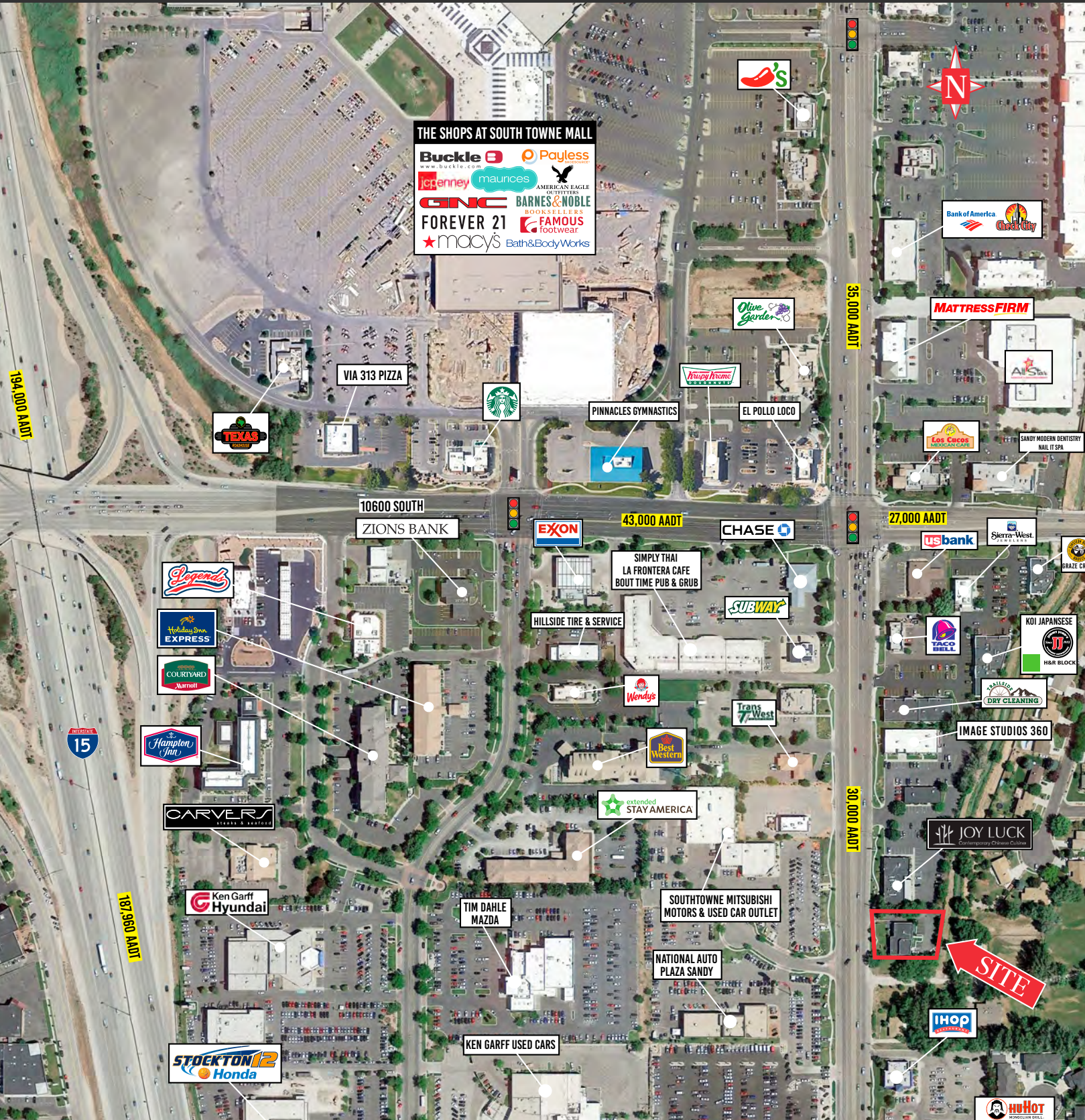

RETAIL | FOR LEASE

PROPERTY INFORMATION

- > \$26.00 PSF NNN
- > \$6.00 PSF CAM
- > 4,140 SF Available
- > 2 private offices
- > Conference room
- > Ground level door/warehouse
- > Additional 460 SF mezzanine for storage
- > Excellent State Street location with high traffic
- > Monument sign

DEMOGRAPHICS

POPULATION	1 MILE	3 MILE	5 MILE
2025 EST	11,923	102,893	289,126
2030 PROJ	12,143	103,281	289,889
HOUSEHOLDS			
2025 EST	4,964	36,656	100,840
2030 PROJ	5,215	37,749	103,628
INCOME			
2025 AVG	\$126,837	\$142,508	\$149,787
2025 MED	\$99,514	\$111,206	\$113,017

Source: ESRI 2025

FLOOR PLAN

