

Price Reduction

\$3,995,000.00
(\$219.50 PSF)

360



Gillespie's
Abbey Carpet & Floor

For Sale ±18,200 SF Free Standing Building
For Lease ±10,713 SF (Take all or part)

R&D/Flex Space Available

360 Chadbourne Road | Fairfield, CA

Highlights



Highly improved R&D Flex/Office
& Retail Showroom with warehouse
in the rear



Convenient freeway access to I-80, I-680 and Hwy 12
(Equi-distant between San Francisco and Sacramento)



Power:
800 Amps @ 120/208 Volts
3 Phase 4 Wire



Four (4) 12' x 14'
Roll-Up Doors



Clear Height
19'



Attractive rear loading



Sprinklered

Contact Brokers



Accelerating success.

Bret DeMartini, CCIM
Colliers

CA License No. 00853110
bret.demartini@colliers.com
+1 707 322 2108



Chris Petrini
Petrini Commercial

CA License No. 01020505
chris@petrinicommercial.com
+1 510 507 8665

360 Chadbourne Road | Fairfield, CA

Floor Plan

	Office		Warehouse		Roll-Up Door		Not a Part
---	--------	---	-----------	---	--------------	---	------------

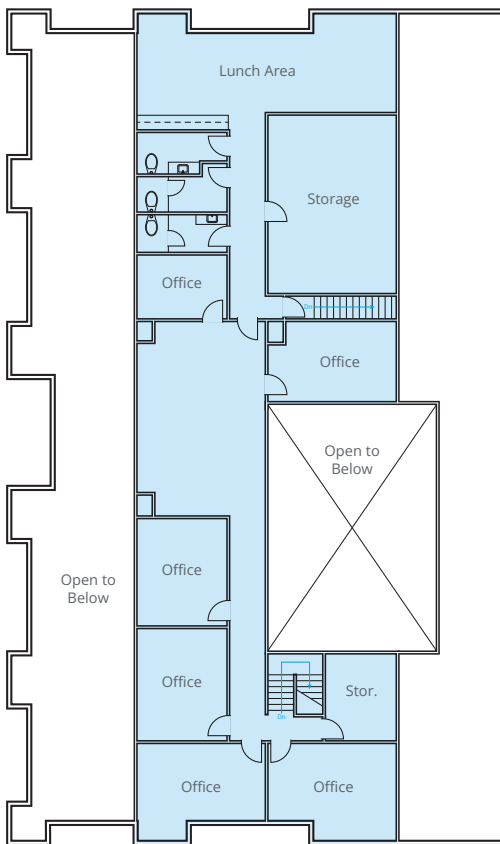

Second Floor

±3,178 SF of Office

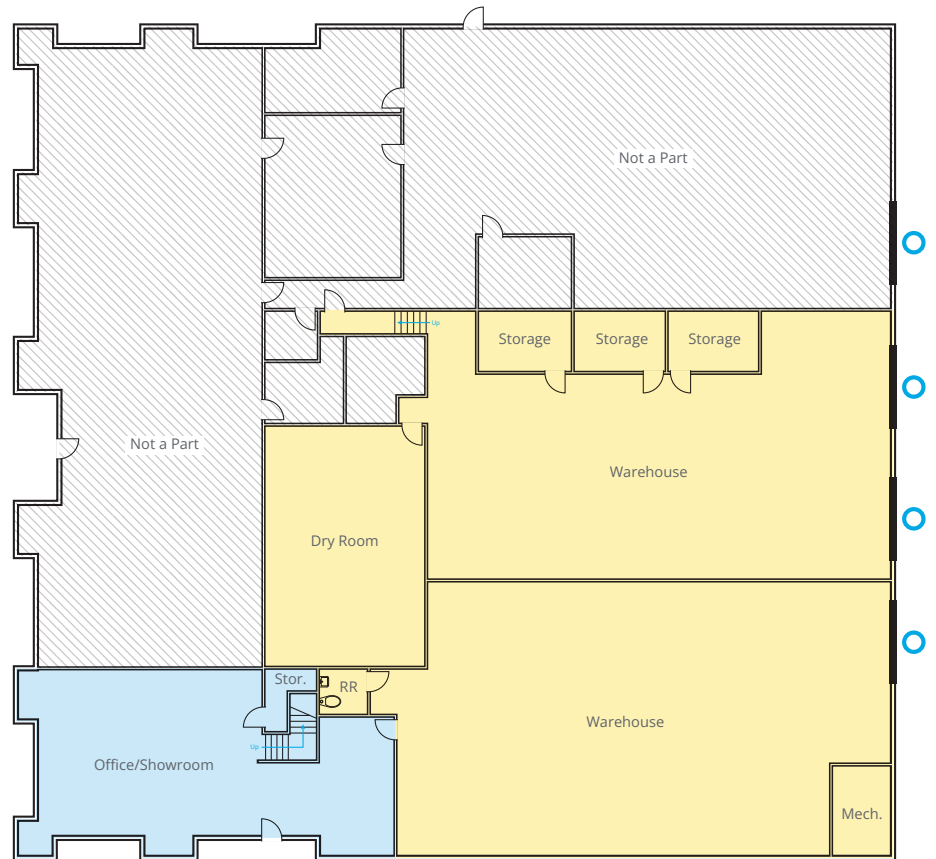

First Floor

±6,355 SF combined warehouse area and
±1,180 SF of office/showroom area.

Contact Brokers



Bret DeMartini, CCIM
Colliers
CA License No. 00853110
bret.demartini@colliers.com
+1 707 322 2108



Chris Petrini
Petrini Commercial
CA License No. 01020505
chris@petrinicommercial.com
+1 510 507 8665

360 Chadbourne Road | Fairfield, CA

Location Overview



Location Highlights



Centrally located
in Fairfield



39.0 mi to Oakland
44.1 mi to Sacramento
45.0 mi to San Francisco
54.6 mi to Stockton
74.0 mi to San Jose



360 Chadbourne Road | Fairfield, CA

Location Overview



Contact Brokers



Bret DeMartini, CCIM
Colliers
CA License No. 00853110
bret.demartini@colliers.com
+1 707 322 2108



Chris Petrini
Petrini Commercial
CA License No. 01020505
chris@petrinicommercial.com
+1 510 507 8665