

16900 - 16912 JOY ROAD
DETROIT, MICHIGAN

RETAIL FOR SALE OR LEASE
1,738 Square Feet Available



**SIGNATURE
ASSOCIATES**
KNOW SIGNATURE | KNOW RESULTS



PROPERTY FEATURES

- 1,738 square feet available
- Operational car dealership
- Immediate access to Southfield Fwy (M-39)
- Lease Rate: \$5.00/month Gross
- Sale Price: \$600,000 (\$345.22/sq. ft.)



For more information, please contact:

JOE STACK
(248) 359 0615
jstack@signatureassociates.com

CHRIS MONSOUR
(248) 948 0107
cmonsour@signatureassociates.com

SIGNATURE ASSOCIATES
One Towne Square, Suite 1200
Southfield, MI 48076
www.signatureassociates.com

16900 - 16912 Joy Road – Detroit, Michigan
Retail For Sale or Lease

1,738
Square Feet
AVAILABLE

Site Plan

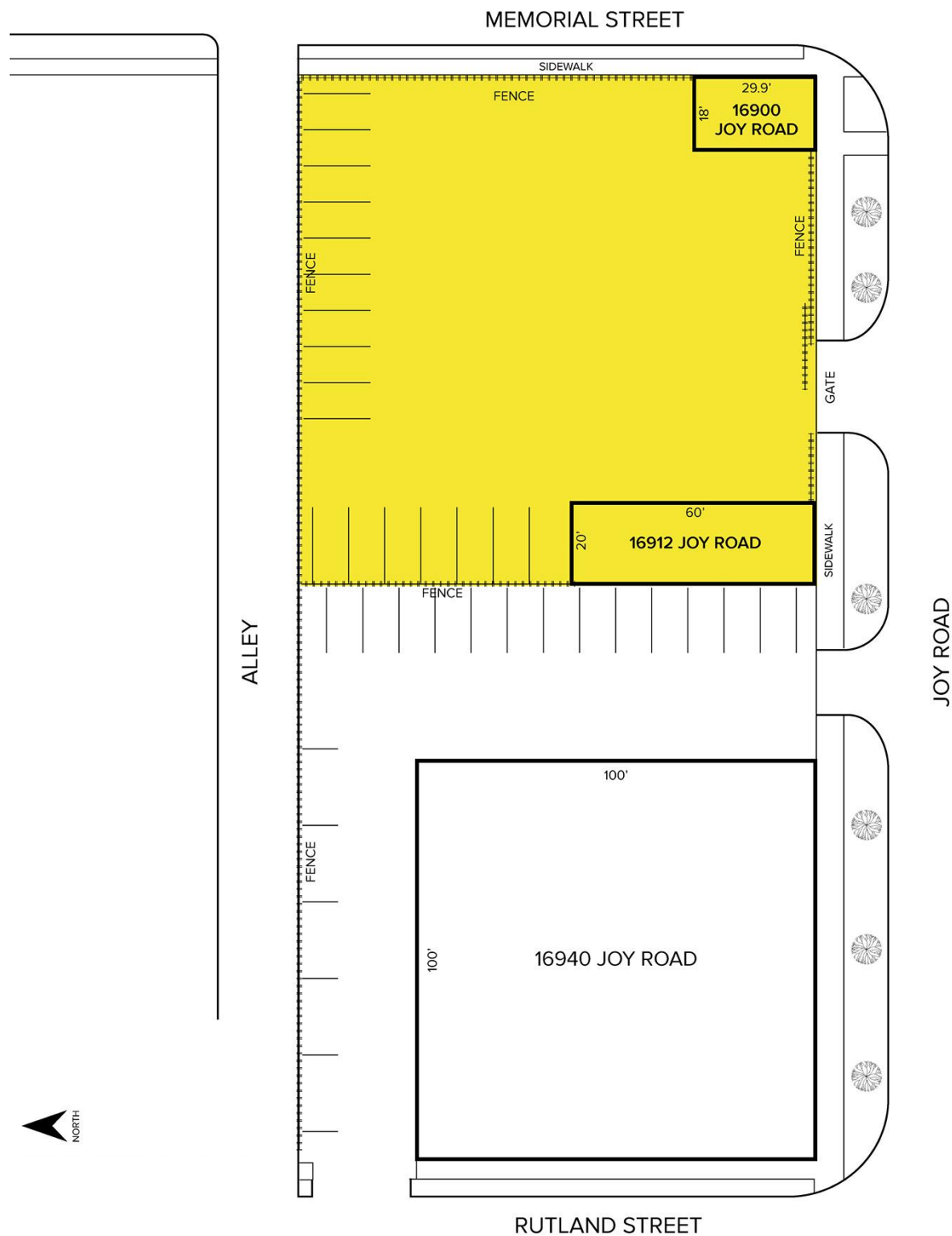

For more information, please contact:

JOE STACK
(248) 359 0615
jstack@signatureassociates.com

CHRIS MONSOUR
(248) 948 0107
cmonsour@signatureassociates.com

SIGNATURE ASSOCIATES
One Towne Square, Suite 1200
Southfield, MI 48076
www.signatureassociates.com

16900 - 16912 Joy Road – Detroit, Michigan

Retail For Sale or Lease

1,738
Square Feet
AVAILABLE



DEMOGRAPHICS

	POPULATION	MED. HH INCOME
1 MILE	19,033	\$34,657
3 MILE	160,111	\$43,320
5 MILE	384,559	\$49,871

TRAFFIC COUNTS (TWO-WAY)

12,661	Joy Rd. E of Southfield Fwy.
13,031	Joy Rd. W of Southfield Fwy.
139,775	Southfield Fwy. S of Joy Rd.
140,205	Southfield Fwy. N of Joy Rd.

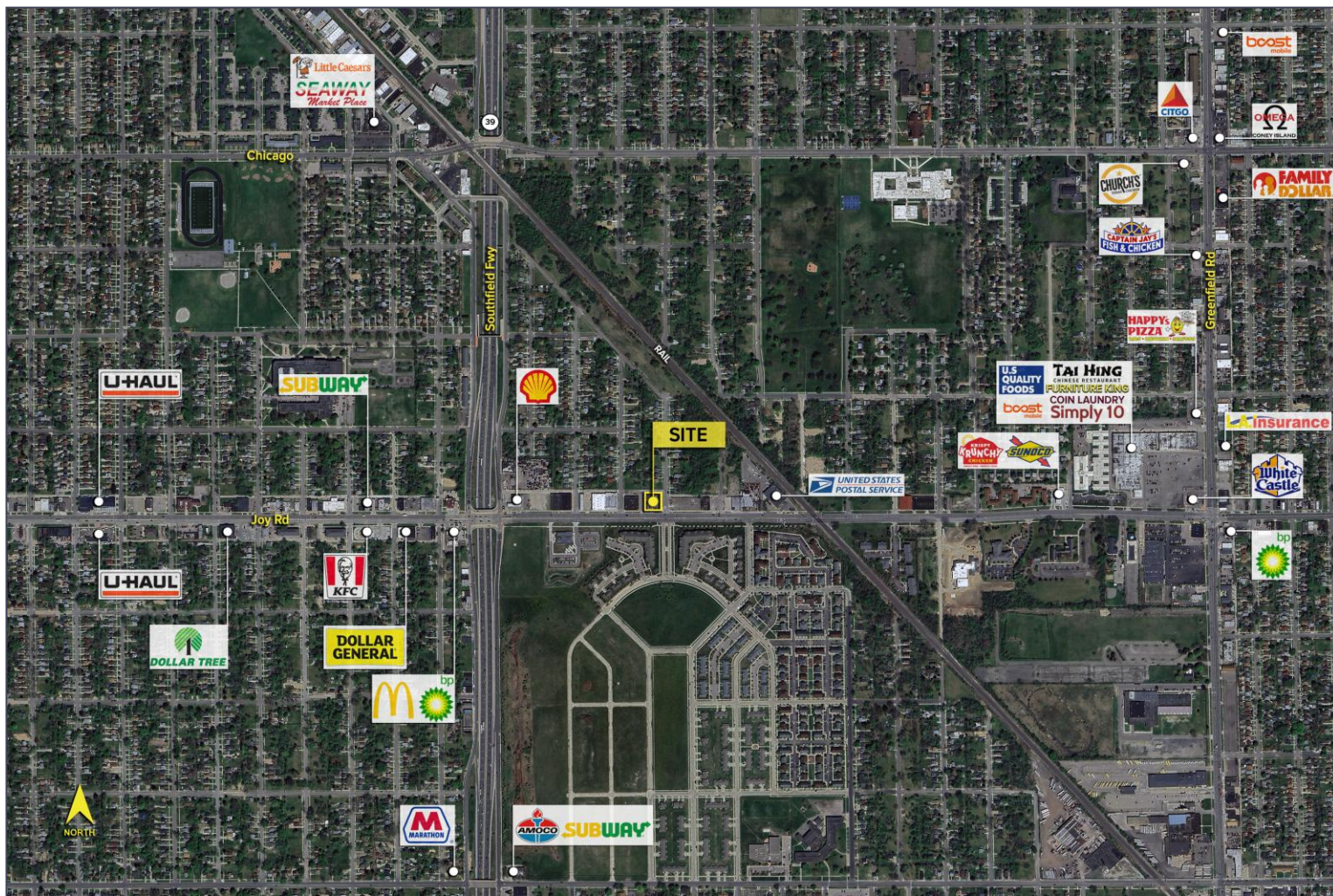

For more information, please contact:

JOE STACK
(248) 359 0615
jstack@signatureassociates.com

CHRIS MONSOUR
(248) 948 0107
cmonsour@signatureassociates.com

SIGNATURE ASSOCIATES
One Towne Square, Suite 1200
Southfield, MI 48076
www.signatureassociates.com