

851 Napa Valley Corporate Way, Napa

Suite E ~ ±3,303 SF ~ \$1.35/SF/Mo. NNN



- 3 Private Offices
- Conference Room
- Open Office Area
- Break Room
- 2 Restrooms & Shower Room
- Warehouse
- Single-Story Office
- Generous Full-Height Windows
- Separately Metered
- Walking Distance to Dining Options
- Located in the City of Napa
- Bus Stop Nearby

**Procuring Broker
Fee 5%***

A lease of five years or more will be granted a concession of three months free Base Rent if the lease is signed by the end of 2025.

NOTE: Other office suites in the complex available from ±2,142 SF - ±23,121 SF. Divisions will affect the price, but will be reasonably negotiated.

Virtual Tour: <https://www.youtube.com/watch?v=LPh30-BTnMQ>

*For up to 5 Years, then 1.5% for any extended term.



Michael Moffett
License #00946472
707.479.1976
mmoffett@cbnapavalley.com

1775 Lincoln Ave.
Napa, CA 94558

Cathy D'Angelo Holmes

License #01355085
707.304.3338
cholmes@cbnapavalley.com



851 Napa Valley Corporate Way, Napa

Suite E ~ ±3,303 SF ~ \$1.35/SF/Mo. NNN

Photos



Michael Moffett

License #00946472

707.479.1976

mmoffett@cbnapavalley.com

1775 Lincoln Ave.
Napa, CA 94558

Cathy D'Angelo Holmes

License #01355085

707.304.3338

cholmes@cbnapavalley.com

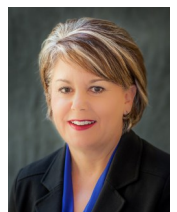



**COLDWELL BANKER
COMMERCIAL**
BROKERS
OF THE VALLEY

851 Napa Valley Corporate Way, Napa

Suite E ~ ±3,303 SF ~ \$1.35/SF/Mo. NNN

Floorplan

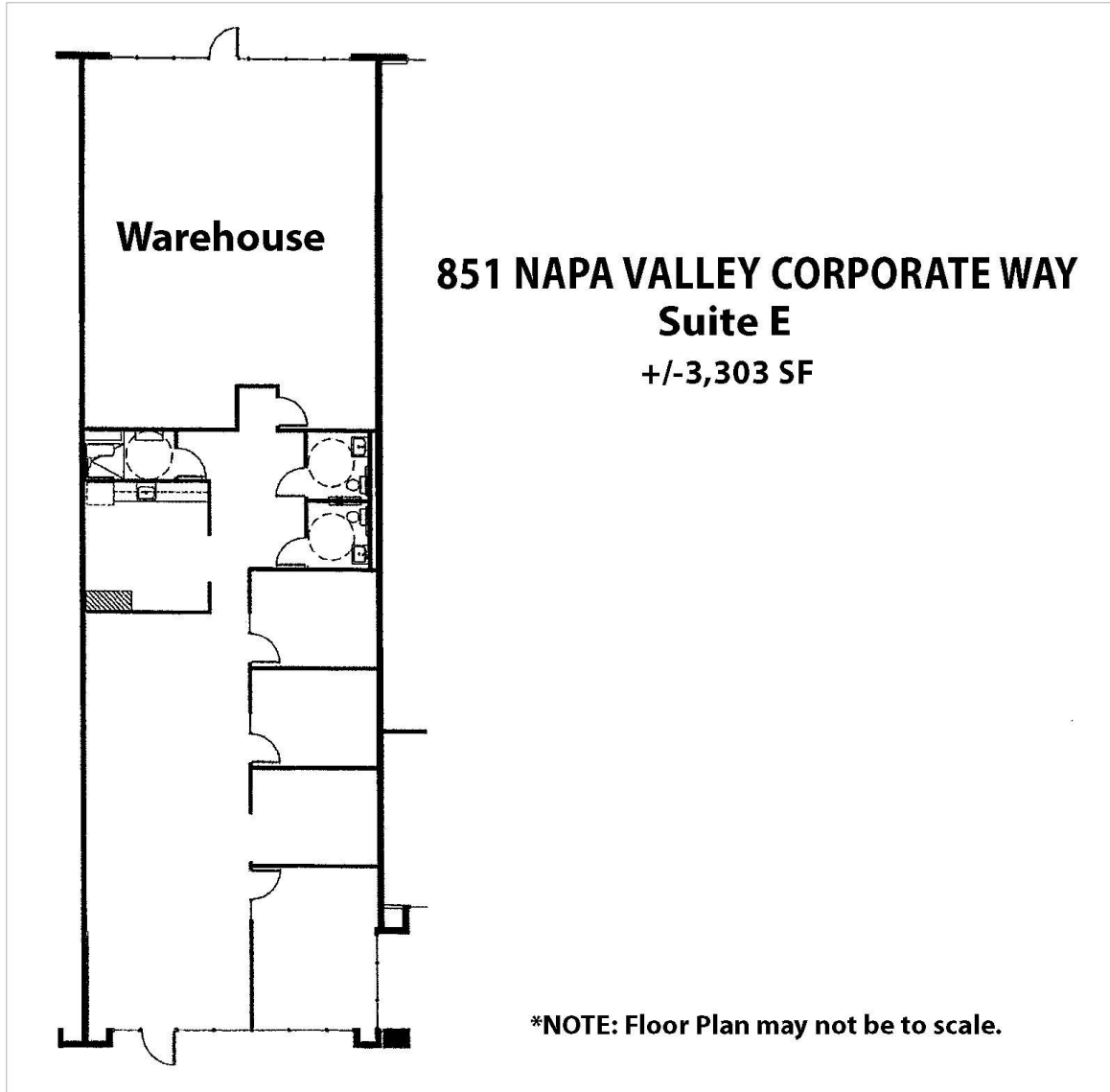

Michael Moffett
License #00946472
707.479.1976
mmoffett@cbnapavalley.com

1775 Lincoln Ave.
Napa, CA 94558

Cathy D'Angelo Holmes

License #01355085
707.304.3338
cholmes@cbnapavalley.com

