

FOR LEASE

CBRE

7005 Luther Drive

SACRAMENTO, CA

Unit 11 ±2,880 SF Industrial Unit



Contact Us

Zac Sweet, SIOR
Senior Vice President
C: 916 717 4768
zac.sweet@cbre.com
Lic. 01352800

Courtney Lee
Associate
C: 916 906 5544
courtney.lee@cbre.com
Lic. 02031694

Tyler Howell
Senior Associate
T: 916 781 4835
tyler.howell1@cbre.com
Lic. 02100245



PROPERTY INFORMATION

**7005 LUTHER DRIVE
SACRAMENTO, CA 95823**

BUILDING SIZE: ±15,842 SF

- GOOD ACCESS TO HIGHWAY 99
- CONCRETE TILT-UP CONSTRUCTION

UNIT 11: ±2,880 SF

- ±880 SF OFFICE
- 12'x12' GRADE LEVEL DOOR
- 16' CLEAR HEIGHT
- ASKING RATE: \$0.85/SF PLUS NNN
- NNN EXPENSES: \$0.35/SF

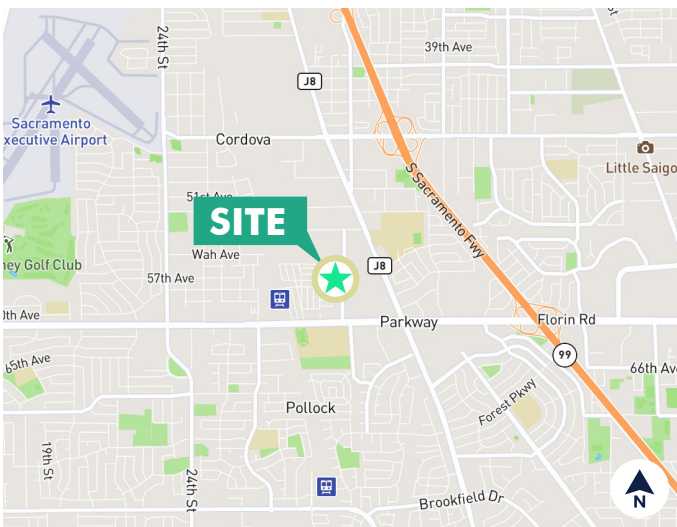

Contact Us

Zac Sweet, SIOR
Senior Vice President
C: 916 717 4768
zac.sweet@cbre.com
Lic. 01352800

Courtney Lee
Associate
C: 916 906 5544
courtney.lee@cbre.com
Lic. 02031694

Tyler Howell
Senior Associate
T: 916 781 4835
tyler.howell1@cbre.com
Lic. 02100245



FLOOR PLAN - UNIT 11 | ±2,880 SF

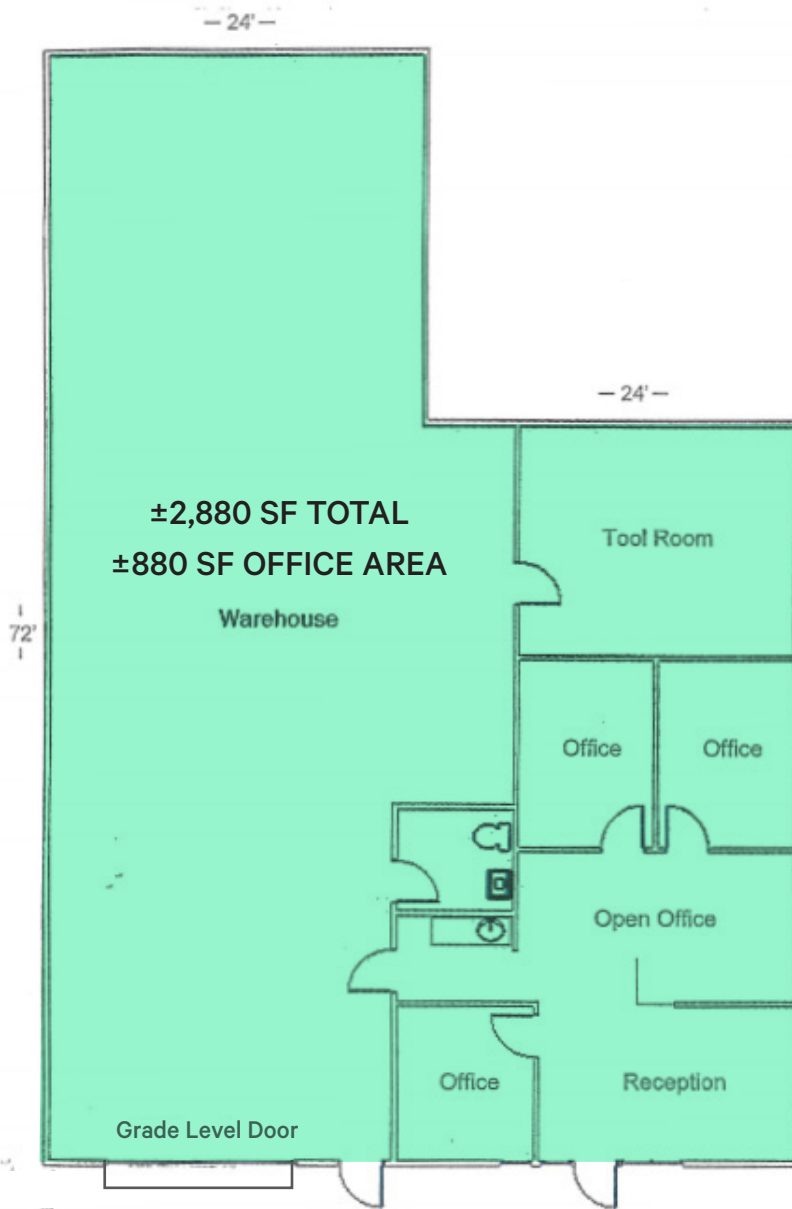

*Floor plan not to scale, dimensions approximate



Contact Us

Zac Sweet, SIOR
Senior Vice President
C: 916 717 4768
zac.sweet@cbre.com
Lic. 01352800

Courtney Lee
Associate
C: 916 906 5544
courtney.lee@cbre.com
Lic. 02031694

Tyler Howell
Senior Associate
T: 916 781 4835
tyler.howell1@cbre.com
Lic. 02100245