

520 LANSING STREET
CHARLOTTE, MICHIGAN

LAND FOR SALE
13.79 Acres Available



**SIGNATURE
ASSOCIATES**
KNOW SIGNATURE | KNOW RESULTS



PROPERTY FEATURES

- 13.79 acres available
- Opportunity zone and MSHDA
- All utilities available at site
- Located off I-69
- Excellent location in the fast-growing city of Charlotte
- National/local retailers along Lansing St. corridor
- Many possible mixed-use development opportunities including retail, industrial, auto dealership, auto towing, medical, multi-family, hospitality, storage and more
- Asking Price: \$1,300,000.00 (\$94,271.21/acre)

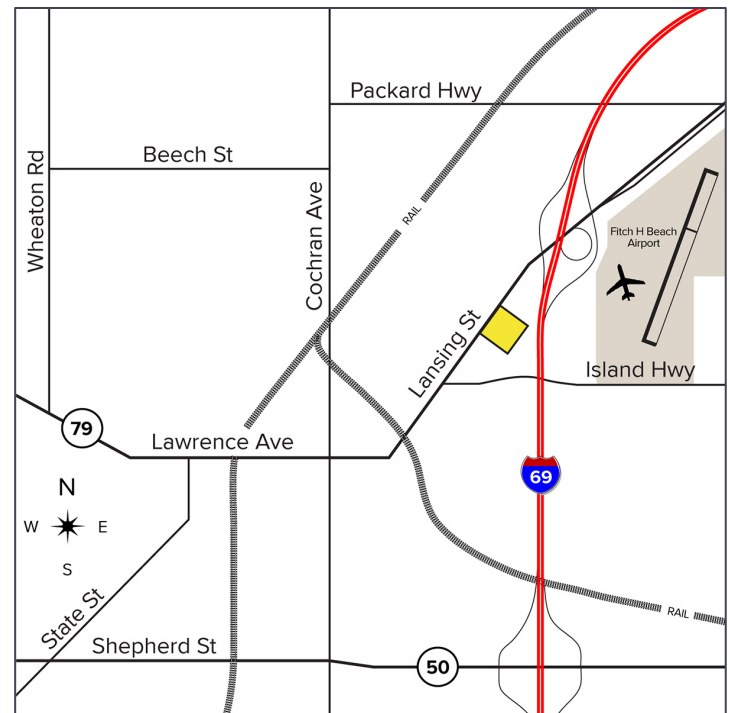

For more information, please contact:

MARVIN PETROUS
(248) 359 0647

mpetrous@signatureassociates.com

JOE RIZQALLAH
(616) 235 6007

jrizqallah@signatureassociates.com

SIGNATURE ASSOCIATES
One Towne Square, Suite 1200
Southfield, MI 48076
www.signatureassociates.com

Information is subject to verification and no liability for errors or omissions is assumed. Price is subject to change and listing withdrawal.

520 Lansing Street – Charlotte, Michigan
Land For Sale

13.79
Acres
AVAILABLE

Site Plan



For more information, please contact:

MARVIN PETROUS
(248) 359 0647
mpetrous@signatureassociates.com

JOE RIZQALLAH
(616) 235 6007
jrizzqallah@signatureassociates.com

SIGNATURE ASSOCIATES
One Towne Square, Suite 1200
Southfield, MI 48076
www.signatureassociates.com

Information is subject to verification and no liability for errors or omissions is assumed. Price is subject to change and listing withdrawal.

520 Lansing Street – Charlotte, Michigan

Land For Sale

13.79
Acres
AVAILABLE

Labeled Aerial



For more information, please contact:

MARVIN PETROUS
(248) 359 0647

mpetrous@signatureassociates.com

JOE RIZQALLAH
(616) 235 6007

jrizqallah@signatureassociates.com

SIGNATURE ASSOCIATES
One Towne Square, Suite 1200
Southfield, MI 48076
www.signatureassociates.com

Information is subject to verification and no liability for errors or omissions is assumed. Price is subject to change and listing withdrawal.