

**FOR LEASE**

# 185 MASON CIRCLE | Suite E

Concord, CA 94520

**±10,975 SF**  
**Available Now**



**CONTACT US**

Bo Harkins  
+1 925 296 7727 | [bo.harkins@cbre.com](mailto:bo.harkins@cbre.com)

Tony Binswanger, SIOR  
+1 925 296 7728 | [tony.binswanger@cbre.com](mailto:tony.binswanger@cbre.com)

**CBRE**



## SITE PLAN

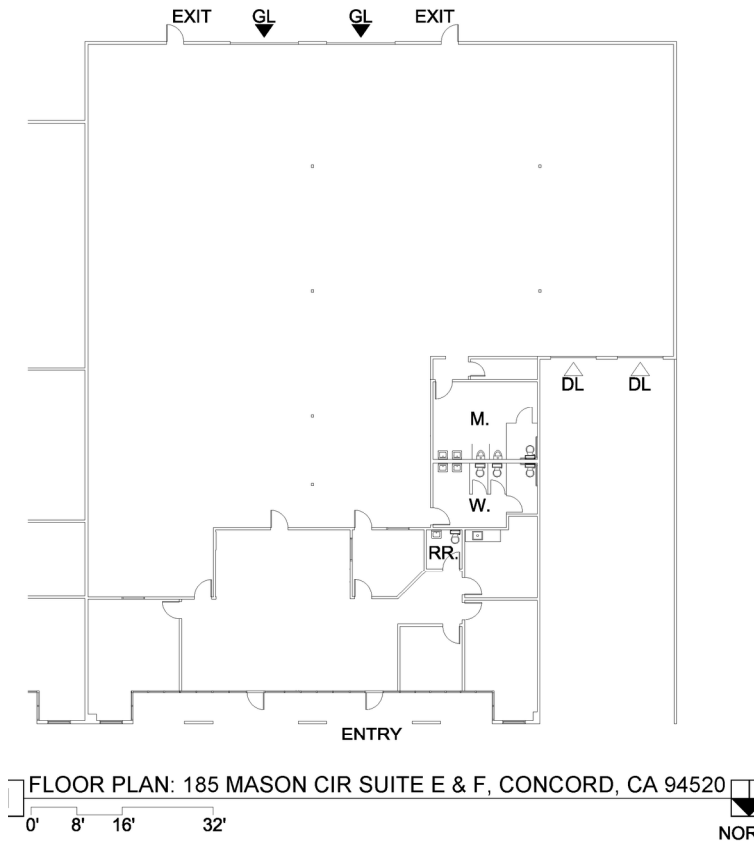

## PROPERTY HIGHLIGHTS

- ±10,975 SF
- ± 2,000 SF Office
- Three (3) Restrooms
- Five (5) Private Offices
- Conference Room
- Breakroom
- Temperature Controlled and Insulated Warehouse
- ±20' Clear Height
- Two (2) Dock Doors
- Two (2) 12'x14' Grade Level Doors
- Close Proximity to Hwy 4 & 680
- CALL BROKERS FOR PRICING

## Contact Us

Bo Harkins  
First Vice President  
+1 925 296 7727  
bo.harkins@cbre.com  
Lic. 01943785

Tony Binswanger, SIOR  
Executive Vice President  
+1 925 296 7728  
tony.binswanger@cbre.com  
Lic. 01861701

CBRE, Inc  
1676 N California Blvd  
Suite 500  
Walnut Creek, CA 94596  
www.cbre.com/walnutcreek  
Lic. 00409987