

Parcel Line Table

Line #	Length	Direction
L1	146.68'	S0° 56' 40"E
L2	31.69'	S0° 56' 34"E

Curve Table

Curve #	Length	Radius	Delta	Chord Direction	Chord Length
C1	7.85'	7.16'	62.82'	S58° 30' 41"E	7.46'
C2	224.76'	42.20'	305.17'	N0° 18' 58"E	38.86'
C3	9.91'	9.10'	62.42'	S58° 56' 30"W	9.43'

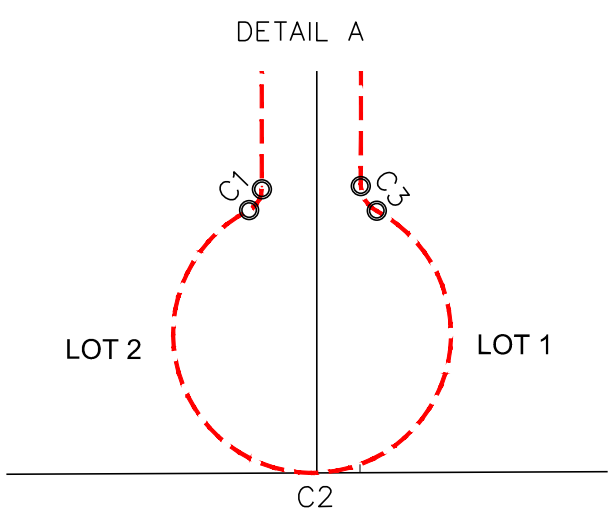

LEGEND

- These standard symbols will be found in the drawing.
- SET IRON ROD
 - FOUND IRON ROD
 - AC. ACREAGE
 - P.O.B. POINT OF BEGINNING
 - P.O.C. POINT OF COMMENCING
 - EASEMENT BOUNDARY

MHR Engineering, LLC.
 TBPE REGISTRATION NO. F-12026
 TBPLS REGISTRATION NO. F-10193913
 16845 Blanco Road, Suite 106, San Antonio, TX 78232
 PH: (210)641-0543, FAX: 210-497-2227
 www.mhreng.com

LEGAL DESCRIPTIONS:
 ATTACHED- "EXHIBIT-A"

NO.	DATE	DESCRIPTION	BY

To (name of insured, if known),
 (name of lender, if known):

This is to certify that this map or plot and the survey on which it is based is true and correct according to an actual field survey, made by me or under my supervision, of the property shown hereon or described by field notes accompanying this drawing. I further certify that this survey meets or exceeds the minimum standards established by the Texas Board of Professional Land Surveying.



Surveyors Notes:
 1. Basis of Bearing is based on Texas State Plane Coordinates (NAD 83) South Central Zone (4204).

I, Harun Rashid, Registered Professional Land Surveyor number 6411, do hereby certify that a survey was made on the ground, under my supervision, on date as shown, of the property hereon described, and I do declare there are no conflicts known to me except as shown.

Harun Rashid
 05-16-22

HARUN RASHID
 R.P.L.S.
 Registered Professional Land Surveyor
 Registration No. 6411