

19288 EUREKA ROAD
SOUTHGATE, MICHIGAN



**SIGNATURE
ASSOCIATES**
KNOW SIGNATURE | KNOW RESULTS

RETAIL FOR SALE OR LEASE
1,800 Square Feet Available



PROPERTY FEATURES

- 1,800 square feet available
- Former restaurant available on well-travel Eureka Road
- Nearby national retailers, regional mall, access to I-75 and Detroit Metro Airport
- Site ideal for fast food, coffee, bakery and other retail uses
- Can be assembled up to 2.12 acres
- Lease Rate: \$18.00/sq. ft. NNN



For more information, please contact:

JUSTIN GAFFREY
(248) 799 3143
jgaffrey@signatureassociates.com

SIGNATURE ASSOCIATES
One Towne Square, Suite 1200
Southfield, MI 48076
www.signatureassociates.com

19288 Eureka Road – Southgate, Michigan

Retail For Sale or Lease

1,800
Square Feet
AVAILABLE

Site Plan

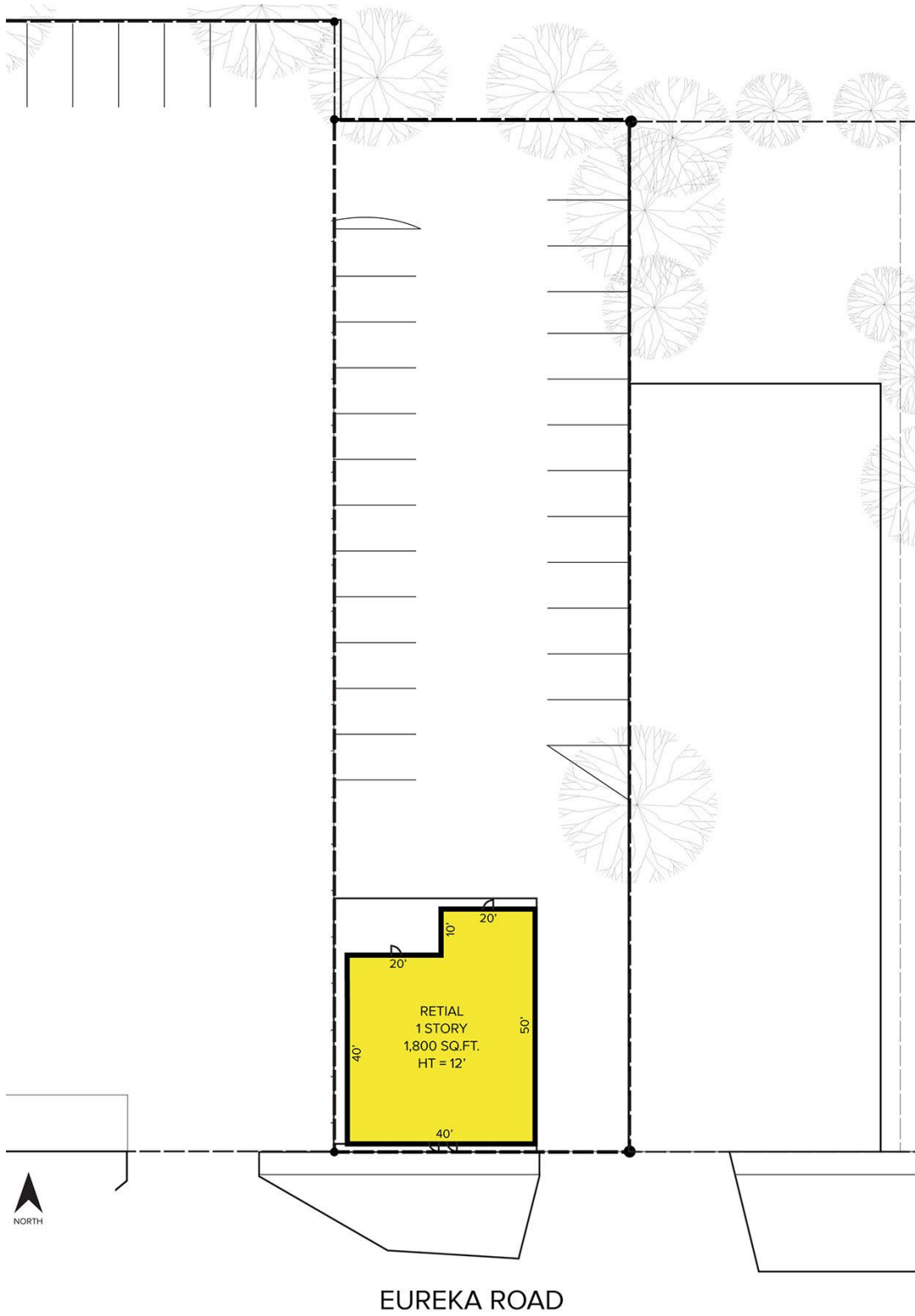

For more information, please contact:

JUSTIN GAFFREY
(248) 799 3143
jgaffrey@signatureassociates.com

SIGNATURE ASSOCIATES
One Towne Square, Suite 1200
Southfield, MI 48076
www.signatureassociates.com

Information is subject to verification and no liability for errors or omissions is assumed. Price is subject to change and listing withdrawal.

19288 Eureka Road – Southgate, Michigan

Retail For Sale or Lease

1,800
Square Feet
AVAILABLE



DEMOGRAPHICS

	POPULATION	MED. HH INCOME
1 MILE	6,301	\$65,784
3 MILE	82,069	\$67,262
5 MILE	222,656	\$68,223

TRAFFIC COUNTS (TWO-WAY)

20,243	Allen Rd. N of Eureka Rd.
15,529	Allen Rd. S of Eureka Rd.
32,295	Eureka Rd. E of Allen Rd.
31,440	Eureka Rd. W of Allen Rd.



For more information, please contact:

JUSTIN GAFFREY
(248) 799 3143
jgaffrey@signatureassociates.com

SIGNATURE ASSOCIATES
One Towne Square, Suite 1200
Southfield, MI 48076
www.signatureassociates.com