



CUSHMAN &
WAKEFIELD

345



345 LORTON AVE

SUITES 203 & 204
BURLINGAME, CA

±2,120 SF OFFICE SPACE FOR LEASE OR FOR SALE





PROPERTY HIGHLIGHTS

HIGHLIGHTS

SUITES 203 & 204

- 5 Private Offices
- 1 Conference Room
- 1 Board Room
- Open Space
- Reception
- Operable Windows
- Great Natural Light
- Located in the Heart of Downtown Burlingame
- Walking Distance to Caltrain and Amenities
- Underground Parking
- Secured Common Courtyard Area
- Additional Parking Available in Caltrain Parking Lot Located Across the Street
- **Call Brokers For Asking Rent or Sale Price**

SUITE 203 GALLERY



FLOOR PLAN

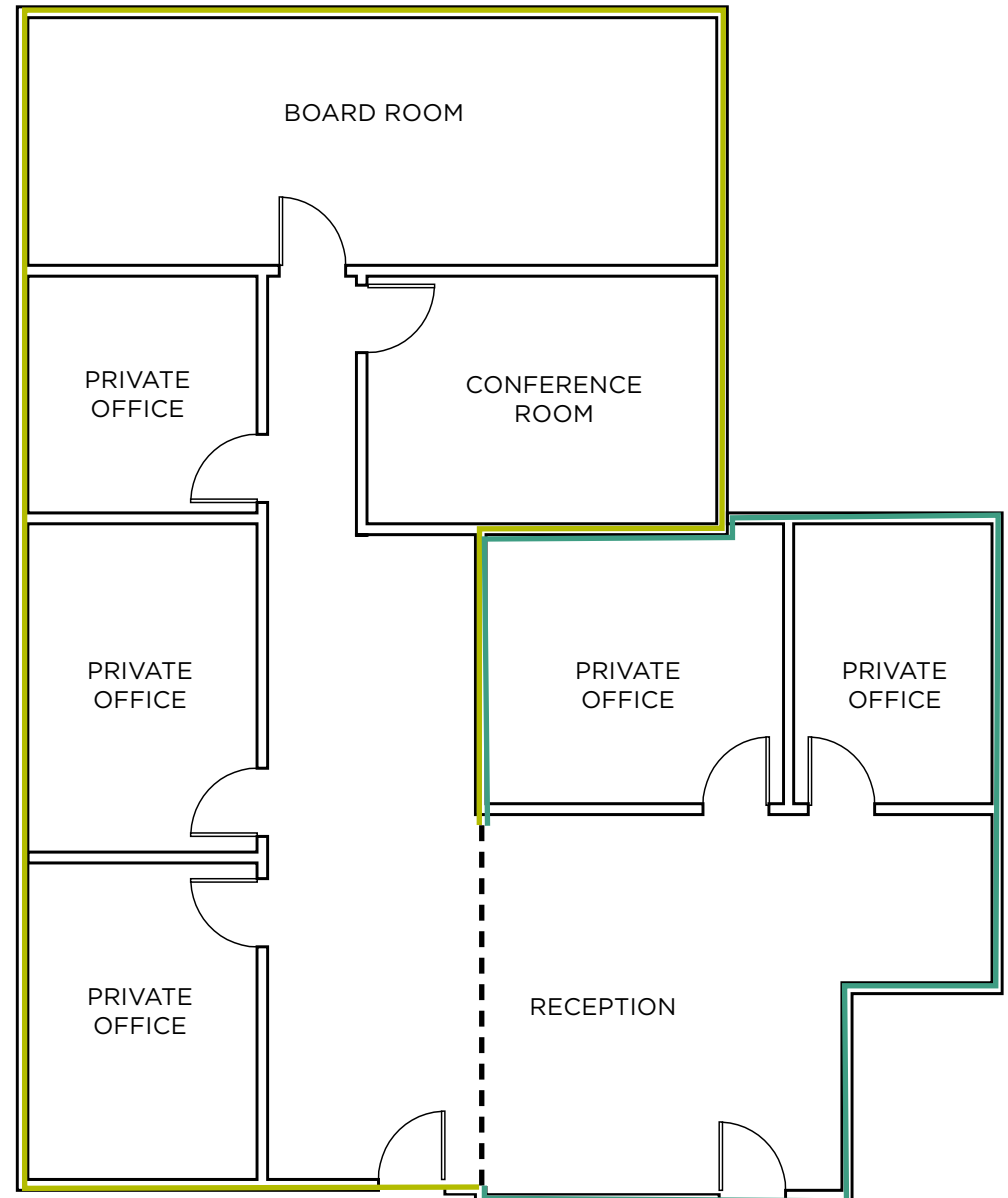
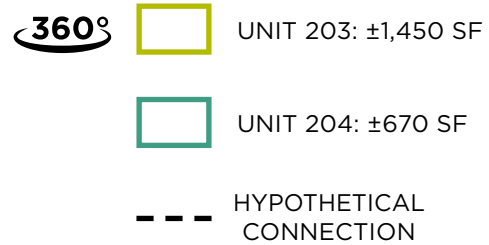

AERIAL MAP



Bank of America

MOLLIE STONE'S
MARKETS

Walgreens

PIZZERIA
DELFINA
— SAN FRANCISCO —

Spitz Coffee

lululemon



athletica

BANANA REPUBLIC

GAP

WELLS
FARGO

SAFeway

FIVE GUYS



Peets Coffee & Tea

SEPHORA

La Corneta
TAQUERIA



lemonade
SEASONAL FOOD + REFRESHMENT

345 LORTON AVE

BURLINGAME, CALIFORNIA

Il Fornaio

STACKS
COMFORTABLE FOOD



LIMON
ROTISSERIE

Caltrain



345

©2025 Cushman & Wakefield. All rights reserved. The information contained in this communication is strictly confidential. This information has been obtained from sources believed to be reliable but has not been verified. NO WARRANTY OR REPRESENTATION, EXPRESS OR IMPLIED, IS MADE AS TO THE CONDITION OF THE PROPERTY (OR PROPERTIES) REFERENCED HEREIN OR AS TO THE ACCURACY OR COMPLETENESS OF THE INFORMATION CONTAINED HEREIN, AND SAME IS SUBMITTED SUBJECT TO ERRORS, OMISSIONS, CHANGE OF PRICE, RENTAL OR OTHER CONDITIONS, WITHDRAWAL WITHOUT NOTICE, AND TO ANY SPECIAL LISTING CONDITIONS IMPOSED BY THE PROPERTY OWNER(S). ANY PROJECTIONS, OPINIONS OR ESTIMATES ARE SUBJECT TO UNCERTAINTY AND DO NOT SIGNIFY CURRENT OR FUTURE PROPERTY PERFORMANCE.

For more information,
please contact:

Marc Pope

Vice Chairman

+1 650 619 2981

marc.pope@cushwake.com

Nick Waldsmith

Director

+1 650 320 0244

nick.waldsmith@cushwake.com

1350 Bayshore Highway

Suite 900

Burlingame, CA 94010

cushmanwakefield.com

