

816 Congress Ave

Suite 1110: 7,452 RSF

LXD: 3/31/2025

816 Congress Ave
Austin, TX 78701
www.cbre.com



Property Details

- + **Rate:** Withheld
- + **2022 OPEX:** \$21.69/RSF
- + Available Immediately
- + **LXD:** 3/31/25
- + Plug & Play
- + Class A Fitness & Conference Center
- + Excellent Location along Congress Ave
- + Outdoor Amenity Terrace with Spectacular views
- + 24/7 Security

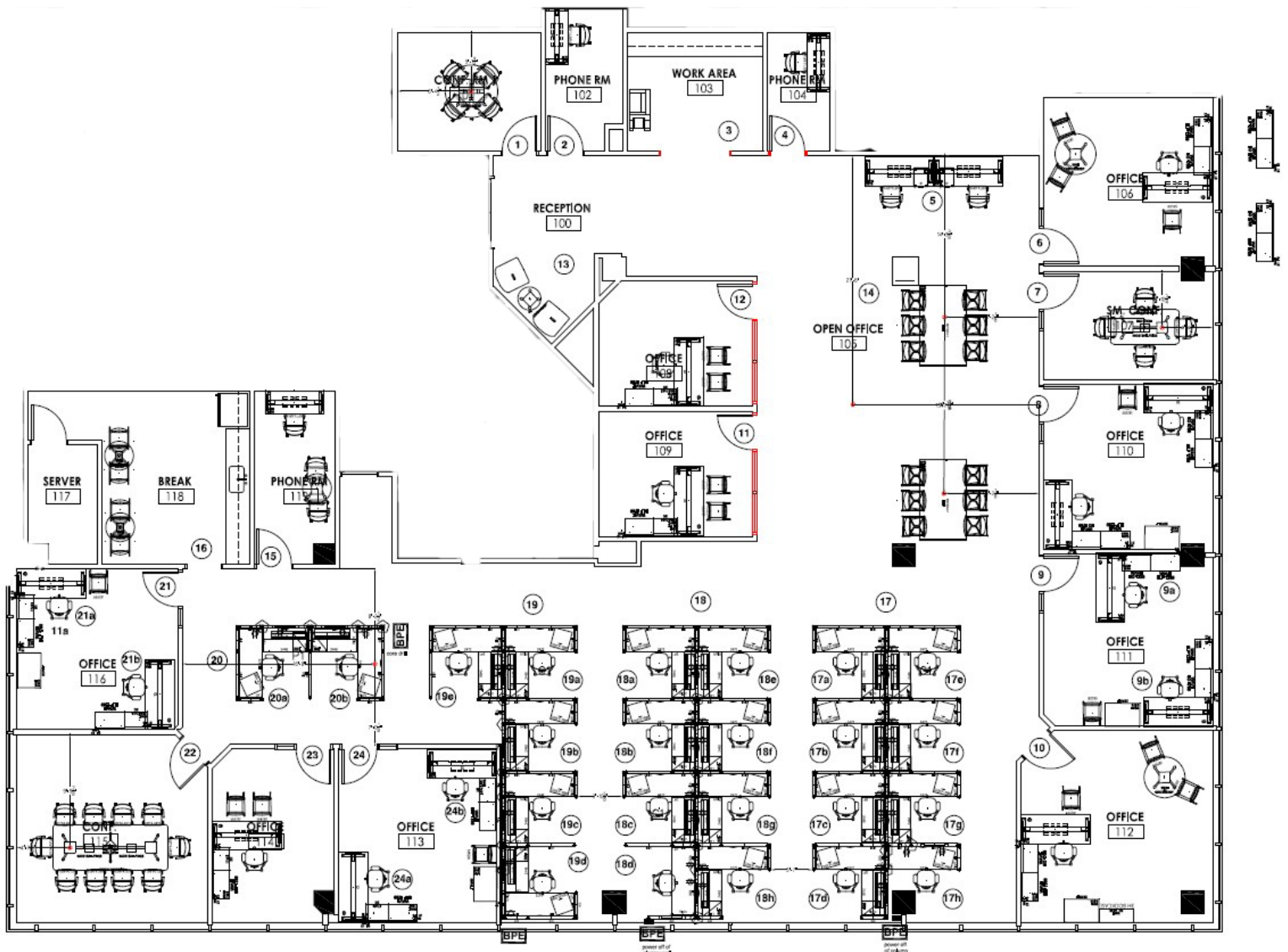

816 Congress Ave
Austin, TX 78701

For Sublease

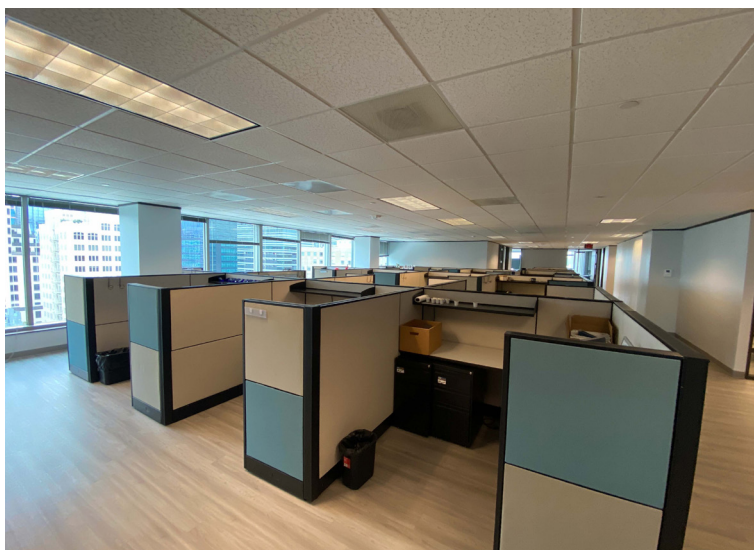

Contact Us

Caroline King

Senior Associate
+1 512 482 5563
caroline.king@cbre.com

www.cbre.com

© 2024 CBRE, Inc. All rights reserved. This information has been obtained from sources believed reliable, but has not been verified for accuracy or completeness. You should conduct a careful, independent investigation of the property and verify all information. Any reliance on this information is solely at your own risk. CBRE and the CBRE logo are service marks of CBRE, Inc. All other marks displayed on this document are the property of their respective owners, and the use of such logos does not imply any affiliation with or endorsement of CBRE. Photos herein are the property of their respective owners. Use of these images without the express written consent of the owner is prohibited.

CBRE