

FOR LEASE

CORAL CREEK SHOPS

6500 N STATE ROAD 7, COCONUT CREEK, FL 33073



PROPERTY DESCRIPTION

Grocery-anchored urban infill shopping center located at the southeast corner of State Road 7 (US-441) and Johnson Road in a desirable infill market.

PROPERTY HIGHLIGHTS

- Recently signed leases with Juici Patties and Abbott's Frozen Custard
- Publix-anchored shopping center with tenants including Wendy's, Bank of America, and more
- Second-generation restaurant spaces available for endcap and inline
- Ingress and egress from both N. State Road 7 and Johnson Road
- Close proximity to Florida's Turnpike and Sawgrass Expressway
- Daily traffic count of 66,400

OFFERING SUMMARY

Lease Rate: Negotiable

Number of Units: 31

Available SF: 1,200 - 2,000 SF

Building Size: 112,736 SF

DEMOGRAPHICS	1 MILE	3 MILES	5 MILES
Total Households	4,449	43,180	142,583
Total Population	12,612	119,783	365,474
Average HH Income	\$138,713	\$123,323	\$119,004

BRYAN COHEN

561.471.0212

info@cohencommercial.com



FOR LEASE

CORAL CREEK SHOPS

6500 N STATE ROAD 7, COCONUT CREEK, FL 33073



BRYAN COHEN

561.471.0212

info@cohencommercial.com



FOR LEASE

CORAL CREEK SHOPS

6500 N STATE ROAD 7, COCONUT CREEK, FL 33073



Map data ©2026 Imagery ©2026 Airbus, Maxar Technologies

BRYAN COHEN

561.471.0212

info@cohencommercial.com



FOR LEASE

CORAL CREEK SHOPS

6500 N STATE ROAD 7, COCONUT CREEK, FL 33073

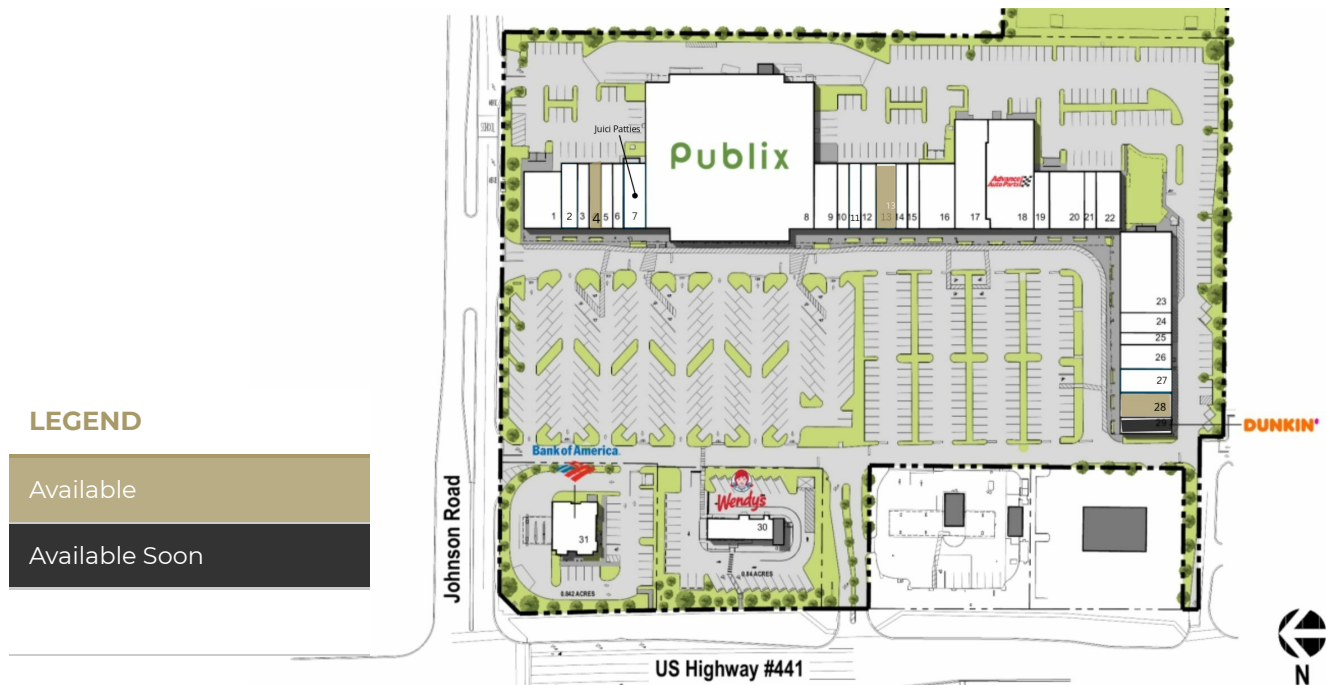

LEASE INFORMATION

Lease Type:	NNN	Lease Term:	Negotiable
Total Space:	1,200 - 2,000 SF	Lease Rate:	Negotiable

AVAILABLE SPACES

SUITE	TENANT	SIZE	RATE	DESCRIPTION
13	Available	2,000 SF	Negotiable	2nd Generation Restaurant Space
28	Available	1,950 SF	Negotiable	-
29	Available Soon	1,300 SF	Negotiable	-
4	Available	1,200 SF	Negotiable	-

BRYAN COHEN

561.471.0212

info@cohencommercial.com



FOR LEASE

CORAL CREEK SHOPS

6500 N STATE ROAD 7, COCONUT CREEK, FL 33073

SUITE	TENANT NAME	SIZE SF
1	Torero's Mexican Grill	3,850 SF
2	Florico Design	1,600 SF
3	Stretch Zone	1,200 SF
4	AVAILABLE	1,200 SF
5	Gentlemens Image Barbershop	1,200 SF
6	The UPS Store	1,200 SF
7	Juici Patties	1,600 SF
8	Publix	42,112 SF
9	Star Wine & Spirits XXI	2,400 SF
10	I & I Diamonds	1,200 SF
11	Abbott's Frozen Custard	1,200 SF
12	All Star Pizza	1,600 SF
13	AVAILABLE - 2nd Generation Restaurant Space	2,000 SF
14	Blow and Go	1,200 SF
15	Cookie Cutters Haircuts for Kids	1,197 SF
16	North Broward Chiropractic & Wellness	3,600 SF
17	Dance Theatre	5,400 SF
18	Advance Auto Parts	8,100 SF
19	Fastrak Realty	1,400 SF
20	Toi Nail Spa	3,150 SF

BRYAN COHEN

561.471.0212

info@cohencommercial.com



FOR LEASE

CORAL CREEK SHOPS

6500 N STATE ROAD 7, COCONUT CREEK, FL 33073

SUITE	TENANT NAME	SIZE SF
21	Pawfections	1,050 SF
22	Coconut Creek Winning Smiles	2,100 SF
23	Young Minds Learning Center	6,500 SF
24	Eye Was Framed	1,625 SF
25	Allstate Insurance	975 SF
26	Nana Sushi-Thai	1,950 SF
27	Palace Foot Spa	1,950 SF
28	AVAILABLE	1,950 SF
29	Coming Available	1,300 SF
30	Wendy's	3,424 SF
31	Bank of America	3,500 SF

BRYAN COHEN

561.471.0212

info@cohencommercial.com



FOR LEASE

CORAL CREEK SHOPS

6500 N STATE ROAD 7, COCONUT CREEK, FL 33073

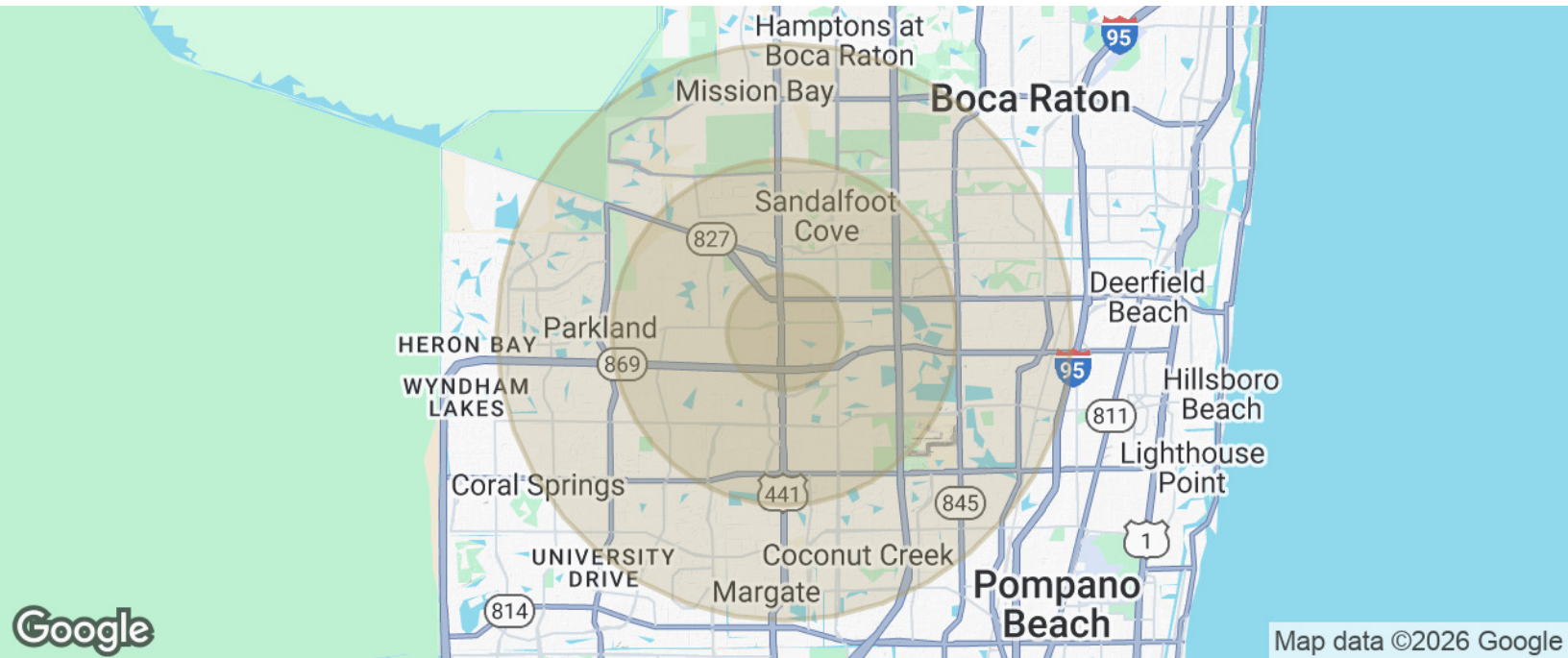

POPULATION	1 MILE	3 MILES	5 MILES
Total Population	12,612	119,783	365,474
Average Age	38	40	43
HOUSEHOLDS & INCOME	1 MILE	3 MILES	5 MILES
Total Households	4,449	43,180	142,583
# of Persons per HH	2.8	2.8	2.6
Average HH Income	\$138,713	\$123,323	\$119,004
Average House Value	\$607,971	\$484,801	\$469,839

Demographics data derived from AlphaMap

BRYAN COHEN

561.471.0212
info@cohencommercial.com

