

3,390 SQUARE FOOT WAREHOUSE
2355 NW 30 STREET, OAKLAND PARK



GREAT WAREHOUSE FOR AN OWNER USER SEEKING A CENTRAL LOCATION BETWEEN FEDERAL HIGHWAY AND STATE ROAD 7 IN THE NORTHERN QUADRANT OF THE GREATER FORT LAUDERDALE AREA.

THE PROPERTY IS IMMEDIATELY SOUTH OF OAKLAND PARK BOULEVARD AND WEST OF THE I-95 INTERCHANGE.

THE CORNER LOCATION OFFERS ACCESS ON THREE SIDES WITH 1 OVERHEAD IN THE FRONT AND 3 OVERHEADS IN THE REAR.

CURRENTLY TENANT OCCUPIED ON A MONTH TO MONTH BASIS AT \$3,600/MO.

PRICED AT \$1,100,000

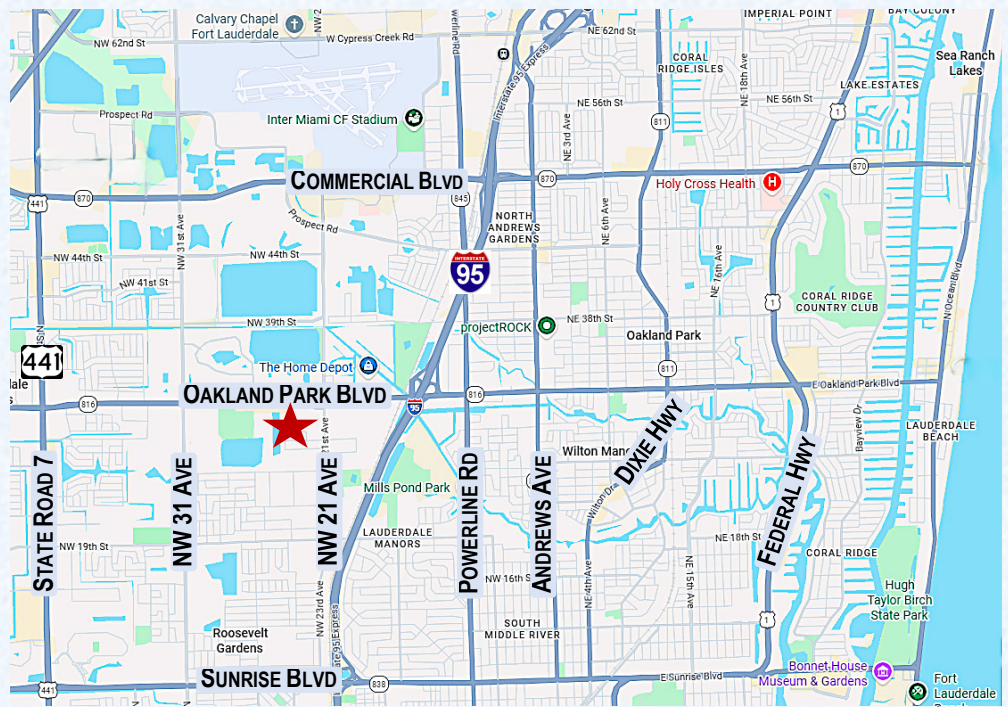

Note: All information is believed accurate however is not warranted and should be verified by all interested parties.

PROFESSIONALS WHO PRODUCE RESULTS



ROSS Z. HERMAN, P.A.
KAREN M. HERMAN, CCIM
954.563.6800

Hermans@HermanAndHerman.com

THE KEYES COMPANY, REALTORS
1520 E. Sunrise Blvd, Fort Lauderdale, FL 33304

